

NOZZLE SCHEDULE		ITEM	QTY.	NAME	DESCRIPTION
		N1	1	INLET	8" 150# RFSO FLANGE
		N2	1	OUTLET	8" STD. WGT. PIPE
		N3	1	DRAIN	2" NPT 3000# COUPLING

REV	DATE	CHANGE	ECR	BY	APP
A	6/2/05	NEW ISSUE	D193	FM	ANB
B	11/1/05	REVISED TITLE BLOCK	D507	FM	LH

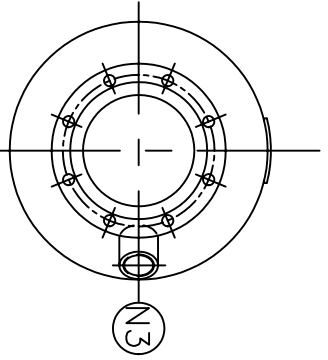
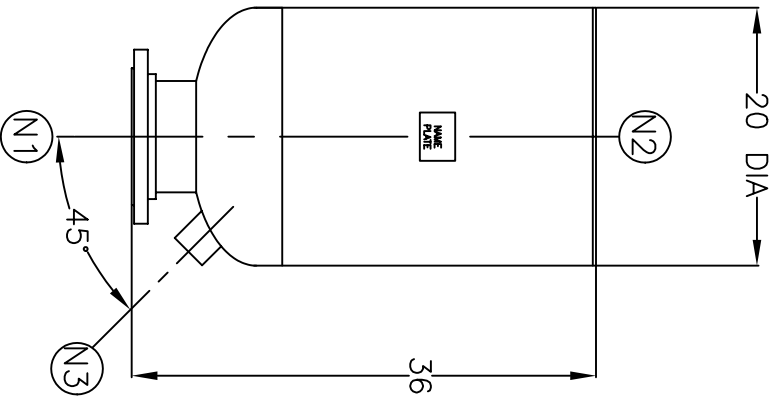

NOTES:

1. ALL DIMENSIONS ARE IN INCHES.
2. ALL BOLT HOLES ARE TO STRADDLE NATURAL CENTERLINES.
3. SHIPPING WEIGHT: 240 POUNDS.
4. DESIGN DATA:
 DESIGN PRESSURE- ATMOSPHERIC
 DESIGN TEMPERATURE- AMBIENT
 CORROSION ALLOWANCE- 0 INCHES
5. MATERIAL: 304/304L SSTL

CUSTOMER:
 REG. NO.:
 P.O. NO.:
 TAG NO.:
 PART NO.: 8EHS

ELECTRONIC FILE NAME:
 SD8EHS.DWG
 TOLERANCES UNLESS OTHERWISE SPECIFIED
 PER ENGINEERING STANDARD ES- --

UNAUTHORIZED USE, MANUFACTURE OR
 REPRODUCTION IN WHOLE OR IN PART IS
 PROHIBITED. DRAWING, DESIGN AND
 OTHER DISCLOSURES PROPERTY OF
 EATON FILTRATION, LLC



EATON FILTRATION, LLC
 900 FAIRMOUNT AVENUE, ELIZABETH, NEW JERSEY 07207
 NAME 8" TYPE "40-EHMF" EXHAUST
 HEAD 150# FLG SSTL

DRAWN	FM	DATE	6/2/05	CHECKED	LH	DATE	6/2/05	
APP	ANB	DATE	6/2/05	SCALE	NTS	ECR	D193	
SIZE	DWG	SD8EHS						REV
A	NO							B