

ITEM	QTY.	NAME	DESCRIPTION
N1	1	INLET	10" 150# RFSO ASME B16.5
N2	1	OUTLET	10" STD. WT. PIPE
N3	1	DRAIN	2" NPT 3000# COUPLING

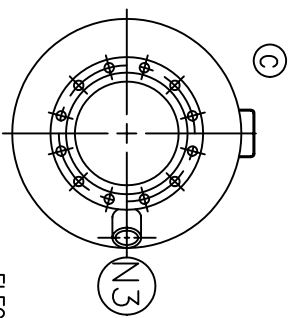
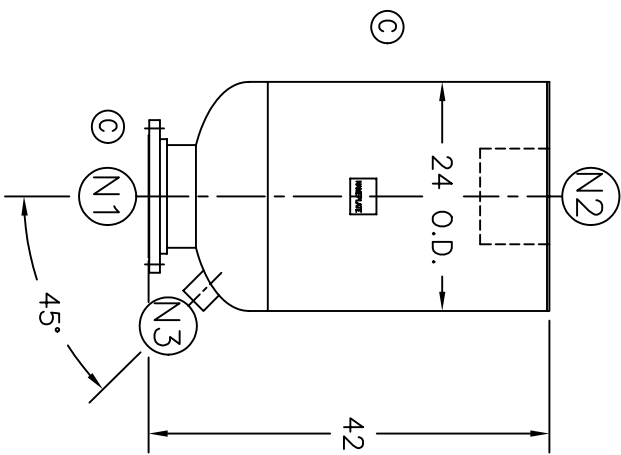

A	06/11/99	NEW ISSUE	6738	AB	DP
B	7/19/02	REVISED D. TEMPERATURE	A703	GC	VA
C	12/05/03	DELETED NAMEPL. BRACKET, NAMEPL., INLET TAG, ADDED EXHAUST HEAD NAMEPL.	B892	LH	FM
D	11/1/05	REVISED TITLE BLOCK	D507	FM	LH

NOTES:

1. ALL DIMENSIONS ARE IN INCHES.
2. ALL BOLT HOLES ARE TO STRADDLE NATURAL CENTERLINES.
3. SHIPPING WEIGHT: 400 POUNDS.
4. DESIGN DATA:
  - DESIGN PRESSURE- ATMOSPHERIC
  - DESIGN TEMPERATURE- AMBIENT (MAX. 650° F)
  - CORROSION ALLOWANCE- 0 INCHES
5. MATERIAL: CARBON STEEL.

CUSTOMER:  
 REG. NO.:  
 P.O. NO.:  
 TAG NO.:  
 PART NO.: 10EHC

**EATON**

**EATON FILTRATION, LLC**  
 900 FAIRMOUNT AVENUE, ELIZABETH, NEW JERSEY 07207

NAME: 10" TYPE "40-EHMF" EXHAUST HEAD 150# FLG (CSTL)

ELECTRONIC FILE NAME:  
 SD10EHC.DWG

TOLERANCES UNLESS OTHERWISE SPECIFIED  
 PER ENGINEERING STANDARD ES- --

UNAUTHORIZED USE, MANUFACTURE OR  
 REPRODUCTION IN WHOLE OR IN PART IS  
 PROHIBITED. DRAWING, DESIGN AND  
 OTHER DISCLOSURES PROPERTY OF  
 EATON FILTRATION, LLC

DRAWN	AB	DATE	06/11/99	CHECKED	DP	DATE	06/11/99	
APP	--	DATE	--	SCALE	NTS	ECR	7609	
SIZE	DWG	SD10EHC						REV
A	NO							D