



## *Single filter cartridge housings in "lightweight construction" for commercial applications*

The ECOCART single filter cartridge housings from Eaton are characterized by their "lightweight construction" and are suitable for commercial applications.

These single filter cartridge housings are a particularly cost-effective solution for price-sensitive applications. ECOCART filter cartridge housings are made of stainless steel and are suitable for the use of DOE filter cartridges (double open ended) with a maximum outer diameter of 71 mm. The union nut is pulled over the housing sump and screwed to the housing head. Sealing is achieved by means of a NBR O-ring between the housing sump and the head.

### Features

- Housing head for inline installation with removable housing sump and union nut
- Electropolished surfaces inside and outside
- Parts in contact with product in stainless steel 1.4408/1.4571 (316/316Ti)
- Housing connections (inlet and outlet) in G 3/4" as well as in G 1" female thread DIN ISO 228-1
- Available with drainage (female thread G 3/8" DIN ISO 228-1 with screw plug), as well as without drainage
- Filter cartridges in double open ended (DOE) design with a maximum outer diameter of 71 mm can be used in lengths of 5", 9", 10", 20", 30" or 40"
- Maximum permissible operating pressure: 17 bar
- Maximum permissible operating temperature: 121°C

### Option

- NBR O-ring as standard for cover seal, optionally available in FKM

NBR: Nitrile Butadiene Rubber  
FKM: Fluoro Rubber



*Powering Business Worldwide*

# ECOCART Single Filter Cartridge Housings

## Applications

|                            |   |
|----------------------------|---|
| Coarse filtration > 500 µm |   |
| Medium filtration > 10 µm  | ✓ |
| Fine filtration < 10 µm    | ✓ |

|                       |   |
|-----------------------|---|
| Pre-filtration        | ✓ |
| Safety filtration     |   |
| High volume           |   |
| Batch filtration      | ✓ |
| Circuit filtration    | ✓ |
| Continuous filtration |   |

|                             |   |
|-----------------------------|---|
| Solvents, paints            |   |
| Fats and oils               |   |
| Catalysts, activated carbon |   |
| Acids, bases                |   |
| Petrochemicals              |   |
| Water, waste water          | ✓ |
| Chemical industry           | ✓ |
| Pharmaceuticals             |   |
| Metal cleaning              |   |
| Automotive industry         |   |
| Electronics                 |   |
| Food and beverage           |   |
| Paint and lacquer           |   |
| Water treatment             | ✓ |
| Galvanic industry           | ✓ |

## Types

EKF-1(...)-E-¾

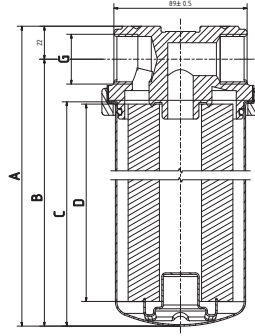

EKF-1(...)-E-¾-A

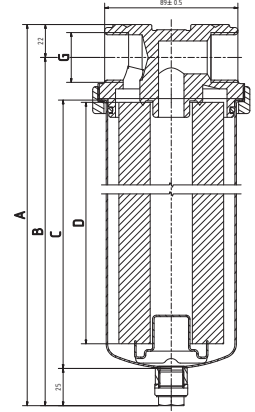

## Dimensions (mm)

| Types | EKF-109-E-¾<br>EKF-109-E-1     | EKF-110-E-¾<br>EKF-110-E-1     | EKF-120-E-¾<br>EKF-120-E-1     | EKF-130-E-¾<br>EKF-130-E-1     | EKF-140-E-¾<br>EKF-140-E-1     |
|-------|--------------------------------|--------------------------------|--------------------------------|--------------------------------|--------------------------------|
| A     | 314                            | 320                            | 574                            | 828                            | 1,082                          |
| B     | 292                            | 298                            | 552                            | 806                            | 1,060                          |
| C     | 266                            | 272                            | 526                            | 780                            | 1,034                          |
| D     | 248                            | 254                            | 508                            | 762                            | 1,016                          |
| Types | EKF-109-E-¾-A<br>EKF-109-E-1-A | EKF-110-E-¾-A<br>EKF-110-E-1-A | EKF-120-E-¾-A<br>EKF-120-E-1-A | EKF-130-E-¾-A<br>EKF-130-E-1-A | EKF-140-E-¾-A<br>EKF-140-E-1-A |
| A     | 338                            | 344                            | 598                            | 852                            | 1,106                          |
| B     | 316                            | 322                            | 576                            | 830                            | 1,084                          |
| C     | 266                            | 272                            | 526                            | 780                            | 1,034                          |
| D     | 248                            | 254                            | 508                            | 762                            | 1,016                          |

The dimensions are for reference only and are approximate. Exact dimensions for installation purposes are available on request.

## Technical Data

| Types                          | Max. pressure (bar) | Max. temperature (°C) | Housing volume (l) | Housing weight (kg) | Length of filter cartridges in (mm) | Adapter filter cartridges | I/O connections                          |
|--------------------------------|---------------------|-----------------------|--------------------|---------------------|-------------------------------------|---------------------------|--|
| EKF-109-E-¾<br>EKF-109-E-1     | 17                  | 121                   | 1.51               | 3.30<br>3.21        | 9¾ (248)                            | DOE                       | G ¾" DIN ISO 228-1<br>G 1" DIN ISO 228-1 |
| EKF-110-E-¾<br>EKF-110-E-1     | 17                  | 121                   | 1.54               | 3.31<br>3.22        | 10 (254)                            | DOE                       | G ¾" DIN ISO 228-1<br>G 1" DIN ISO 228-1 |
| EKF-120-E-¾<br>EKF-120-E-1     | 17                  | 121                   | 2.98               | 3.84<br>3.75        | 20 (508)                            | DOE                       | G ¾" DIN ISO 228-1<br>G 1" DIN ISO 228-1 |
| EKF-130-E-¾<br>EKF-130-E-1     | 17                  | 121                   | 4.42               | 4.36<br>4.27        | 30 (762)                            | DOE                       | G ¾" DIN ISO 228-1<br>G 1" DIN ISO 228-1 |
| EKF-140-E-¾<br>EKF-140-E-1     | 17                  | 121                   | 5.87               | 4.89<br>4.80        | 40 (1,016)                          | DOE                       | G ¾" DIN ISO 228-1<br>G 1" DIN ISO 228-1 |
| EKF-109-E-¾-A<br>EKF-109-E-1-A | 17                  | 121                   | 1.51               | 3.37<br>3.28        | 9¾ (248)                            | DOE                       | G ¾" DIN ISO 228-1<br>G 1" DIN ISO 228-1 |
| EKF-110-E-¾-A<br>EKF-110-E-1-A | 17                  | 121                   | 1.54               | 3.29<br>3.29        | 10 (254)                            | DOE                       | G ¾" DIN ISO 228-1<br>G 1" DIN ISO 228-1 |
| EKF-120-E-¾-A<br>EKF-120-E-1-A | 17                  | 121                   | 2.98               | 3.90<br>3.82        | 20 (508)                            | DOE                       | G ¾" DIN ISO 228-1<br>G 1" DIN ISO 228-1 |
| EKF-130-E-¾-A<br>EKF-130-E-1-A | 17                  | 121                   | 4.42               | 4.43<br>4.34        | 30 (762)                            | DOE                       | G ¾" DIN ISO 228-1<br>G 1" DIN ISO 228-1 |
| EKF-140-E-¾-A<br>EKF-140-E-1-A | 17                  | 121                   | 5.87               | 4.96<br>4.87        | 40 (1,016)                          | DOE                       | G ¾" DIN ISO 228-1<br>G 1" DIN ISO 228-1 |

**North America**  
44 Apple Street  
Tinton Falls, NJ 07724  
Toll Free: 800 656-3344  
(North America only)  
Tel: +1 732 212-4700

**Greater China**  
No. 7, Lane 280,  
Linhong Road  
Changning District, 200335  
Shanghai, P.R. China  
Tel: +86 21 2899-3687

**Europe/Africa/Middle East**  
Auf der Heide 2  
53947 Nettersheim, Germany  
Tel: +49 2486 809-0  
  
Friedensstraße 41  
68804 Altlußheim, Germany  
Tel: +49 6205 2094-0

**Asia-Pacific**  
100G Pasir Panjang Road  
#07-08 Interlocal Centre  
Singapore 118523  
Tel: +65 6825-1620

An den Nahewiesen 24  
55450 Langenlonsheim, Germany  
Tel: +49 6704 204-0

For more information, please  
email us at [filtration@eaton.com](mailto:filtration@eaton.com)  
or visit [www.eaton.com/filtration](http://www.eaton.com/filtration)

© 2023 Eaton. All rights reserved. All trademarks and registered trademarks are the property of their respective owners. All information and recommendations appearing in this brochure concerning the use of products described herein are based on tests believed to be reliable. However, it is the user's responsibility to determine the suitability for his own use of such products. Since the actual use by others is beyond our control, no guarantee, expressed or implied, is made by Eaton as to the effects of such use or the results to be obtained. Eaton assumes no liability arising out of the use by others of such products. Nor is the information herein to be construed as absolutely complete, since additional information may be necessary or desirable when particular or exceptional conditions or circumstances exist or because of applicable laws or government regulations.

EN  
EF-FCH-01  
09-2023