

(4) 3/4" DIA BOLT HOLES  
LOCATED AS SHOWN  
ON 14.12 B.C.D.

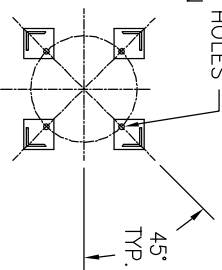

SECTION B-B

| ITEM | PART NAME           | MATERIAL         |
|------|---------------------|------------------|
| 1    | BODY                | SA240 316/316L   |
| 2    | COVER               | SA240 316/316L   |
| 3    | O-RING              | BUNA-N           |
| 4    | PIN                 | SA193 B7 ZINC PL |
| 5    | SNAP RING           | STEEL ZINC PL    |
| 6    | BASKET RESTRAINER   | 316 SS           |
| 7    | FILTER BAG RETAINER | 316 SS           |
| 8    | EYE BOLT            | SA193 B7 ZINC PL |
| 9    | HEX NUT             | SA194 2H ZINC PL |
| 10   | WASHER              | STEEL ZINC PL    |
| 11   | DAVT ASSEMBLY       | CARBON STEEL     |

**NOTES:**

1. UNITS ARE TO BE DESIGNED, FABRICATED & "U" STAMPED IN ACCORDANCE WITH ASME SECT. VIII DIV. 1 BOILER & PRESSURE VESSEL CODE, IN COMPLIANCE TO LATEST ADDENDA.
2. INLET / OUTLET FLANGE CONNECTIONS PER ANSI B 16.5.
3. DESIGN PRESSURE: 150 PSI (MAWP)  
DESIGN TEMPERATURE 250° F.  
MDMT - -20° F @ 150 PSI.
4. ALL DIMENSIONS ARE IN INCHES / (MM).
5. ALL BOLT HOLES ARE TO STRADDLE NATURAL CENTERLINES.
6. APPROX. WEIGHT (DRY) 574 LB. (260 KG.)

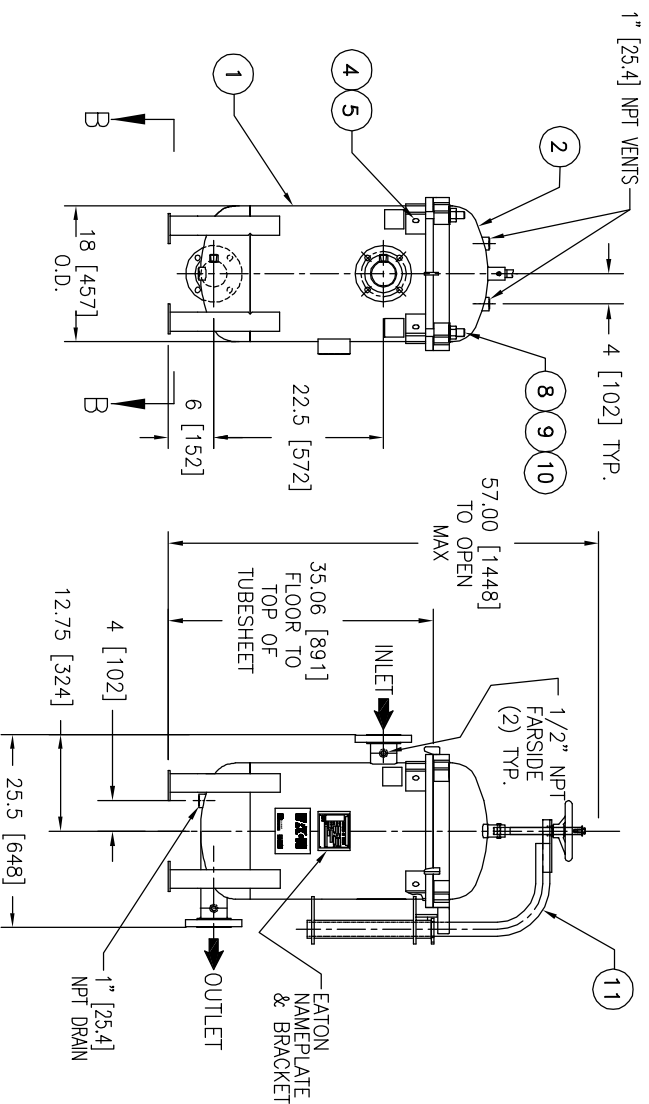

CERTIFIED FOR:  
P.O. NO.:  
SALES ORDER NO.:  
QUOTE NO.:  
TAG NO.:  
VESSEL CODE: MBF-0302-AB110-030A-UT-11HD  
PART NUMBER: F3AV03000003

**EATON FILTRATION, LLC**  
70 WOOD AVENUE SOUTH, ISELIN, NEW JERSEY 08830

NAME: MAXILINE MBF0302HD FILTER VESSEL  
3" 150# RT INLET/TANGENTIAL OUTLET  
STAINLESS STEEL

| DRAWN | SD/ID | DATE     | CERT. | LF | DATE     | REV |
|-------|-------|----------|-------|----|----------|-----|
| A     |       | 11/20/00 |       |    | 11/29/00 | E   |

UNAUTHORIZED USE, MANUFACTURE OR REPRODUCTION IN WHOLE OR IN PART IS PROHIBITED. DRAWING, DESIGN AND OTHER DISCLOSURES PROPERTY OF EATON FILTRATION, LLC

ELECTRONIC FILE NAME: HD0303TS.DWG  
REF. EGR F071 DATE 02/11/08