

# Type 4 Panel Enclosures

## Ground-Mount Enclosures Type 4 Double-Door Floor-Standing Data Sheet and Catalog Number



Type 4 Panel Enclosures

### Application

- Houses electrical controls and instruments
- Intended for indoor or outdoor use
- Protects against windblown dust and rain, splashing water and hose directed water

### Standards

- UL 508 Listed, Type 4 and Type 12
- CSA C22.2 No. 94 Certified, Type 4 and Type 12
- Conforms to NEMA Standard for Type 4 and Type 12

### Finish

- Wash and phosphate undercoat
- ANSI 61 gray polyester powder finish

### Accessories

- Panels
- Leg stabilizer kit
- Touch-up paint
- See Accessories section

### Construction

- Enclosure and door are fabricated from (10) gauge steel
- All continuous welded seams are finished smooth
- Each door is secured to the body with a heavy duty continuous hinge on one side and easy-to-release stainless steel door clamps mounted to the other three sides
- Print pocket provided
- Each door has a padlock hasp with sealing hole provision
- Doors have a seamless poured in place gasket
- Ground stud provided on doors
- Removable center post for complete front access
- Heavy gauge angle supports and .375-16 collar studs are provided for mounting optional panel
- Large lifting eyebolts are supplied
- Mounting legs are provided for floor mounting

Enclosure  Catalog #	Enclosure Size Height x Width x Depth AxBxC		Panel  Catalog #	Panel Size Height x Width	
	in.	mm.		in.	mm.
CH624810-4FD	62.00 x 48.00 x 10.00	1575 x 1219 x 254	CHAW6048P	55.87 x 43.87	1419 x 1114
CH626012-4FD	62.00 x 60.00 x 12.00	1575 x 1524 x 305	CHAW6060P	55.87 x 55.87	1419 x 1419
CH746012-4FD	74.00 x 60.00 x 12.00	1880 x 1524 x 305	CHAW7260P	67.87 x 55.87	1724 x 1419
CH747212-4FD	74.00 x 72.00 x 12.00	1880 x 1829 x 305	CHAW7272P	67.87 x 67.87	1724 x 1724
CH747224-4FD	74.00 x 72.00 x 24.00	1880 x 1829 x 610	CHAW7272P	67.87 x 67.87	1724 x 1724

# Type 4 Panel Enclosures

## Ground-Mount Enclosures Type 4 Double-Door Floor-Standing Illustration Sheet

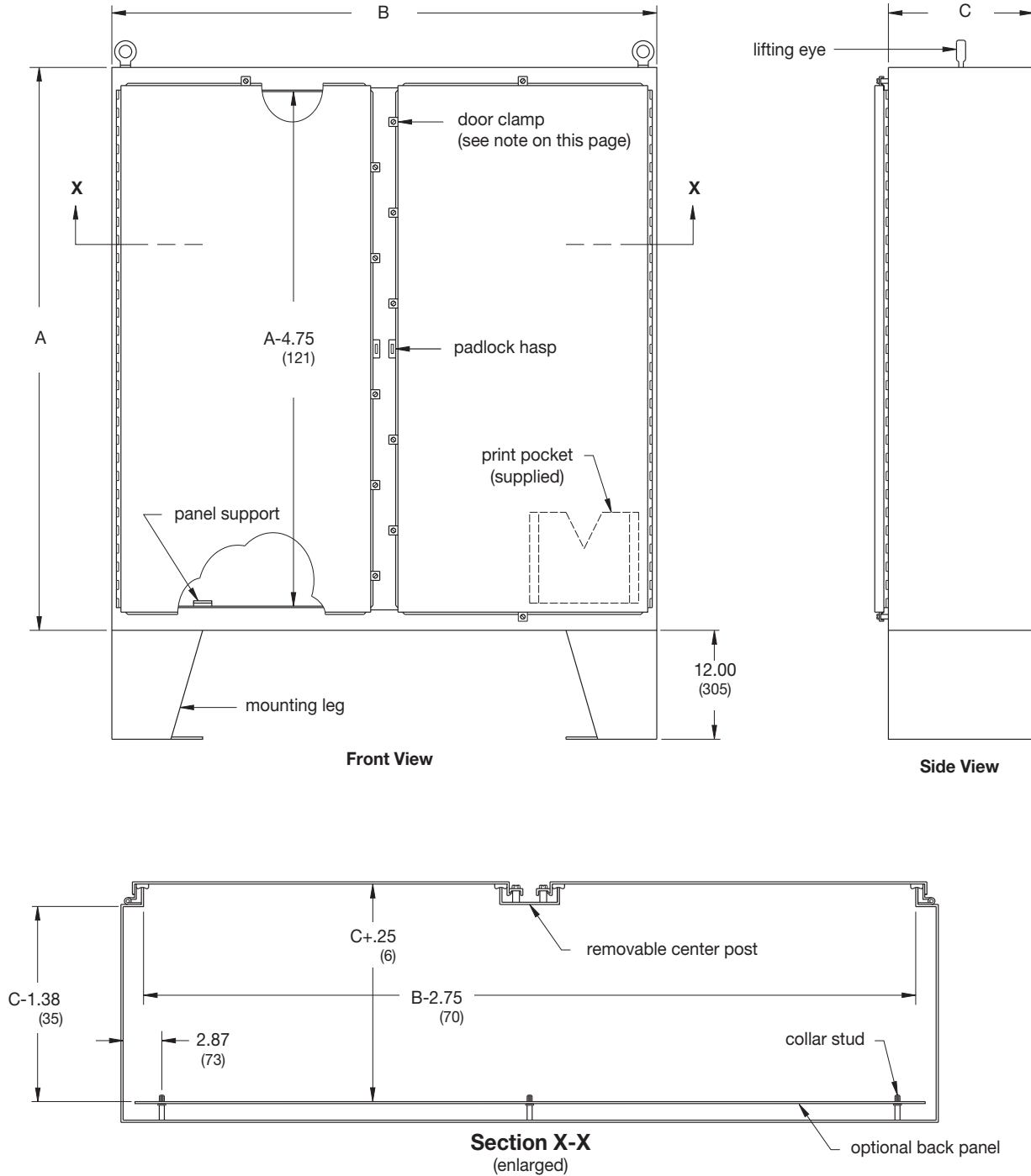

**Notes:** Clamps are mounted along three sides of the enclosure door. Spacing between clamps along side opposite the hinge does not exceed 15 inches. Four lifting eyes are furnished when  $C$  dimension is 24" (610 mm). Dimensions are in inches. Millimeters shown are for reference only. Data subject to change without notice.

# Type 4 Panel Enclosures

## Ground-Mount Enclosures

### Type 4 Double-Door Floor-Standing with Quarter-Turn Latches

Data Sheet and Catalog Number



Type 4 Panel Enclosures

#### Application

- Houses electrical controls and instruments
- Intended for indoor or outdoor use
- Protects against windblown dust and rain, splashing water and hose directed water

#### Standards

- UL 508 Listed, Type 4 and Type 12
- CSA C22.2 No. 94 Certified, Type 4 and Type 12
- Conforms to NEMA Standard for Type 3, Type 4, Type 12

#### Finish

- Wash and phosphate undercoat
- ANSI 61 gray polyester powder finish

#### Accessories

- Panels
- Panel support kit
- Panel lifting kit
- Leg stabilizer kit
- Lights
- Window kits

#### Construction

- Enclosure and doors are fabricated from (12) gauge steel
- All continuous welded seams are finished smooth
- Continuous hinge with stainless steel hinge pin
- Slotted quarter-turn flush latch(es)
- Doors have a seamless poured in place gasket
- Removable center post for easy panel installation
- Formed lip around enclosure opening diverts liquids and contaminants
- Ground stud provided on door
- Print pocket provided
- Heavy gauge angle supports and .375-16 collar studs are provided for mounting optional panel
- Large lifting eyebolts
- Mounting legs

Enclosure Catalog #	Enclosure Size Height x Width x Depth AxBxC		Panel Catalog #	Panel Size Height x Width	
	in.	mm.		in.	mm.
CH604812-4FDQT	60.00 x 48.00 x 12.00	1524 x 1219 x 305	CHAW6048P	55.87 x 43.87	1419 x 1114
CH606012-4FDQT	60.00 x 60.00 x 12.00	1524 x 1524 x 305	CHAW6060P	55.87 x 55.87	1419 x 1419
CH726012-4FDQT	72.00 x 60.00 x 12.00	1829 x 1524 x 305	CHAW7260P	67.87 x 55.87	1724 x 1419
CH727212-4FDQT	72.00 x 72.00 x 12.00	1829 x 1829 x 305	CHAW7272P	67.87 x 67.87	1724 x 1724
CH727224-4FDQT	72.00 x 72.00 x 24.00	1829 x 1829 x 609	CHAW7272P	67.87 x 67.87	1724 x 1724

# Type 4 Panel Enclosures

## Ground-Mount Enclosures Type 4 Double-Door Floor-Standing with Quarter-Turn Latches

### Illustration Sheet

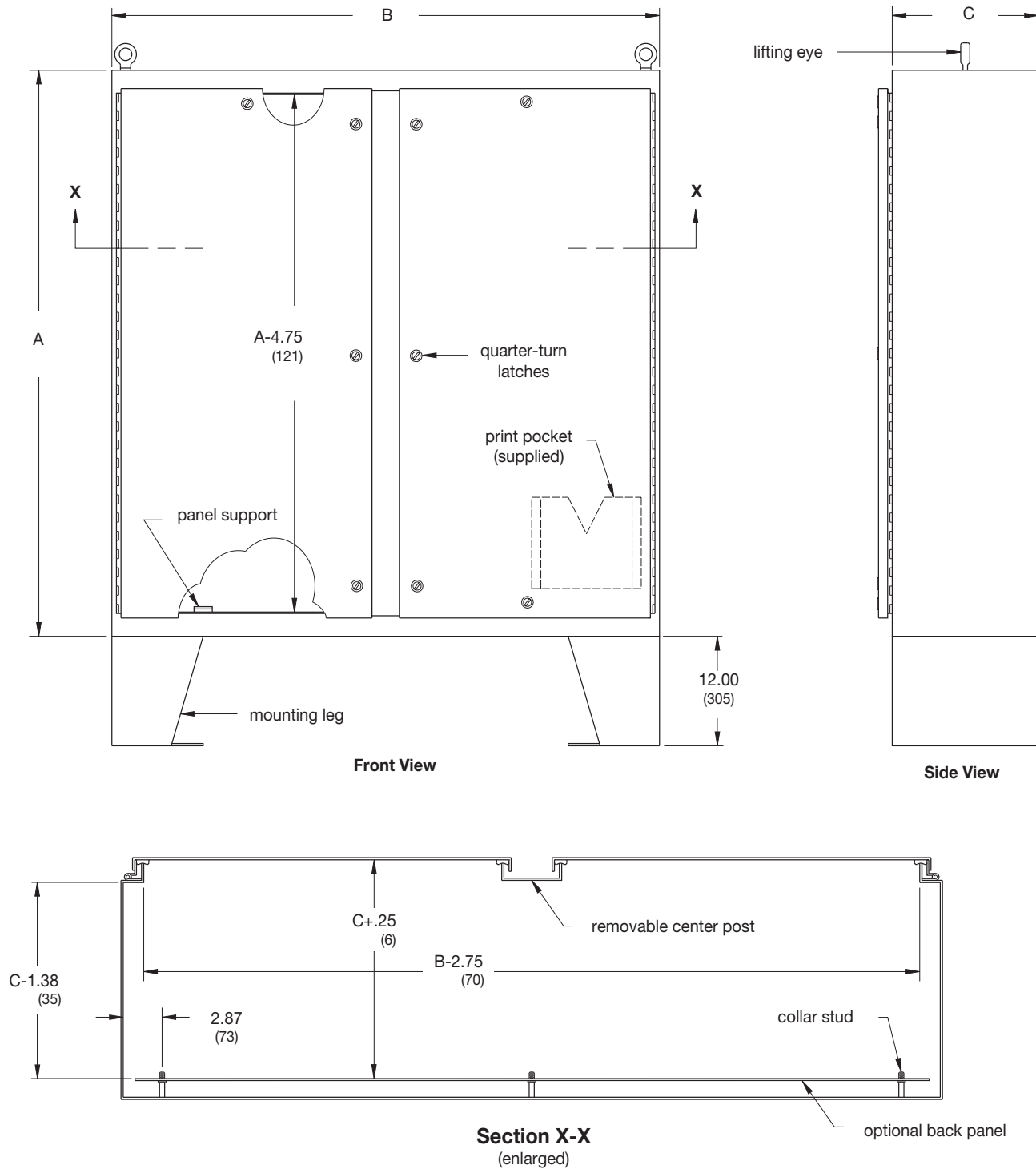

**Notes:** Four lifting eyes are furnished when C dimension is 24" (610 mm).  
Dimensions are in inches. Millimeters shown are for reference only. Data subject to change without notice.

Type 4 Panel Enclosures

# Type 4 Panel Enclosures

## Ground-Mount Enclosures

### Type 4 Double-Door Floor-Standing with 3-Point Locking

#### Data Sheet and Catalog Number



Type 4 Panel Enclosures

#### Application

- Houses electrical controls and instruments
- Intended for indoor or outdoor use
- Protects against windblown dust and rain, splashing water and hose directed water

#### Standards

- UL 508 Listed, Type 4 and Type 12
- CSA C22.2 No. 94 Certified, Type 4 and Type 12
- Conforms to NEMA Standard for Type 3, Type 4, Type 12

#### Finish

- Wash and phosphate undercoat
- ANSI 61 gray polyester powder finish

#### Accessories

- Panels
- Panel support kit
- Panel lifting kit
- Leg stabilizer kit
- Lights
- Window kits
- Replacement handle

#### Construction

- Enclosure and doors are fabricated from (12) gauge steel
- All continuous welded seams are finished smooth
- Continuous hinge with stainless steel hinge pin
- Internal 3-point latching with key locking and padlock handles
- Doors have a seamless poured in place gasket
- Removable center post for easy panel installation
- Formed lip around enclosure opening diverts liquids and contaminants
- Ground stud provided on door
- Print pocket provided
- Heavy gauge angle supports and .375-16 collar studs are provided for mounting optional panel
- Large lifting eyebolts
- Mounting legs

Enclosure Catalog #	Enclosure Size Height x Width x Depth AxBxC		Panel Catalog #	Panel Size Height x Width	
	in.	mm.		in.	mm.
CH624810-4FD3PT	62.00 x 48.00 x 10.00	1575 x 1219 x 254	CHAW6048P	55.87 x 43.87	1419 x 1114
CH626012-4FD3PT	62.00 x 60.00 x 12.00	1575 x 1524 x 305	CHAW6060P	55.87 x 55.87	1419 x 1419
CH746012-4FD3PT	74.00 x 60.00 x 12.00	1879 x 1524 x 305	CHAW7260P	67.87 x 55.87	1724 x 1419
CH747212-4FD3PT	74.00 x 72.00 x 12.00	1879 x 1829 x 305	CHAW7272P	67.87 x 67.87	1724 x 1724
CH747224-4FD3PT	74.00 x 72.00 x 24.00	1879 x 1829 x 609	CHAW7272P	67.87 x 67.87	1724 x 1724

# Type 4 Panel Enclosures

## Ground-Mount Enclosures

### Type 4 Double-Door Floor-Standing with 3-Point Locking

#### Illustration Sheet

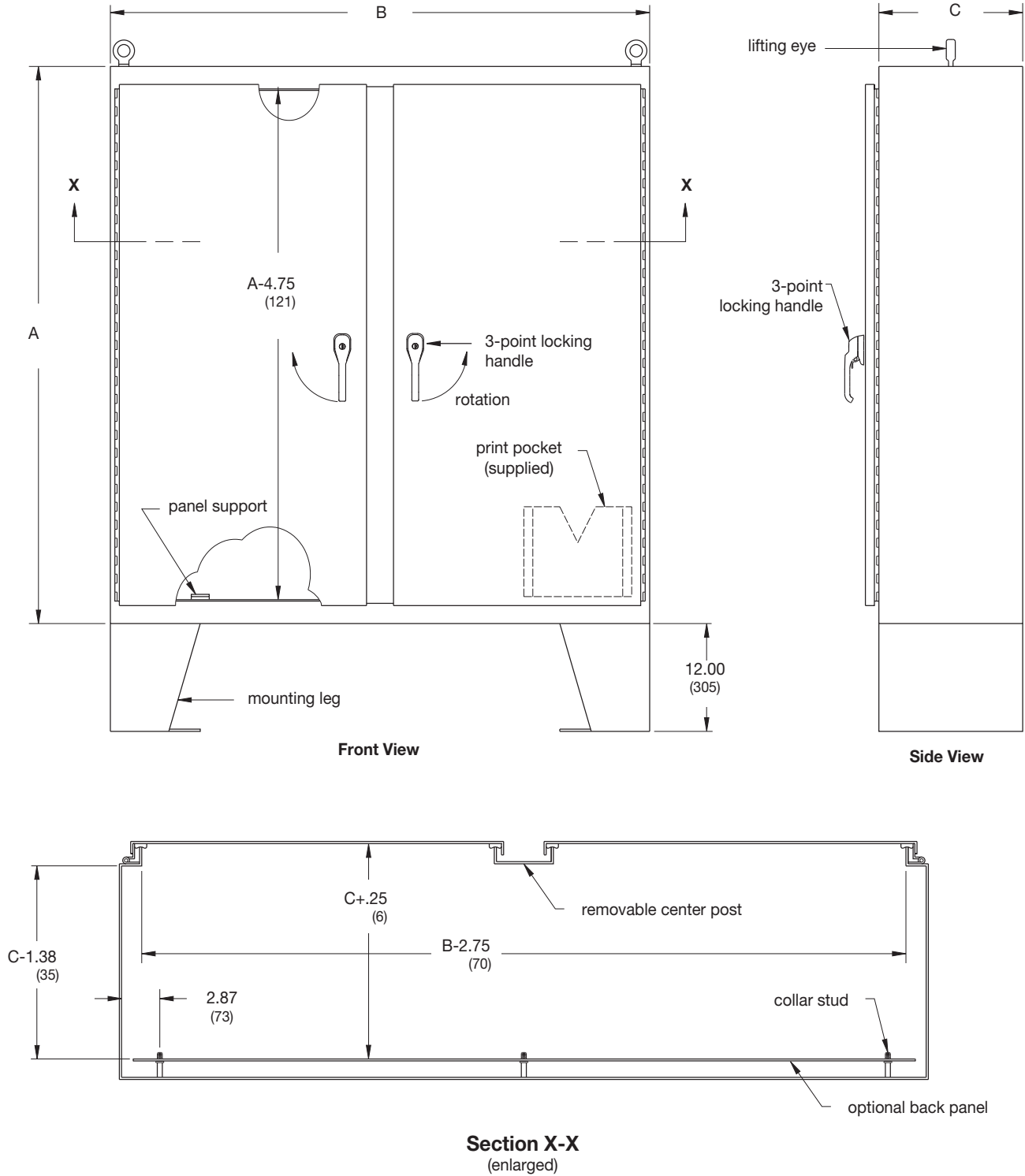

Type 4 Panel Enclosures

**Notes:** Four lifting eyes are furnished when C dimension is 24" (610 mm).  
Dimensions are in inches. Millimeters shown are for reference only. Data subject to change without notice.