

Montageanweisung  
Installation Instructions  
Notice d'installation  
Istruzioni per il montaggio

Instrucciones de montaje  
Инструкция по монтажу  
安裝說明

## AF 3-NZM 14-1600 AF 4-NZM 144-1600

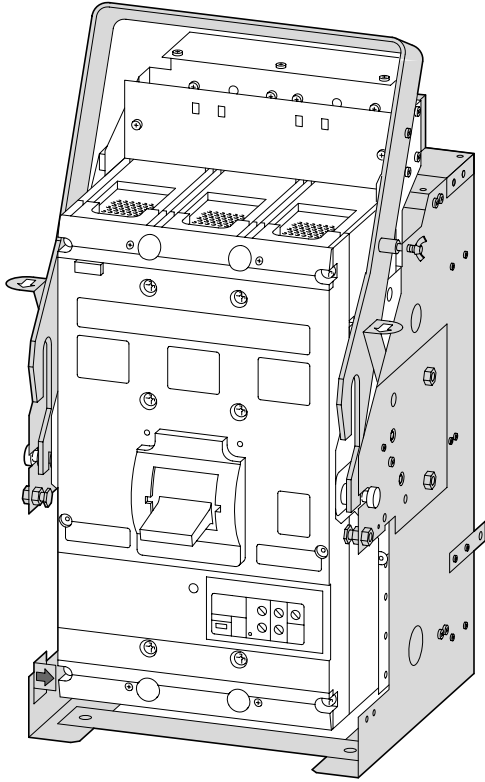

**Lebensgefahr durch elektrischen Strom!**  
Nur Elektrofachkräfte und elektrotechnisch unterwiesene Personen dürfen die im folgenden beschriebenen Arbeiten ausführen.

**Electric current! Danger to life!**

Only skilled or instructed persons may carry out the following operations.

**Tension électrique dangereuse !**

Seuls les personnes qualifiées et averties doivent exécuter les travaux ci-après.

**Pericolo di morte causa corrente elettrica!**

Solo persone istruite e avvertite possono eseguire le operazioni di seguito riportate.

**¡Corriente eléctrica! ¡Peligro de muerte!**

El trabajo a continuación descrito debe ser realizado por personas cualificadas y advertidas.

**Электрический ток! Опасно для жизни!**

Только специалисты или проинструктированные лица могут выполнять следующие операции.

触电危险!  
只允许专业人员 and 受过专业训练的人员进行下列工作。



H 1



8 – 10 mm

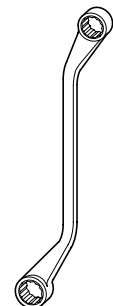

SW 17

Montage des Sockels  
Fitting the socket base  
Montage du socle  
Montaggio dello zoccolo  
Montaje de zócalo  
Монтаж цоколя  
底座安裝

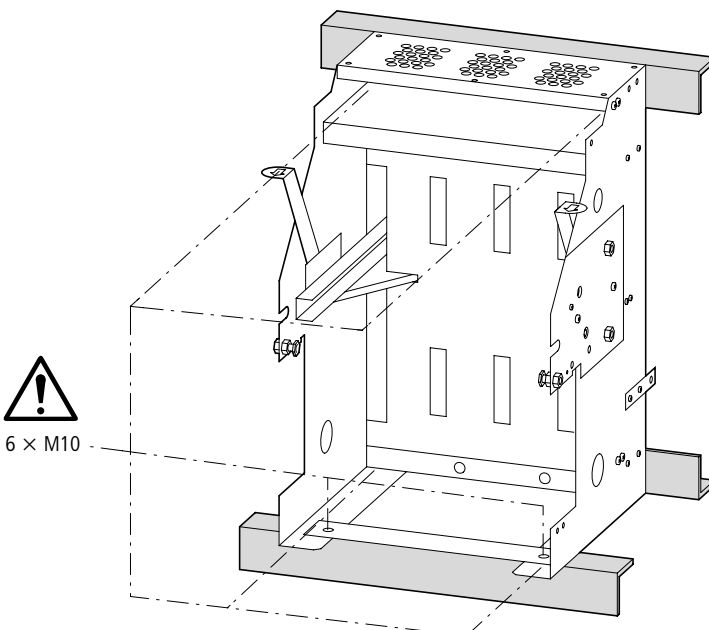

6 x M10

Verdrahten der Hilfskontakte  
 Wiring the auxiliary contacts  
 Câblage des contacts auxiliaires  
 Cablaggio dei contatti ausiliari  
 Cableado de los contactos auxiliares  
 Соединение проводами вспомогательных контактов  
 辅助开关接线

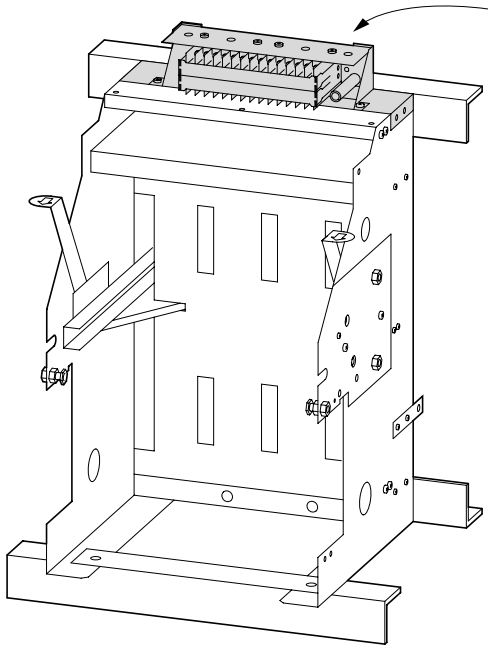

⊕	⊕	⊕	⊕	⊕	⊕	⊕	⊕	⊕	⊕	⊕	⊕	⊕	⊕
71	70	72	74	PE			4.11	4.12	4.14	k	l	LU 1	
							1.31	1.32	1.34				
⊕	⊕	⊕	⊕	⊕	⊕	⊕	⊕	⊕	⊕	⊕	⊕	⊕	⊕
C1	C2	F1	F2	D1	D2		1.11	1.12	1.14	1.21	1.22	1.24	

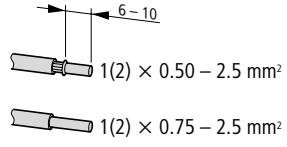

Abschließen der Isolierklappen  
 Locking the shutter  
 Cadenassage des volets de protection  
 Chiusura dello sportello isolante  
 Enclavamiento de pantalla  
 Запирание изоляционных клапанов  
 母线接线螺丝

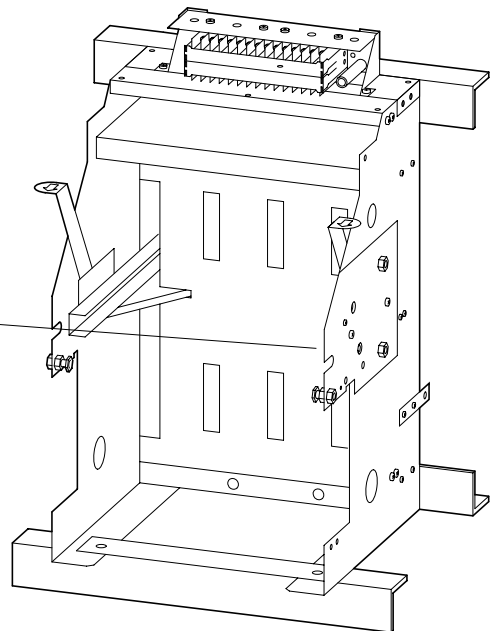
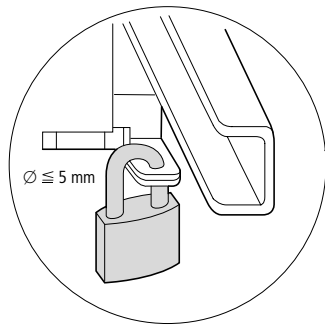

**1**

Einsetzen/Einfahren  
 Connecting the breaker  
 Mise en place/embrochage  
 Inserzione  
 Conexión/colocación  
 Сосадка/вкатывание  
 对好/推进

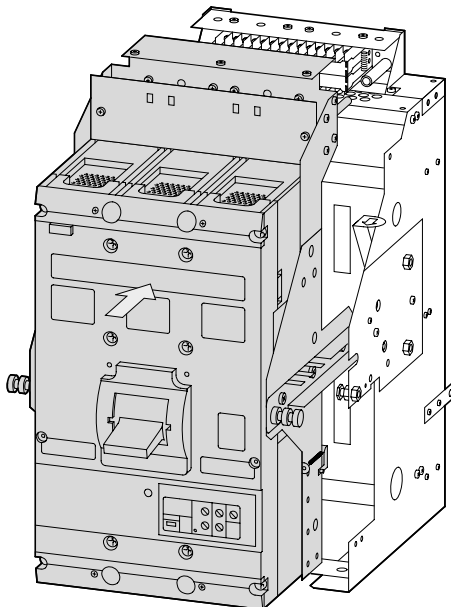

**2**

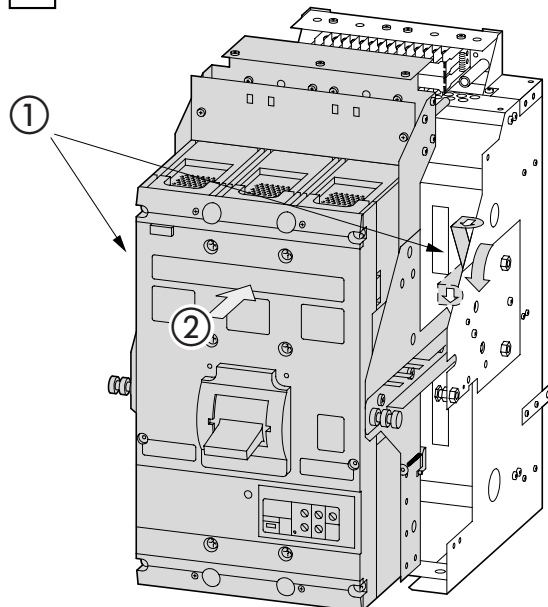

3

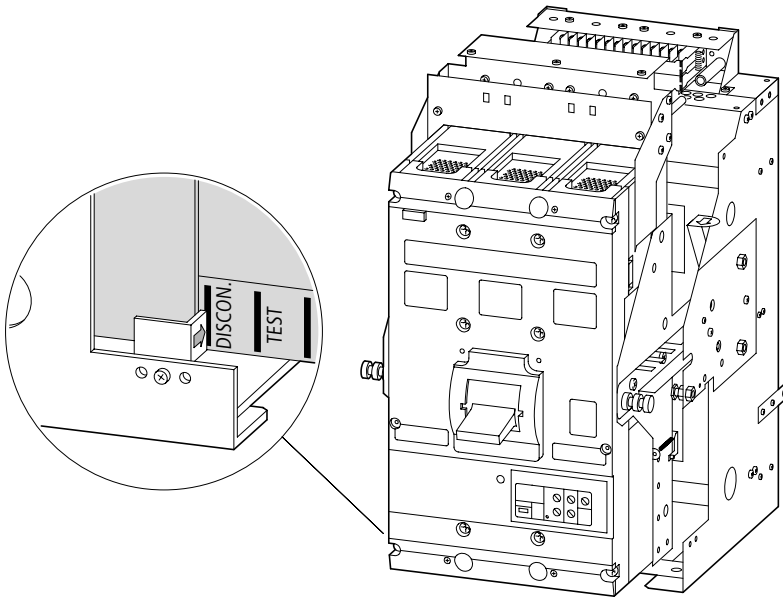

4

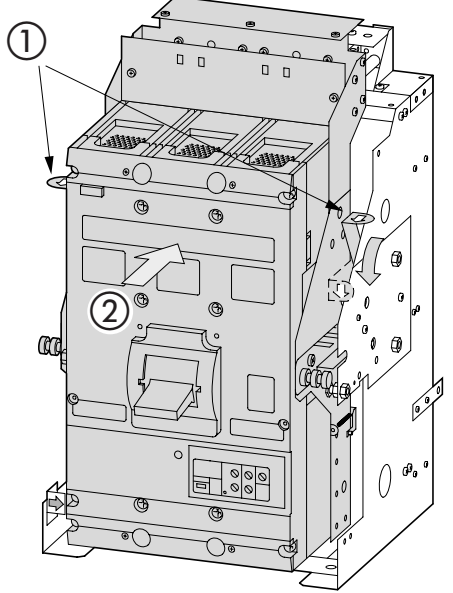

5

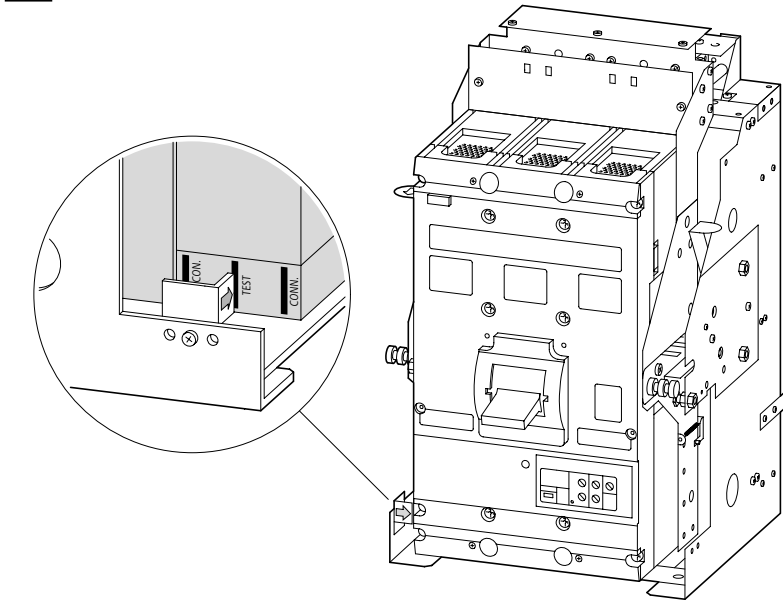

6

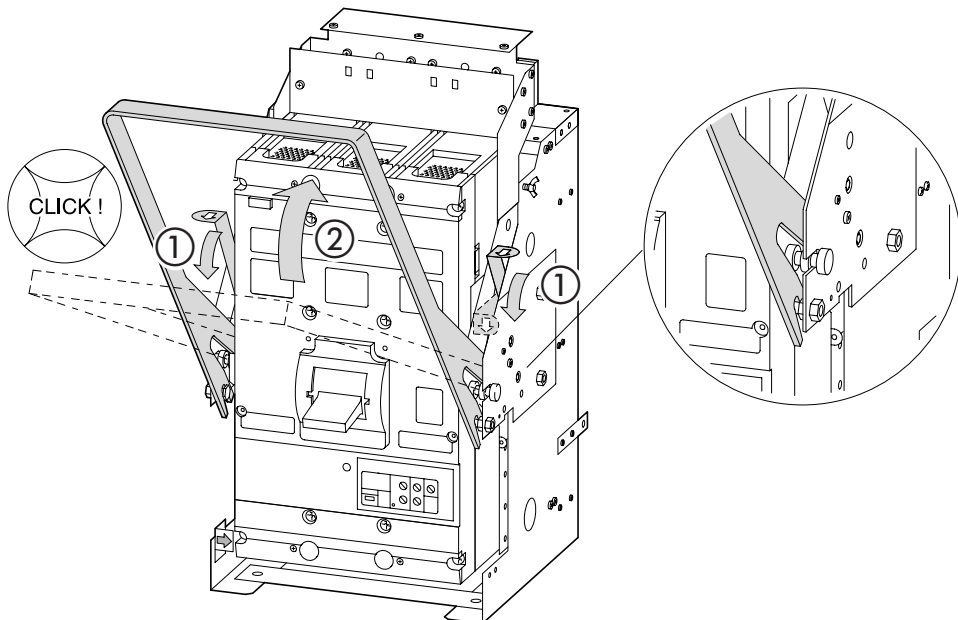

**7**

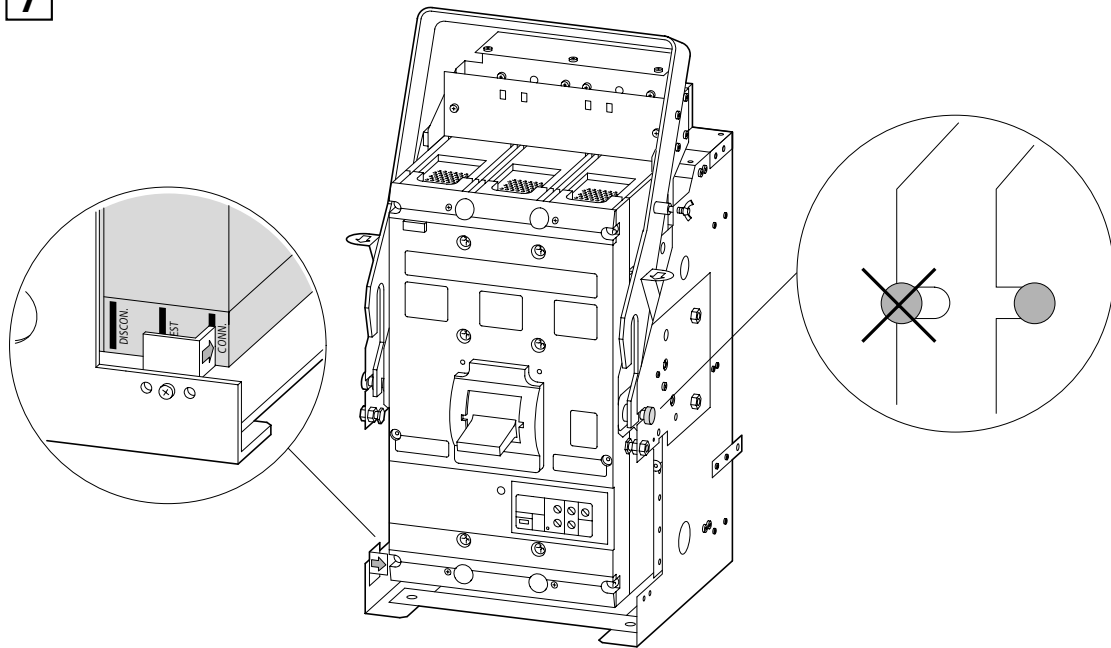

**8**

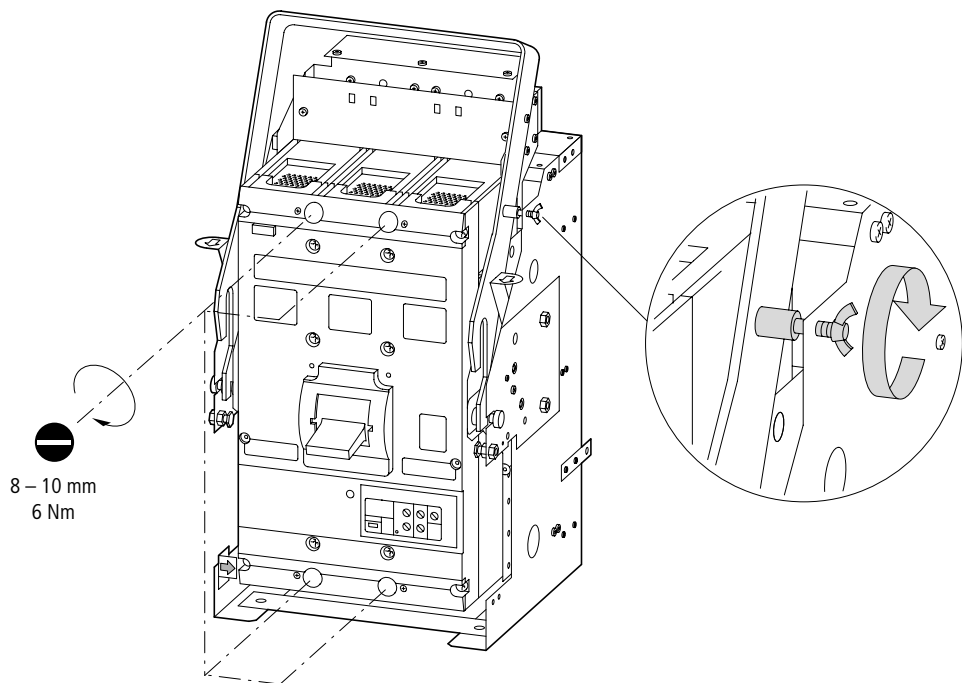

**1**

Ausfahren/Herausnehmen  
Disconnecting the breaker  
Débrochage  
Estrazione  
Desconexión  
Выкатывание/съём  
拉出/拿下

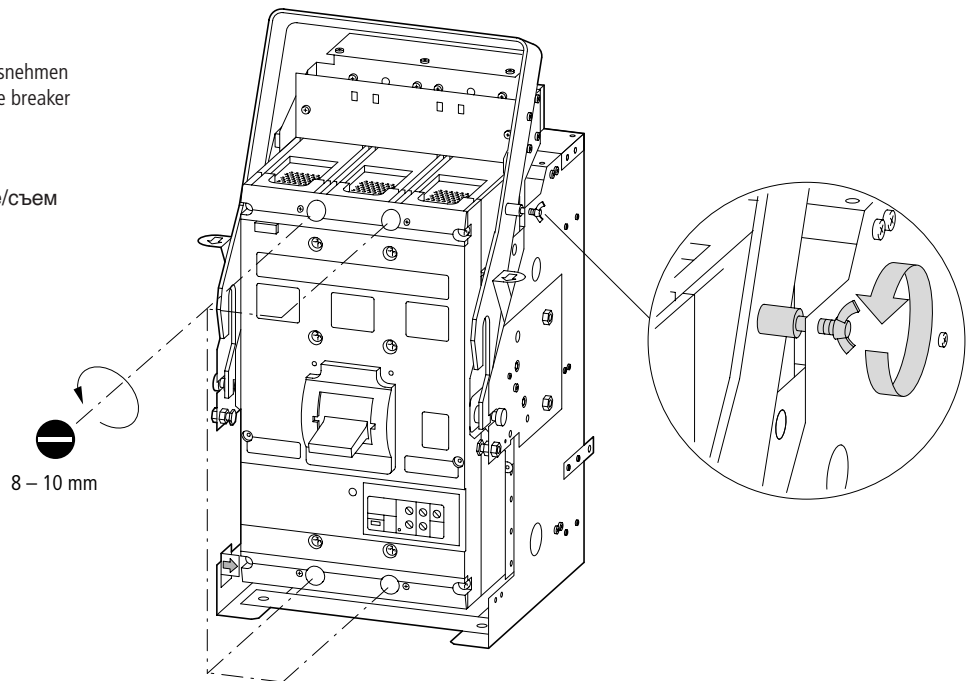

2

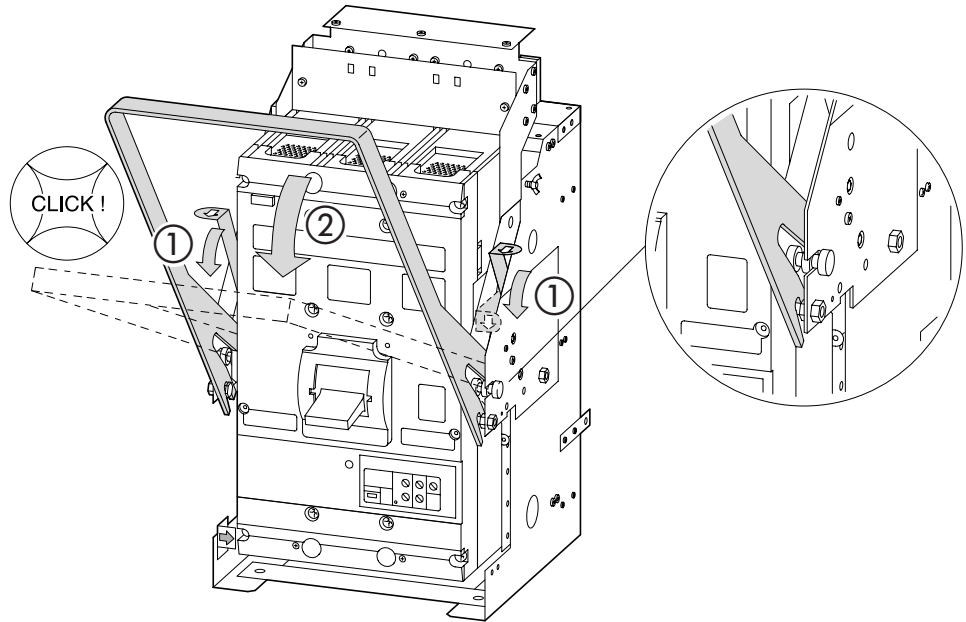

3

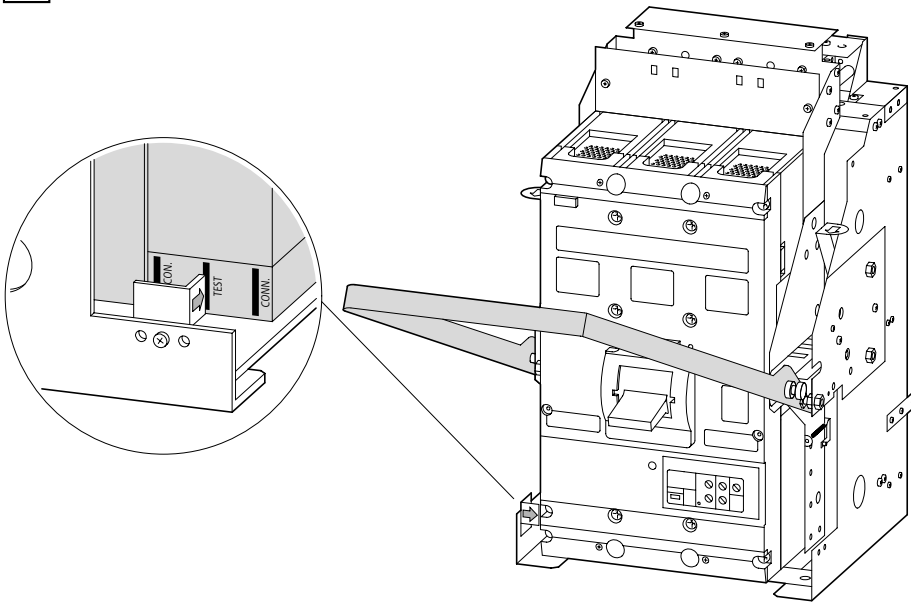

4

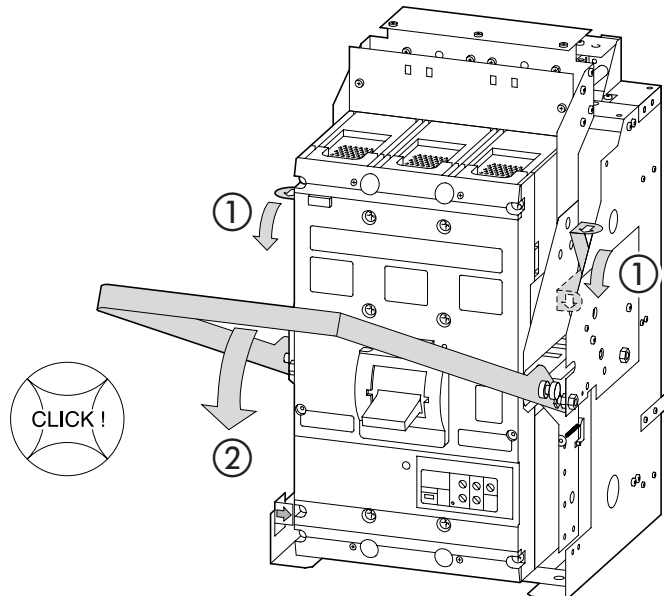

5

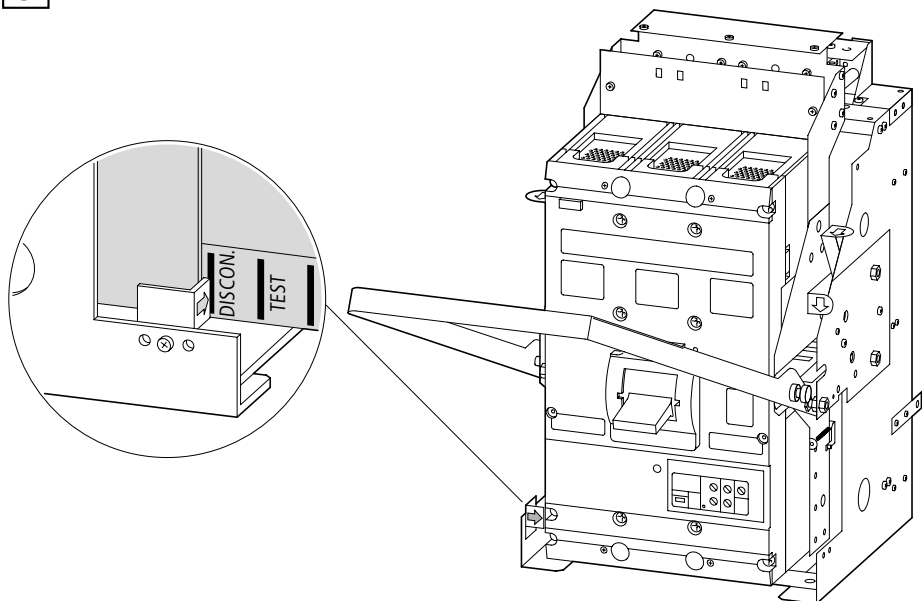

6

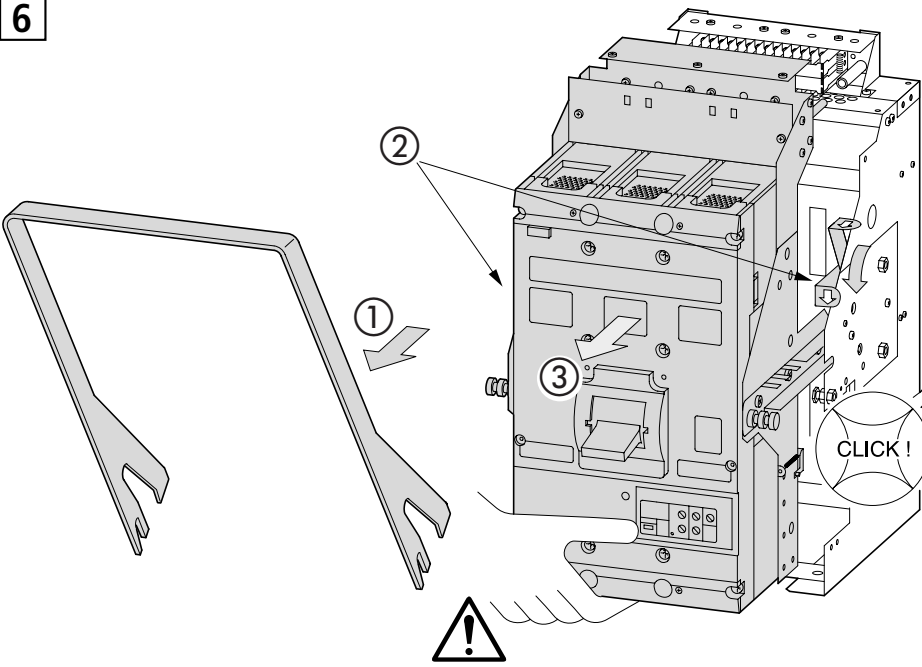

7

