

**NZMN(H)3-A400-S07-DC(-PIT)**

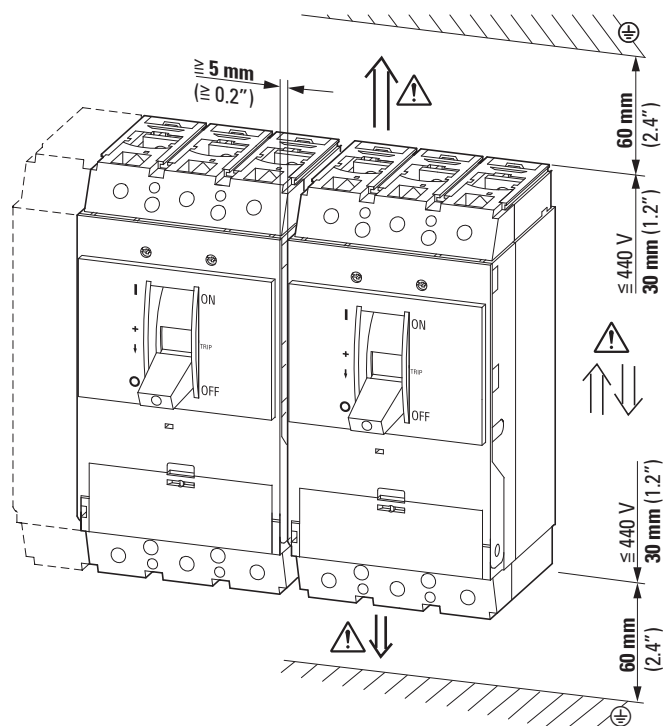

Blowout direction in case of a short-circuit

Ausblasrichtung im Kurzschlussfall

Dégagement gazeux en cas de court-circuit

Dirección de salida de los gases en caso de cortocircuito

Direzione di estinzione in caso di corto circuito

短路时的排空方向

Направление продувки в случае короткого замыкания

**(en) Electric current! Danger to life!**  
Only skilled or instructed persons may carry out the following operations.

**(de) Lebensgefahr durch elektrischen Strom!**  
Nur Elektrofachkräfte und elektrotechnisch unterwiesene Personen dürfen die im Folgenden beschriebenen Arbeiten ausführen.

**(fr) Tension électrique dangereuse !**  
Seules les personnes qualifiées et averties doivent exécuter les travaux ci-après.

**(es) ¡Corriente eléctrica! ¡Peligro de muerte!**  
El trabajo a continuación descrito debe ser realizado por personas cualificadas y advertidas.

**(it) Tensione elettrica: Pericolo di morte!**  
Solo persone abilitate e qualificate possono eseguire le operazioni di seguito riportate.

**(zh) 触电危险!**  
只允许专业人员和受过专业训练的人员进行下列工作。

**(ru) Электрический ток! Опасно для жизни!**  
Только специалисты или проинструктированные лица могут выполнять следующие операции.

**(en) Permitted circuit configurations – (de) Zulässige Verschaltungsarten –**  
**(fr) Types de câblage admissibles – (es) Tipos de circuito admisibles –**  
**(it) Tipi di collegamento ammessi – (zh) 允许的切换类型 –**  
**(ru) Допустимые способы коммутации**

Connection schematic	Both poles protected		One pole protected	
	Centrally grounded	Grounded and ungrounded	Centrally grounded	Grounded and ungrounded
Source grounding	500 V	250 V	n/a	500 V
NZM1	500 V	250 V	n/a	500 V
NZM2	750 V	375 V	n/a	750 V
NZM3	750 V	375 V	n/a	750 V

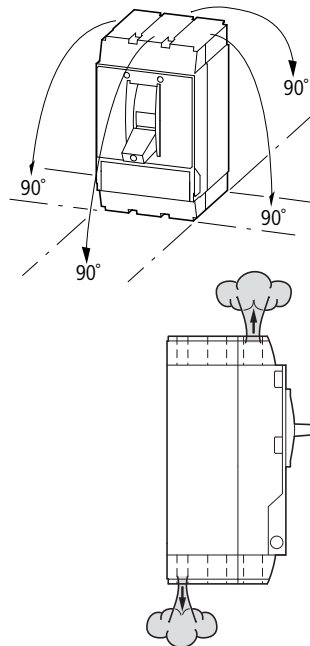
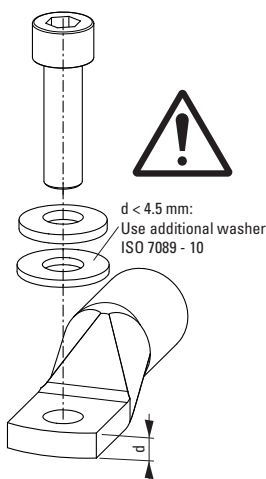

①	②	③
13 mm (0.5")	13 mm (0.5")	27 mm (1")
≤ 32 mm (≤ 1.25")	≤ 32 mm (≤ 1.25")	≤ 32 mm (≤ 1.25")
≤ 16 mm (≤ 0.63")	≤ 15 mm (≤ 0.59")	≤ 15 mm (≤ 0.59")
∅ 10.5 mm (∅ 0.4")	∅ 10.5 mm (∅ 0.4")	∅ 10.5 mm (∅ 0.4")
27 mm (1")	≥ 400 mm (≥ 15")	27 mm (1")
①	②	③
≥ 6 x 16 x 0.8 mm	≥ 20 x 5 mm	1 x 16 – 240 mm <sup>2</sup>
≤ 10 x 32 x 1 mm	≤ 30 x 15 mm	1 x 4 – 350 kcmil
+ 5 x 32 x 1 mm		
-	-	2 x 16 – 240 mm <sup>2</sup>
		2 x 4 – 350 kcmil

n = Number of crimps  
 n = Anzahl der Pressungen  
 n = Nombre de sertissages  
 n = Número de compresiones  
 n = Numero delle crimpature  
 n = 压制数量  
 n = Число прессований

n  
 2 NZM3-XKS185

A  
 185 mm<sup>2</sup> NZM3-XKS185

3pol M10 x 35

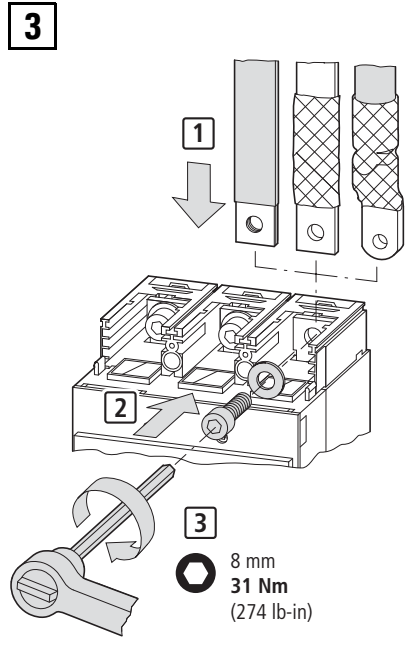
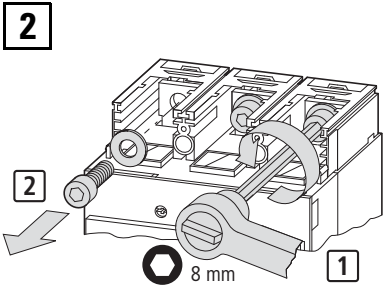
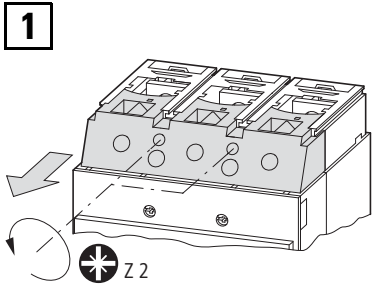

**NZMN(H)3-A400-S07-DC**

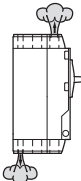

02/17 IL01209ZU

≅ 415 V ① +			
≅ 525 V ① +			
≅ 690 V ① +			
> 690 V ① +			

① Basic device – Grundgerät – Appareil de base – Aparato base – Apparechio base – 基础设备 – Основное устройство  
 + Combination options – Kombinationsmöglichkeiten – Combinaisons possibles – Combinaciones posibles – Combinazioni possibili  
 组合方法 – Комбинационные возможности  
 \* or – oder – ou – ó – oppure – 或者 – или

**4**

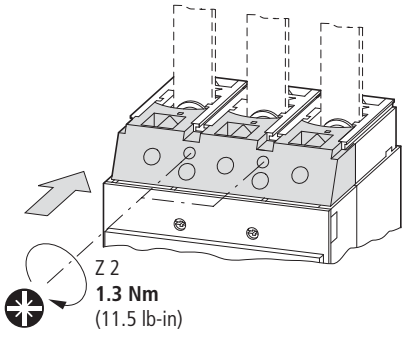

**5**

$I_r$  (A)  
Thermal adjustable

$I_i$  (A)  
Magnetic fixed

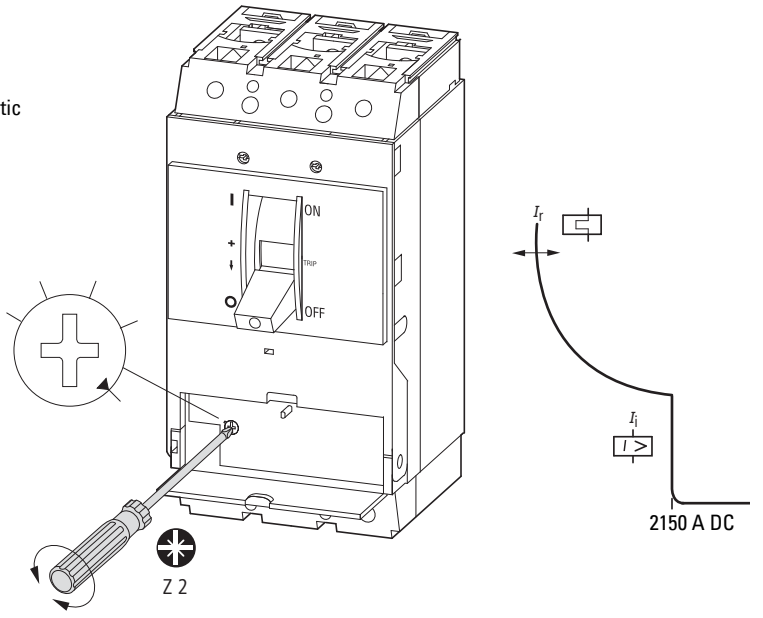

**M22-K10**  
**M22-K01**  
**M22-CK10**  
**M22-CK01**  
**Auxiliary Switches**

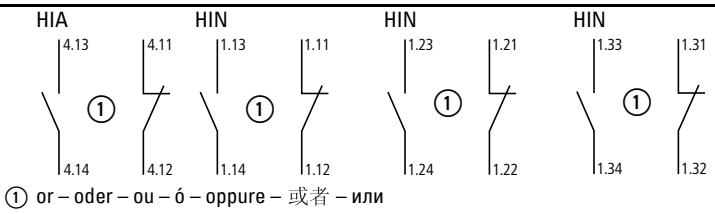

① or – oder – ou – ó – oppure – 或者 – или

**IEC**  $I_{th} = I_e$

	$U_e$ (V)	$I_e$ (A)
AC-15	115	4
	230	4
	400	2
	500	1
DC-13	24	3
	42	1.7
	60	1.2
	110	0.6
	220	0.3

02/17 IL012092ZU

**M22-CK11**  
**M22-CK20**  
**M22-CK02**

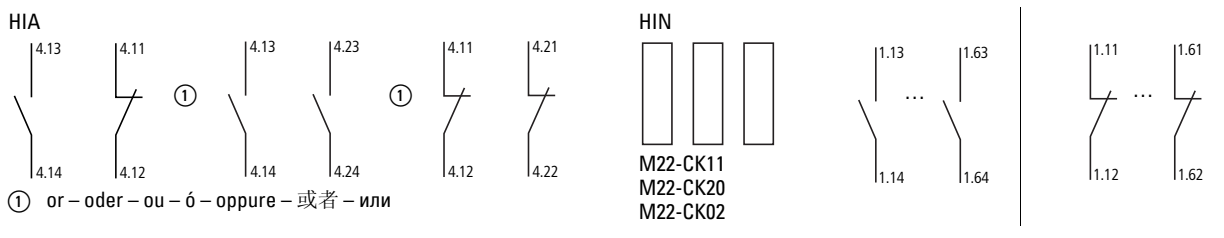

① or – oder – ou – ó – oppure – 或者 – или

**IEC**  $I_{th} = I_e$

	$U_e$ (V)	$I_e$ (A)
AC-15	115	4
	230	4
	400	2
DC-13	24	3
	42	1
	60	0.8
	110	0.5
	220	0.2



**5b****M22-CK10, M22-CK01**

(Clamp Terminals)

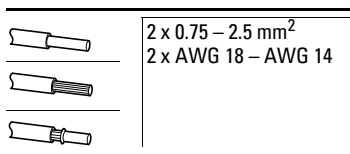
**5c****M22-CK11, M22-CK20, M22-CK02**

(Clamp Terminals)

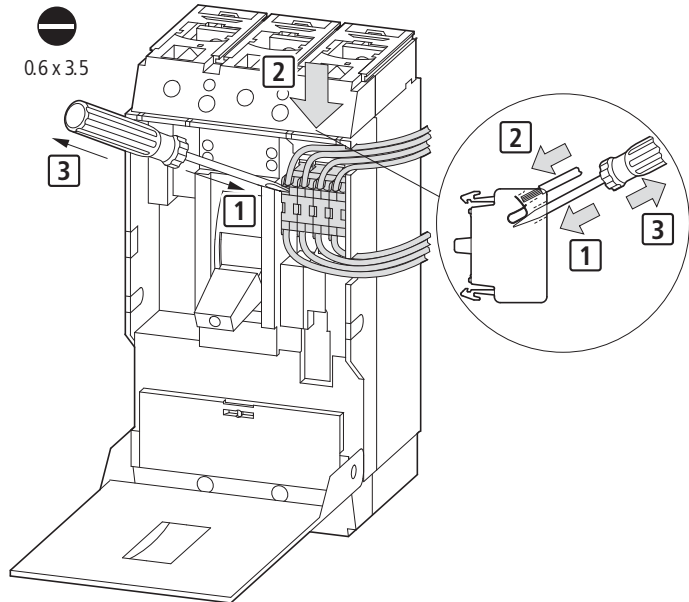
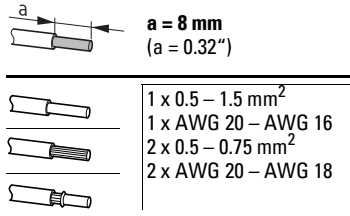
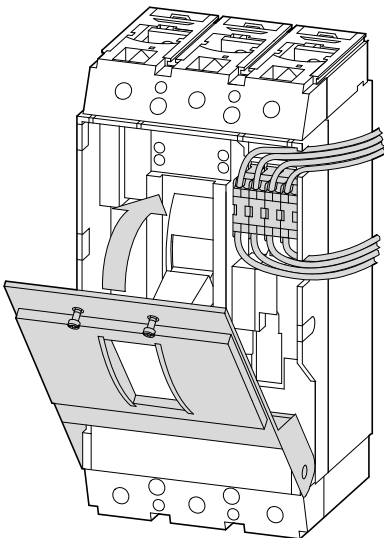
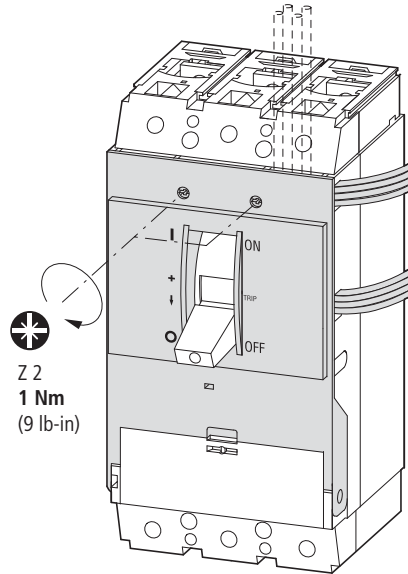
**6****7**

02/17 IL01209ZLU

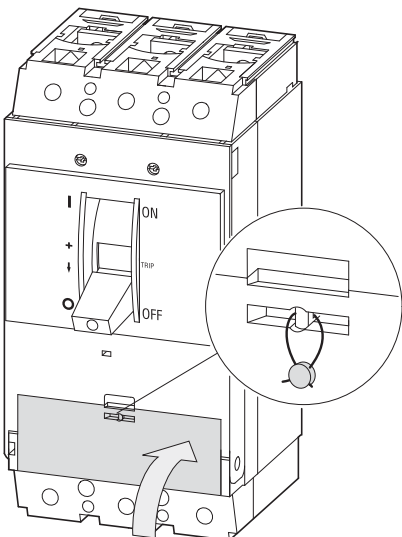
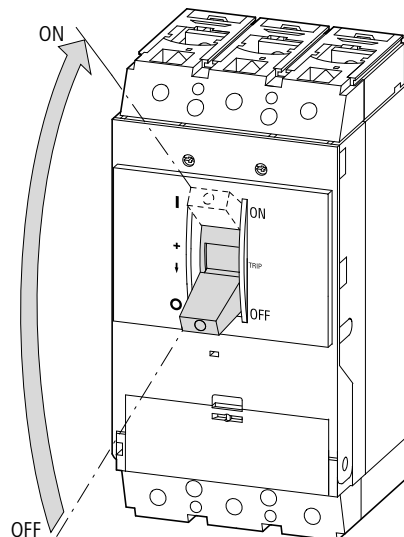
**TEST 1****Einklappseite: 17 mm Beschnitt**

**TEST 2**

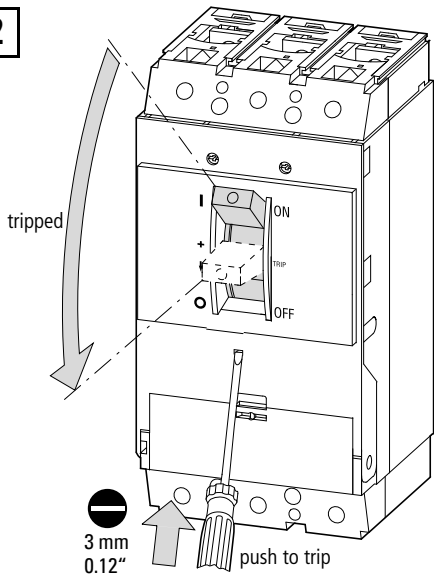

**TEST 3**

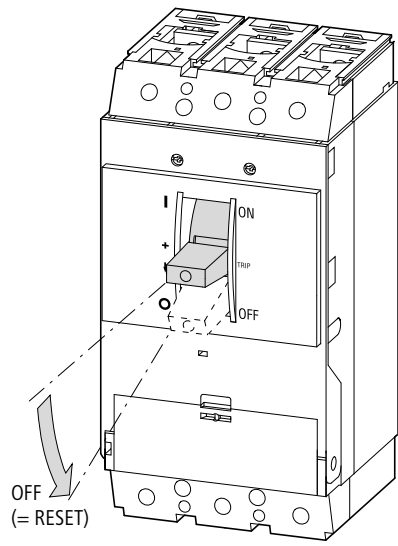

en Dismounting – de Demontage – fr Démontage – es Desmontaje –  
 it Smontaggio – zh 拆卸 – ru Демонтаж

**1**

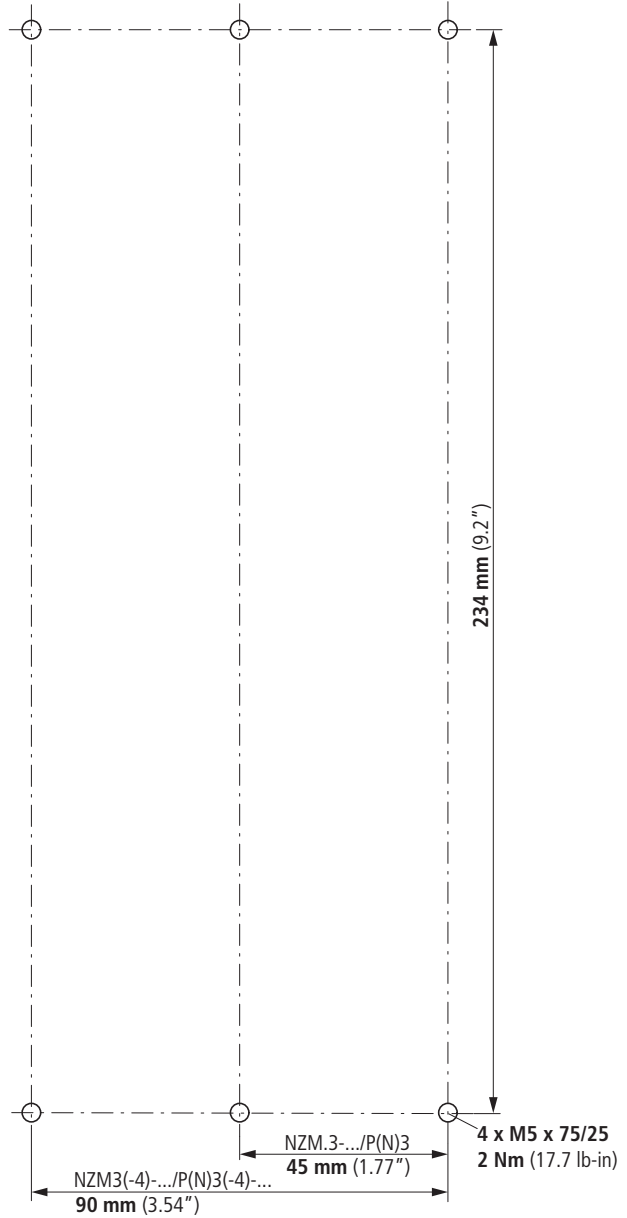
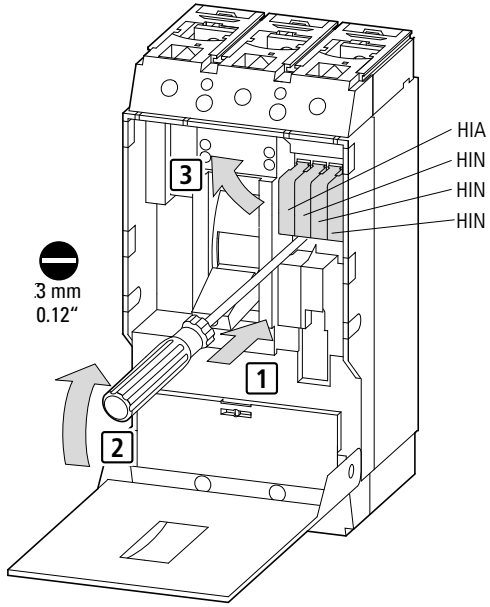

02/17 IL012092ZU