

NZM4-XAS12-...

N4-XAS12-...

NZM4-XAS12-1000

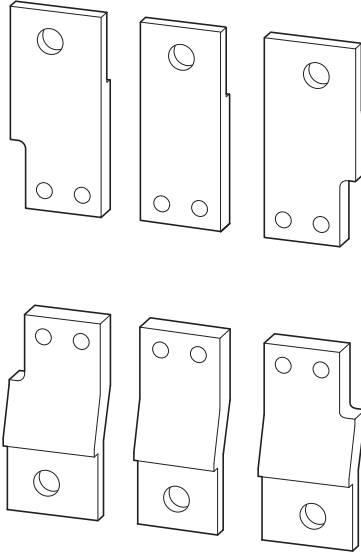

N4-XAS12-1000

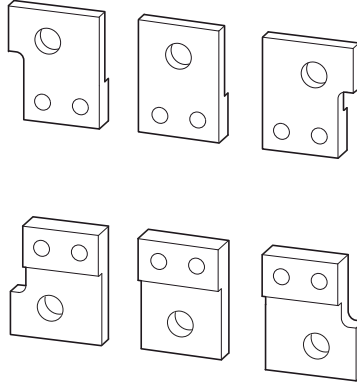

NZM4-XAS12-1250

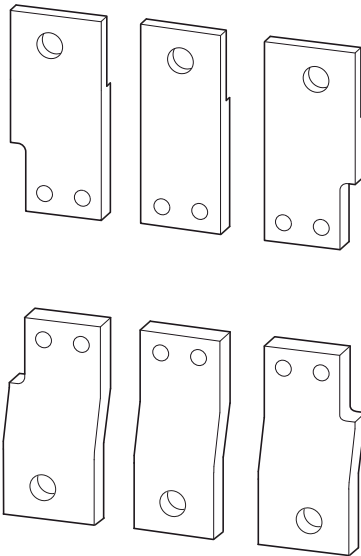

N4-XAS12-1250

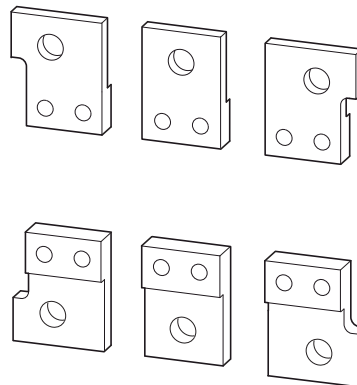

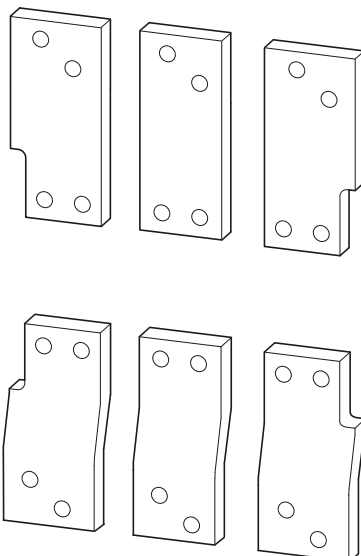

NZM4-XAS12-1600

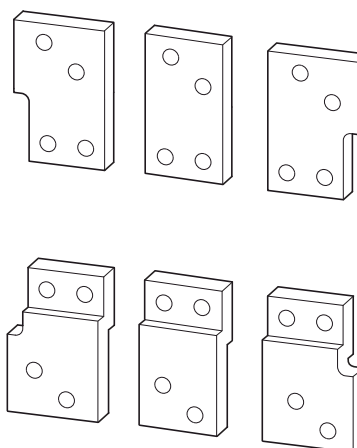

N4-XAS12-1600



  **Electric current! Danger to life!**

Only skilled or instructed persons may carry out the following operations.

 **Lebensgefahr durch elektrischen Strom!**

Nur Elektrofachkräfte und elektrotechnisch unterwiesene Personen dürfen die im Folgenden beschriebenen Arbeiten ausführen.

 **Tension électrique dangereuse !**

Seules les personnes qualifiées et averties doivent exécuter les travaux ci-après.

 **¡Corriente eléctrica! ¡Peligro de muerte!**

El trabajo a continuación descrito debe ser realizado por personas cualificadas y advertidas.

 **Tensione elettrica: Pericolo di morte!**

Solo persone abilitate e qualificate possono eseguire le operazioni di seguito riportate.

 **触电危险!**

只允许专业人员和受过专业训练的人员进行下列工作。

 **Электрический ток! Опасно для жизни!**

Только специалисты или проинструктированные лица могут выполнять следующие операции.

N(ZM)4-XAS12-...

1

Top connection
Anschluss oben
Raccordement supérieure
Conexión superior
Collegamento superiore
上部接头
Присоединение верх

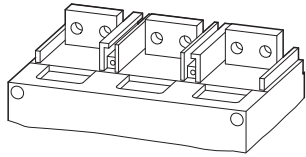

2

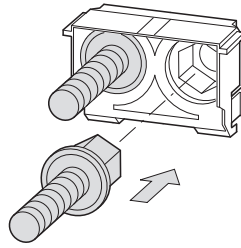

3

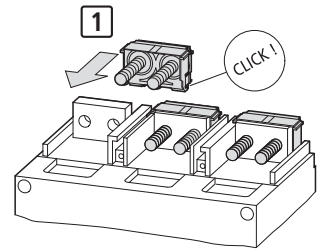

4

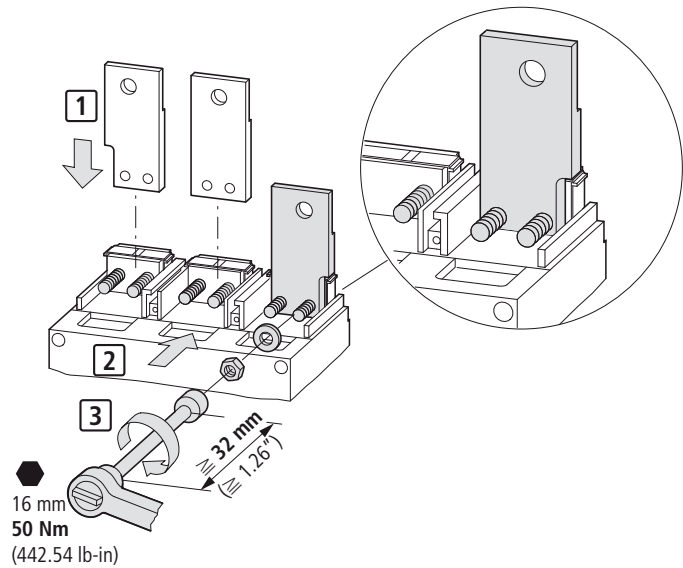

5

Bottom connection
Anschluss unten
Raccordement inférieur
Conexión inferior
Collegamento inferiore
下部接头
Присоединение низ

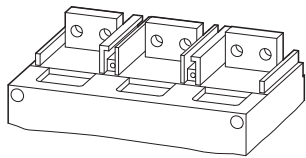

6

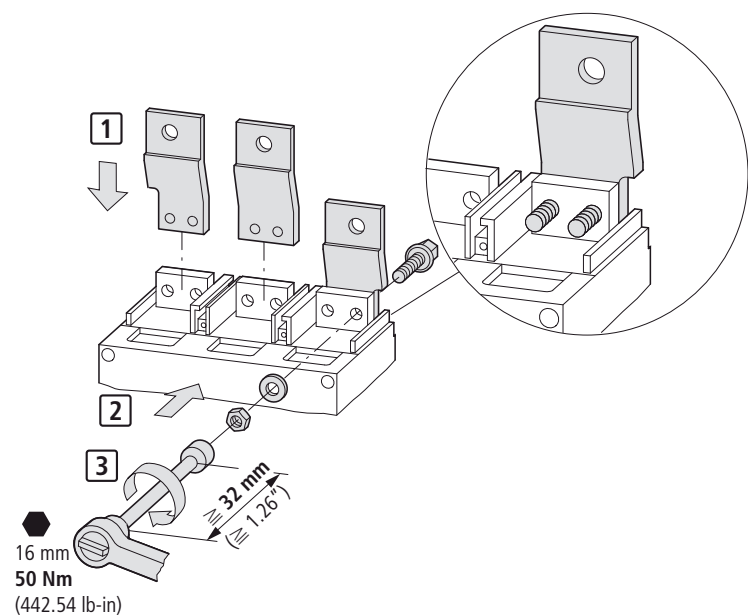

N(ZM)12-...	N(ZM)4-XAS12-...
N(ZM)12-630	N(ZM)4-XAS12-1000
N(ZM)12-800 (x = 8 mm (0.31"))	
N(ZM)12-1000	
N(ZM)12-800 (x = 10 mm (0.39"))	N(ZM)4-XAS12-1250
N(ZM)12-1250	
N(ZM)12-1600	N(ZM)4-XAS12-1600

x → AWA1230-2244, 3/4 **7**

03/11 IL01219030Z

7 Disconnect the breaker – Herausnehmen des Schalters – Démontage du disjoncteur – Desconexión del interruptor – Estrazione dell'interruttore – 开关取出 – Вынимание выключателя

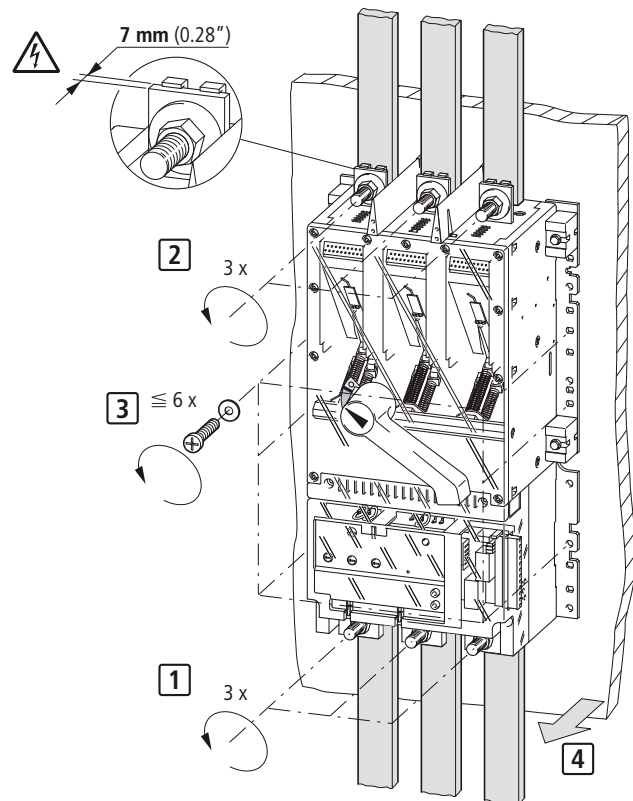

8a NZM4-XAS12-1000
NZM4-XAS12-1250
NZM4-XAS12-1600

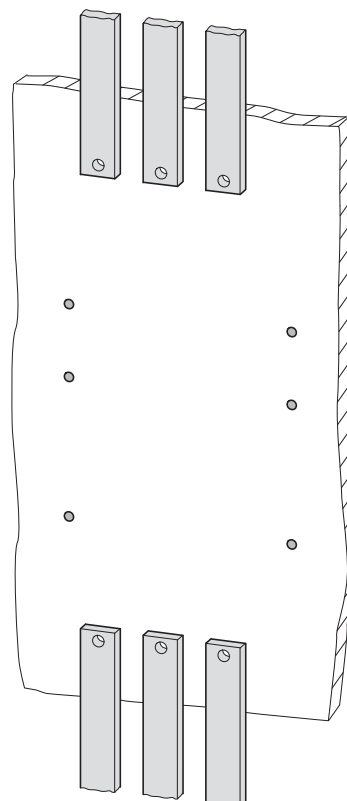

8b N4-XAS12-1000
N4-XAS12-1250

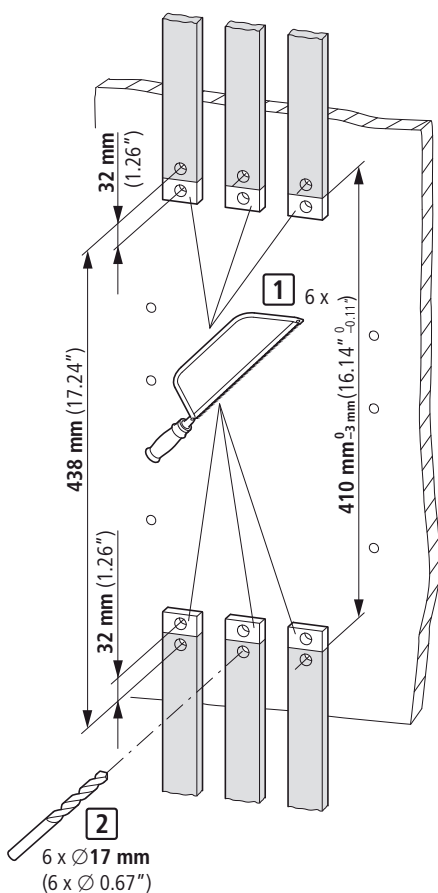

Top connection
Anschluss oben
Raccordement supérieure
Conexión superior
Collegamento superiore
上部接头
Присоединение верх

Bottom connection
Anschluss unten
Raccordement inférieur
Conexión inferior
Collegamento inferiore
下部接头
Присоединение низ

8c N4-XAS12-1600

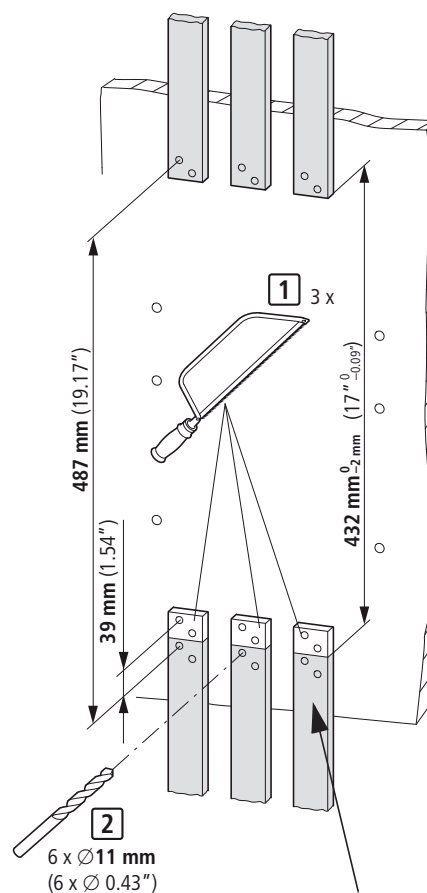

Top connection
Anschluss oben
Raccordement supérieure
Conexión superior
Collegamento superiore
上部接头
Присоединение верх

Bottom connection
Anschluss unten
Raccordement inférieur
Conexión inferior
Collegamento inferiore
下部接头
Присоединение низ

Warning!
Avoid pollution of the electrical system.

Warning!
Verschmutzung der elektrischen Anlage vermeiden.

Avertissement !
Eviter l'encrassement de l'installation électrique.

¡Advertencia!
Evitar que se ensucie la instalación eléctrica.

Avvertimento!
Evitare la contaminazione dell'impianto elettrico.

警告!
避免电子设备受到污染。

Предупреждение!
Избегать загрязнения электрических установок.

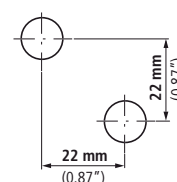

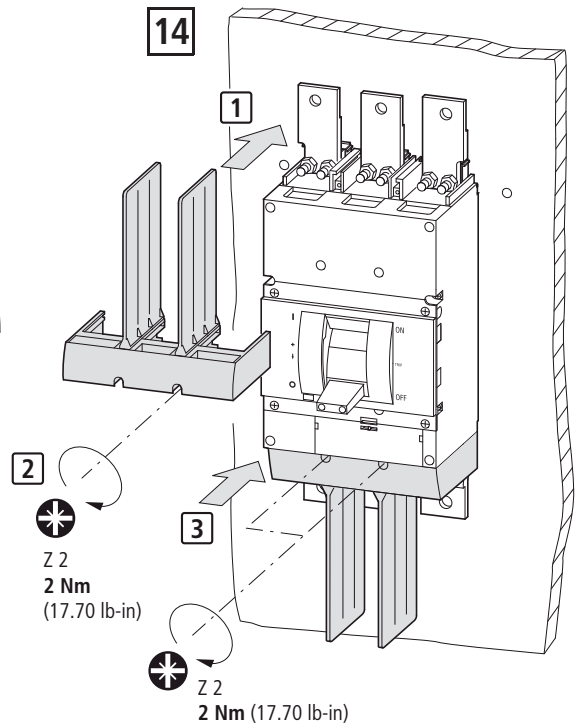
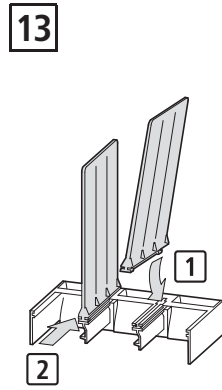
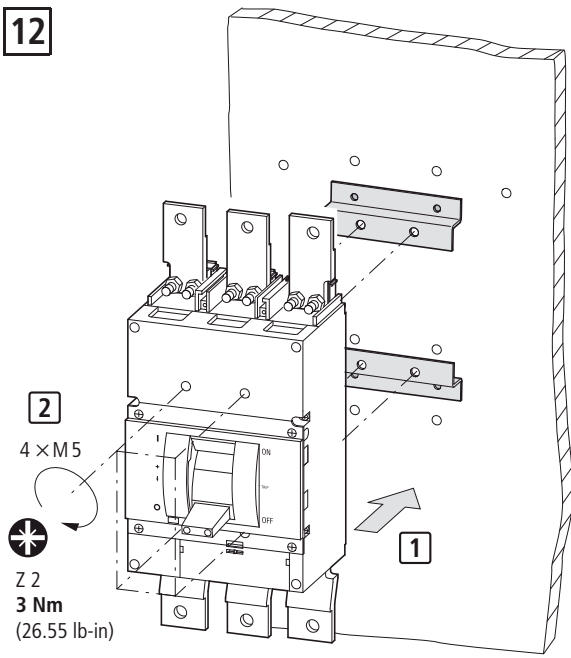
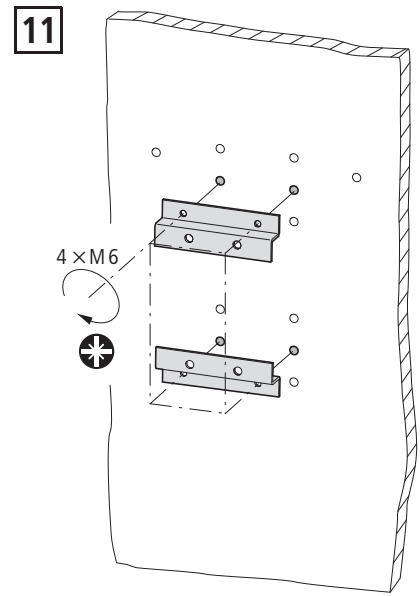
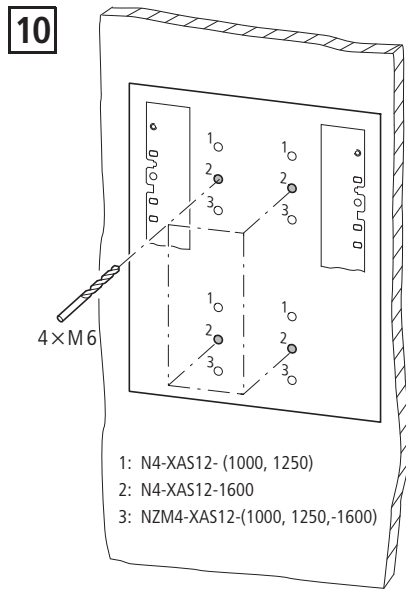
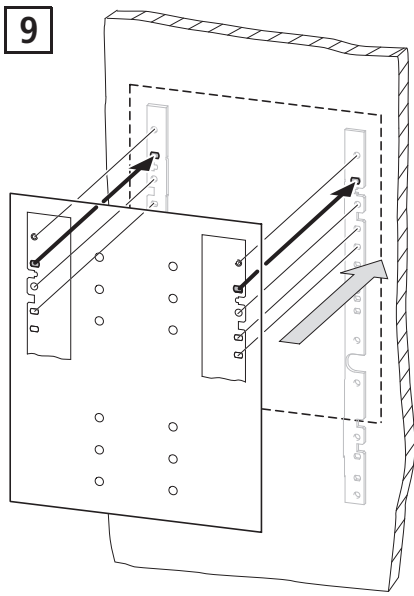

03/11 IL01219030Z

Moving the switch shaft – Verschieben der Schalterachse – Déplacement de l'arbre du disjoncteur – Desplazamiento del eje del interruptor – Spostamento dell'asse interruttore – Смещение вала выключателя – 移动开关轴

15a NZM4-XAS12-1000, NZM4-XAS12-1250, NZM4-XAS12-1600

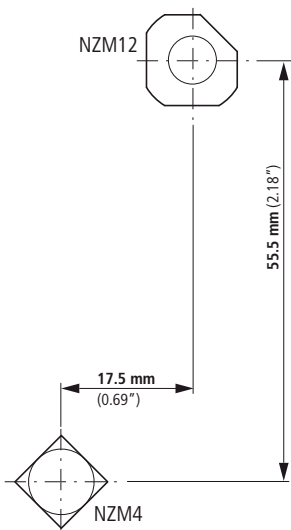

15b N4-XAS12-1000, N4-XAS12-1250

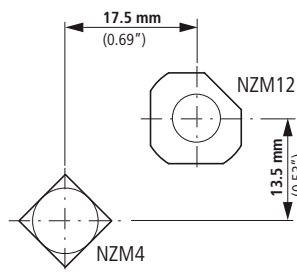

15c N4-XAS12-1600

