

# Magnum cassette standard/double frame rejection bracket replacement kit

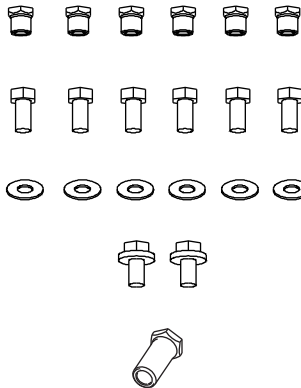
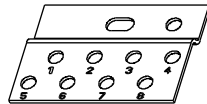

## Contents

Description	Page
General information . . . . .	2
Installation of rejection bracket kit. . . . .	2

**⚠ WARNING**

- (1) ONLY QUALIFIED ELECTRICAL PERSONNEL SHOULD BE PERMITTED TO WORK ON THE EQUIPMENT
- (2) ALWAYS DE-ENERGIZE PRIMARY AND SECONDARY CIRCUITS IF A CIRCUIT BREAKER CANNOT BE REMOVED TO A SAFE WORK LOCATION
- (3) DRAWOUT CIRCUIT BREAKERS SHOULD BE LEVERED (RACKED) OUT TO THE DISCONNECT POSITION.
- (4) ALL CIRCUIT BREAKERS SHOULD BE SWITCHED TO THE OFF POSITION AND MECHANISM SPRINGS DISCHARGED.

FAILURE TO FOLLOW THESE STEPS FOR ALL PROCEDURES DESCRIBED IN THIS INSTRUCTION LEAFLET COULD RESULT IN DEATH, BODILY INJURY, OR PROPERTY DAMAGE.

**⚠ WARNING**

THE INSTRUCTIONS CONTAINED IN THIS IL AND ON PRODUCT LABELS MUST BE FOLLOWED. OBSERVE THE FIVE SAFETY RULES.

- DISCONNECTING;
- ENSURE THAT DEVICES CANNOT BE ACCIDENTALLY RESTARTED;
- VERIFY ISOLATION FROM THE SUPPLY;
- EARTHING AND SHORT-CIRCUITING; AND;
- COVERING OR PROVIDING BARRIERS TO ADJACENT LIVE PARTS.

DISCONNECT THE EQUIPMENT FROM THE SUPPLY. USE ONLY AUTHORIZED SPARE PARTS IN THE REPAIR OF THE EQUIPMENT. THE SPECIFIED MAINTENANCE INTERVALS AS WELL AS THE INSTRUCTIONS FOR REPAIR AND EXCHANGE MUST BE STRICTLY ADHERED TO PREVENT INJURY TO PERSONNEL AND DAMAGE TO THE SWITCHBOARD.

**General information**

Magnum® drawout circuit breakers come in a variety of continuous current and interrupting ratings. To prevent the insertion of a drawout circuit breaker into a cassette with which it is incompatible, rejection interlock key plates are provided for both the circuit breaker and the cassette. As the breaker is pushed into the cassette, the interlock pins on the breaker move past the pins in the cassette if they are compatible.

**Required tools**

- 10 mm socket and drive
- 10 mm wrench

**Kit parts identification**

Refer to **Figure 1** kit parts listed below:

- (A) Rejection bracket (one)
- (B) M6 stop nut (six)
- (C) M6 x 12 mm hex bolt (six)
- (D) M6 serrated lock washer (six)
- (E) M6 x 10 mm CrimpTite® screw (two)
- (F) M6 long stop nut

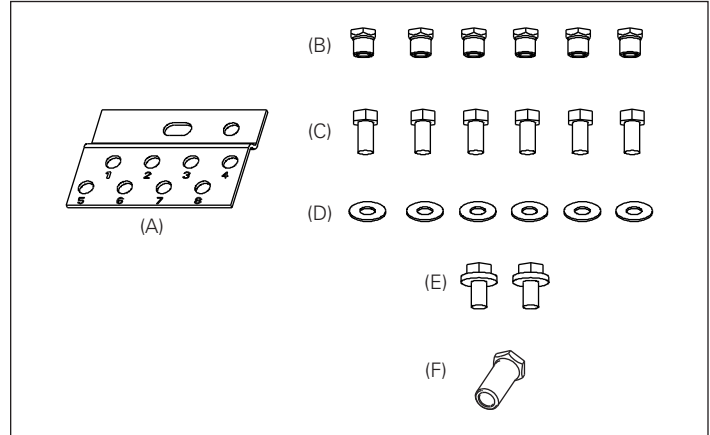

Figure 1. Contents of kit

**Installation of rejection bracket kit**

Proceed with the following steps:

**Step 1:** From **Table 1** and **Table 2** on **page 3**, determine the number and location of stop nuts **(B)** or **(F)**, washers **(D)**, and hex bolts **(C)** to be used. All parts are not required for all assemblies. Insert bolts and lock washers into the appropriate holes in the rejection bracket **(A)**, and assemble stop nuts from the other side. Torque to 8–10 ft-lbs (10.5–13 Nm).

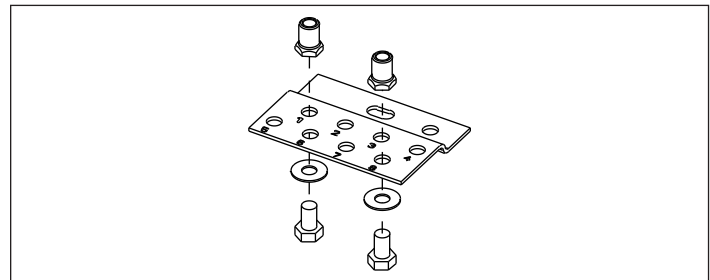

Figure 2. Step 1

**Note:** The stop nut arrangement shown here is for reference purposes only, and is not a valid configuration. Refer to **Table 1** for MPS, SPS, MDS, MDE, and SBS configurations or **Table 2** for MDSX, MDDX, MDSH, and SBSE configurations.

**Step 2:** Assemble the bracket assembly to the floor of the cassette as shown using two M6 x 10 mm thread-forming CrimpTite screws **(E)**. Torque to 8–10 ft-lbs (10.5–13 Nm).

If the cassette is for use with a standard breaker frame of 3200 A or below, the installation is complete. If the cassette is for use with a large breaker frame over 3200 A, proceed to **Step 3**.

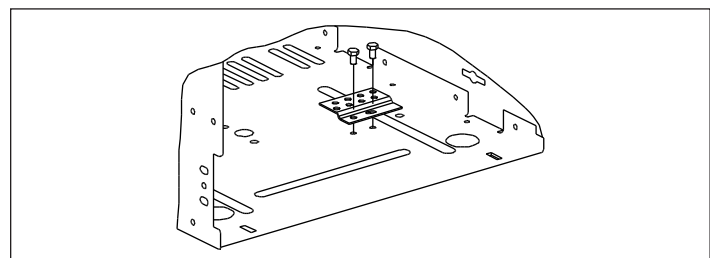

Figure 3. Step 2

**Step 3:** On cassettes for breaker frames over 3200 A, install two identical rejection bracket assemblies as shown.

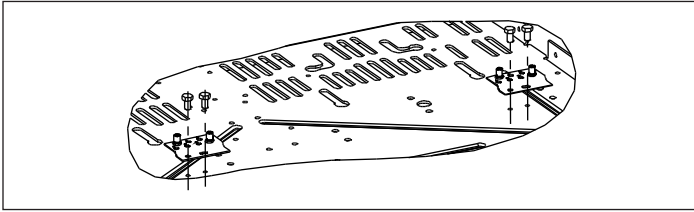

Figure 4. Step 3

**Table 1. Cassette rejection interlock pin locations for breakers MPS, SPS, MDS, MDE, and SBS**

Breaker frame rating	Pin locations							
	1	2	3	4	5	6	7	8
408/84N			■	■	■	■	■	
508/64N	■			■	■	■	■	
608/840	■	■		■	■	■		
808/640	■	■	■		■	■		
C08/C4N	■	■	■	■		■		
512/C40			■	■	■	■		■
612/85N		■		■	■	■		■
812/86N		■	■		■	■		■
C12/850		■	■	■		■		■
516/860	■		■	■	■			■
616/C5N	■	■		■	■			■
816/C6N	■	■	■		■		■	
C16/C50		■	■	■			■	■
620/C60				■	■	■	■	■
820/E4N		■	■		■		■	■
C20/E40			■	■		■	■	■
625/E5N		■		■	■	■	■	
825/E6N		■	■		■	■	■	
C25/E50		■	■	■		■	■	
630/E60	■			■	■	■		■
830/84A	■		■		■	■		■
C30/85A	■		■	■		■		■
632/C4A	■			■	■		■	■
832/C5A	■		■		■		■	■
C32/C6A	■		■	■			■	■
L08/L12/L16 ①	■	■		■	■	■	■	
L20 ①	■		■	■	■	■	■	

① Not available for MPS and SPS.

**Table 2. Cassette rejection interlock pin locations for breakers MDSX, MDDX, MDSH, and SBSE**

Breaker frame rating	Pin locations					
	1	2	3	4	5	6
X08/X40/X4A		■	LG		■	■
X12/X4N		■	LG	■		■
X16/X50/X60/X5A/X6A		■	LG	■	■	
X20/X5N/X6N	■		LG		■	■
X3N/H20	■		LG	■		■
X3P/H16	■		LG	■	■	
E40/E08	■	■	LG			■
E4N/E12	■	■	LG	■		
E50/E16	■	■	LG		■	
E5N/E20			LG		■	■
E60/E25			LG	■		■
E6N/E30			LG	■	■	
H4A/H32	■	■	LG			
H40/H08	■		LG		■	
H4N/H12		■	LG		■	
H5N/H6N/H25		■	LG	■		
H5A/H50/H6A/H60/H30			LG		■	■

**Table 3. Cassette rejection interlock pin locations for breakers DAS and DBS**

Breaker frame rating	Pin locations							
	1	2	3	4	5	6	7	8
DAS516	■	■		■	■			■
DAS532/520	■		■		■		■	■
DBS532	■		■	■			■	■

The instructions for installation, testing, maintenance, or repair herein are provided for the use of the product in general commercial applications and may not be appropriate for use in nuclear applications. Additional instructions may be available upon specific request to replace, amend, or supplement these instructions to qualify them for use with the product in safety-related applications in a nuclear facility.

This Instruction Booklet is published solely for information purposes and should not be considered all-inclusive. If further information is required, you should consult an authorized Eaton sales representative.

The sale of the product shown in this literature is subject to the terms and conditions outlined in appropriate Eaton selling policies or other contractual agreement between the parties. This literature is not intended to and does not enlarge or add to any such contract. The sole source governing the rights and remedies of any purchaser of this equipment is the contract between the purchaser and Eaton.

**NO WARRANTIES, EXPRESSED OR IMPLIED, INCLUDING WARRANTIES OF FITNESS FOR A PARTICULAR PURPOSE OR MERCHANTABILITY, OR WARRANTIES ARISING FROM COURSE OF DEALING OR USAGE OF TRADE, ARE MADE REGARDING THE INFORMATION, RECOMMENDATIONS, AND DESCRIPTIONS CONTAINED HEREIN.**

In no event will Eaton be responsible to the purchaser or user in contract, in tort (including negligence), strict liability or otherwise for any special, indirect, incidental or consequential damage or loss whatsoever, including but not limited to damage or loss of use of equipment, plant or power system, cost of capital, loss of power, additional expenses in the use of existing power facilities, or claims against the purchaser or user by its customers resulting from the use of the information, recommendations and description contained herein.

**Eaton**  
1000 Eaton Boulevard  
Cleveland, OH 44122  
United States  
Eaton.com

© 2022 Eaton  
All Rights Reserved  
Printed in USA  
Publication No. IL2C15760H11 / TBG001589  
April 2022