

**⚠ DANGER**

**HAZARD OF ELECTRIC SHOCK, EXPLOSION OR ARC FLASH**

**MAY RESULT IN DEATH OR SERIOUS INJURY**

Working on or near energized circuits poses a serious risk of electric shock. De-energize all circuits before installing or servicing this equipment and follow all prescribed safety procedures.

**⚠ PELIGRO**

**RIESGO DE DESCARGA ELÉCTRICA, EXPLOSIÓN O ARCO ELÉCTRICO**

**PUEDO CAUSAR LESIONES GRAVES O INCLUSO LA MUERTE**

Trabajar en o cerca de circuitos energizados representa un grave riesgo de descarga eléctrica. Desconecte todos los circuitos antes de realizar alguna instalación o de dar servicio a este equipo y siga todos los procedimientos de seguridad indicados.

**⚠ DANGER**

**RISQUE D'ÉLECTROCUTION, D'EXPLOSION OU D'ARC ÉLECTRIQUE**

**RISQUE DE MORT OU DE BLESSURES GRAVES**

Travailler sur des circuits sous tension ou à proximité pose un risque grave de choc électrique. Mettez tous les circuits hors tension avant d'installer ou d'effectuer l'entretien de cet équipement et suivre toutes les procédures de sécurité prescrites.

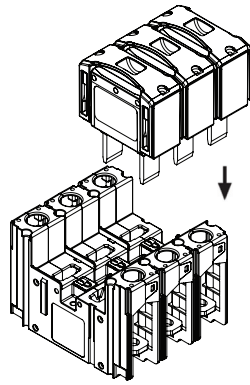

Insert fuses by aligning blades with holder slots and pushing in until fully seated.

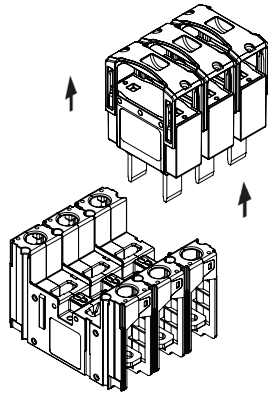

Extract fuses by extending built-in handles and pulling straight out.

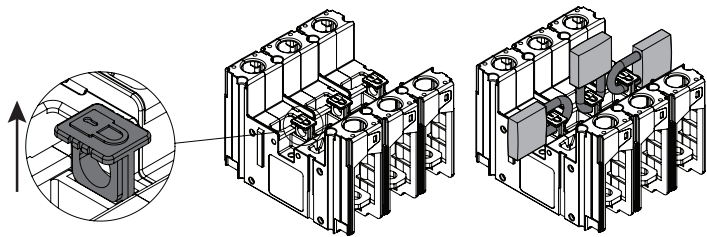

Lockout/tagout feature: pull tab out from base and insert one 1/4" lock per pole.

# BUSSMANN SERIES

These instructions cover the single-pole 200, 225 and 400 A CUBEFuse holder catalog numbers:  
 TCFH200N (110-200 A fuse case size)  
 TCFH225N (225 A fuse case size)  
 TCFH400N (250-400 A fuse case size)

Multi-pole configurations are made by dovetailing single-pole units to create the desired number of poles.

**NOTE:** While the 200 amp TCFH200N and 225 amp TCFH225N holders can be dovetailed together, the 200 amp holder will not accept a 225 A CUBEFuse (amp rating rejecting), while the 225 amp holder will accept any CUBEFuse from 110 to 225 amps.

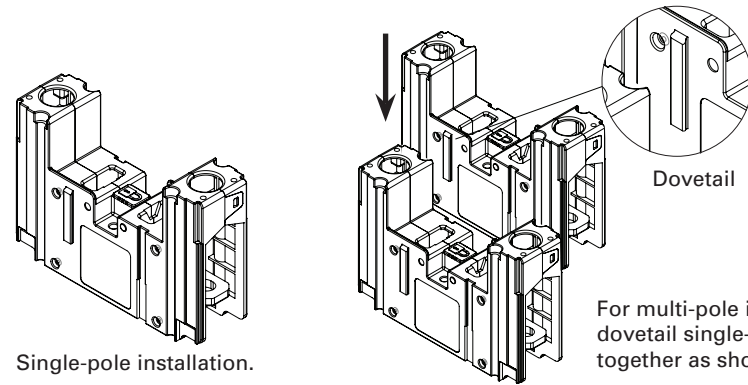

Single-pole installation.

For multi-pole installations, dovetail single-pole units together as shown.

**NOTE:** Installation requires two (2) #6-32 x 1-3/4" customer supplied mounting screws per pole and desired lug kit (see table on next page).

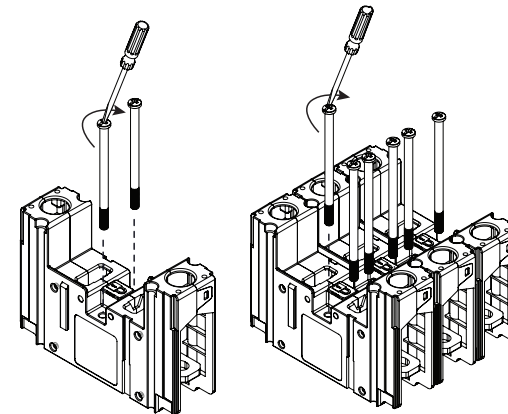

Locate and mark holes for customer supplied mounting screws as shown. Drill and tap mounting holes in the back plate, insert mounting screws and torque to 2.3 N•m (20 lb-in).

This table contains information on the various lug kits associated with these fuse holders. Please refer to this table for the allowable wire types, temperature ratings and torque values.

Lug catalog number	Lugs per cat. no.	AWG (mm <sup>2</sup> )	Wire type/temp.	Conductor torque N·m (lb-in)	Lug mounting screw torque N·m (lb-in)
<b>200 and 225 A holders</b>					
CCP2-L2-1	1	350-4 (185-25)	Cu 75°C	20.3 (180)	0.9 (8)
CCP2-L2-1A	1	350-4 (185-25)	Cu/Al 75°C	28.2 (250)	22.0 (200)
<b>400 A holders</b>					
CCP2-L4-1	1	500-2 (240-35)	Cu 75°C	42.0 (375)	22.0 (200)
CCP2-L4B-3	3	750-500 (380-240)	Cu 75°C	57.0 (500)	
CCP2-L4-1A	1	500-2 (240-35)	Cu/Al 75°C	42.0 (375)	
CCP2-L4B-3A	3	750-500 (380-240)	Cu/Al 75°C	62.0 (550)	

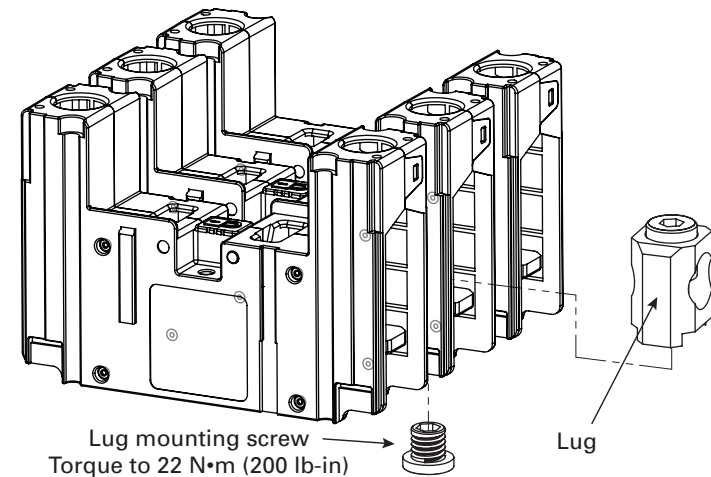
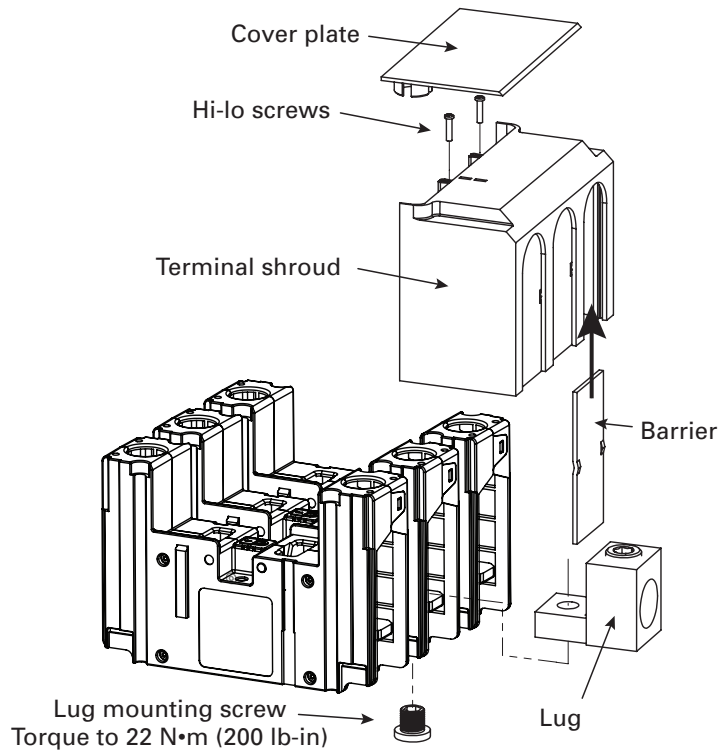

Installing lug kit catalog numbers CCP2-L4-1 and CCP2-L4-1A for use on 400 amp holders  
 For a complete installation on three ganged 400 amp holders, install the available terminal shroud. Order catalog number CCP2-TS6-3.

Installing lug kit catalog numbers CCP2-L4B-3 and CCP2-L4B-3A for 400 amp holders.

Note the kit comes with three lugs, terminal shroud, barriers, hi-lo screws and cover plate for use on three ganged 400 amp holders.