

**STEP 5**

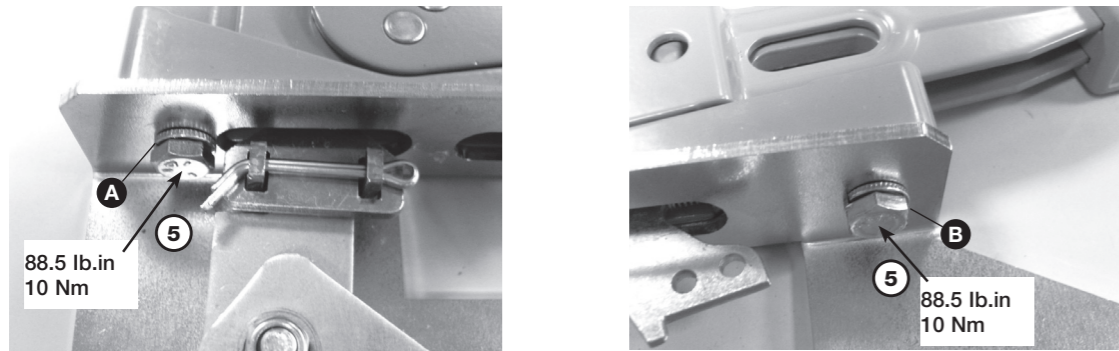

**STEP 6**

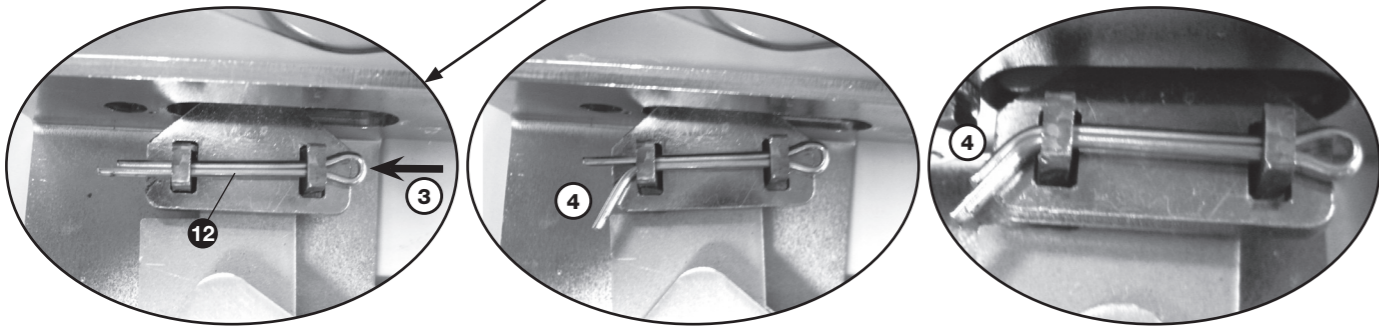
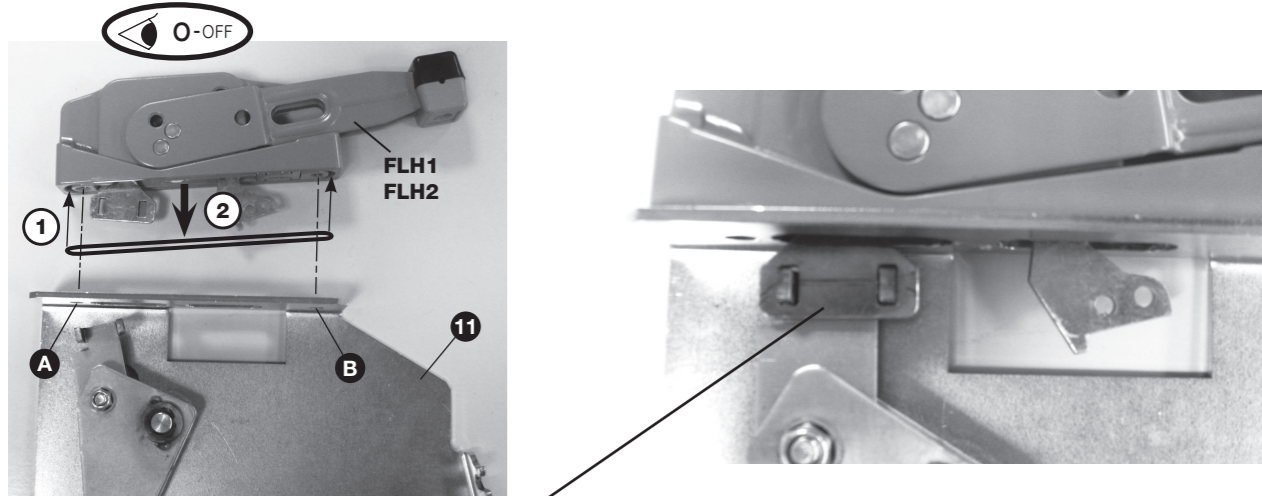
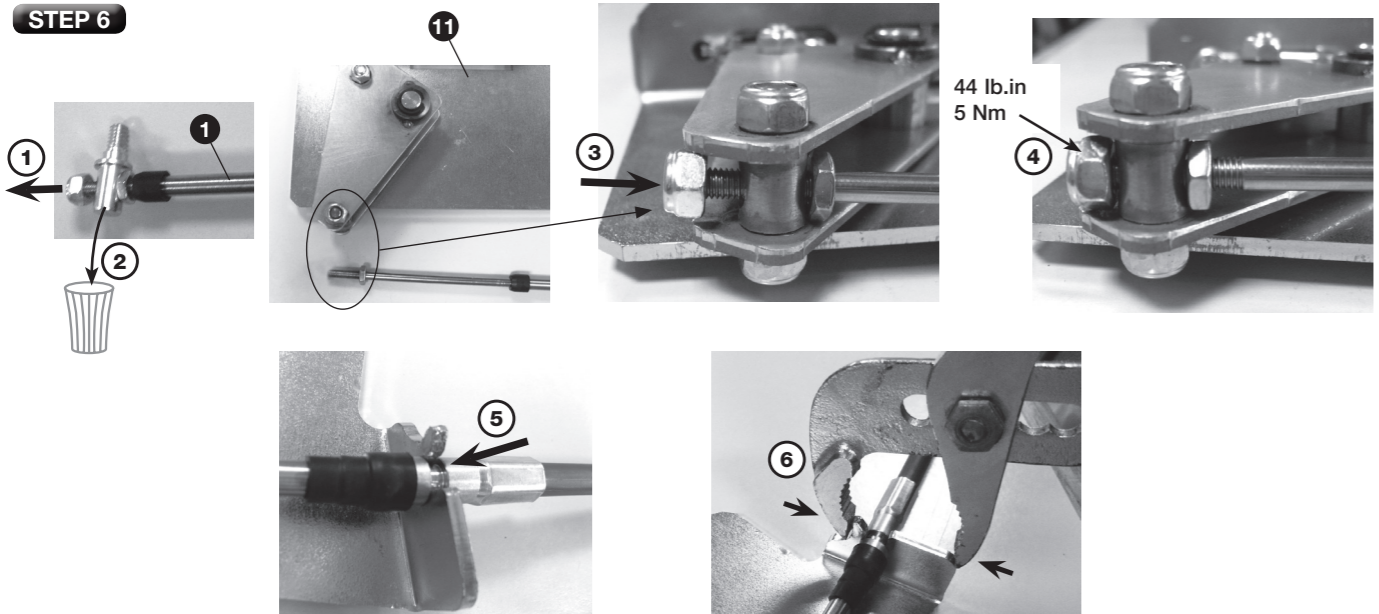

COOPER

**Bussmann™**

**CABLE FLANGE FOR UL98 FUSIBLE DISCONNECT SWITCHES**

**⚠ DANGER / DANGER / PELIGRO**

**HAZARDOUS VOLTAGE**

- This equipment must be installed and serviced only by qualified electrical personnel.
- Turn off all power supplying this equipment before working on or inside equipment.
- Always use a properly rated voltage sensing device to confirm power is OFF.
- Replace all devices, doors, and covers before turning on power to this equipment.
- Maintain electrical clearances between cable and live parts.

Failure to follow these instructions will result in death or serious injury.

**TENSION DANGEREUSE**

- L'installation et l'entretien de cet appareil ne doivent être effectués que par du personnel qualifié.
- Coupez l'alimentation de cet appareil avant d'y travailler.
- Utilisez toujours un dispositif de détection de tension à valeur nominale approprié pour confirmer que toute alimentation est coupée.
- Remplacez tous les dispositifs, les portes et les couvercles avant de mettre cet appareil sous tension.
- Maintenez les distances d'isolement électrique entre le câble et les pièces sous tension.

Si ces précautions ne sont pas respectées, cela entraînera la mort ou des blessures graves.

**TENSION PELIGROSA**

- Solamente el personal de mantenimiento eléctrico especializado deberá instalar y prestar servicios de mantenimiento a este equipo.
- Desenergice el equipo antes de realizar cualquier trabajo en él.
- Siempre utilice un dispositivo detector de tensión adecuado para confirmar la desenergización del equipo.
- Vuelva a colocar todos los dispositivos, las puertas y las cubiertas antes de energizar este equipo.
- Mantenga un espacio adecuado para la instalación eléctrica entre el cable y las piezas energizadas.

El incumplimiento de estas precauciones podrá causar la muerte o lesiones serias.

**USED WITH  
UTILISEES AVEC  
UTILIZACIÓN CON**

RDF30J-2	RDF60J-2-COMP	RDF60J-2	RDF100J-2	RDF200J-2
RDF30J-3	RDF60J-3-COMP	RDF60J-3	RDF100J-3	RDF200J-3
RDF30J-4	RDF60J-4-COMP	RDF60J-4	RDF100J-4	RDF200J-4

Dual dimensions in/mm  
Double dimensions in/mm  
Doble dimensiones in/mm

**FLC36  
FLC60  
FLC120**

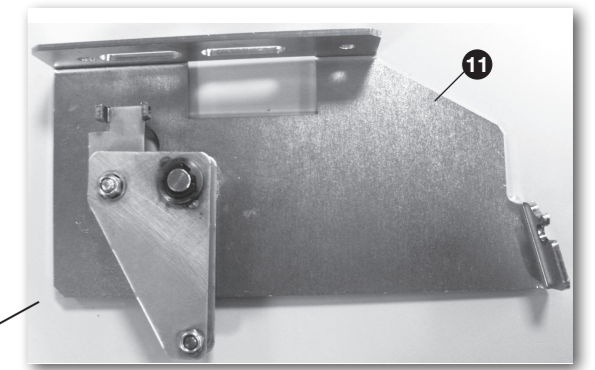

**FLCM**

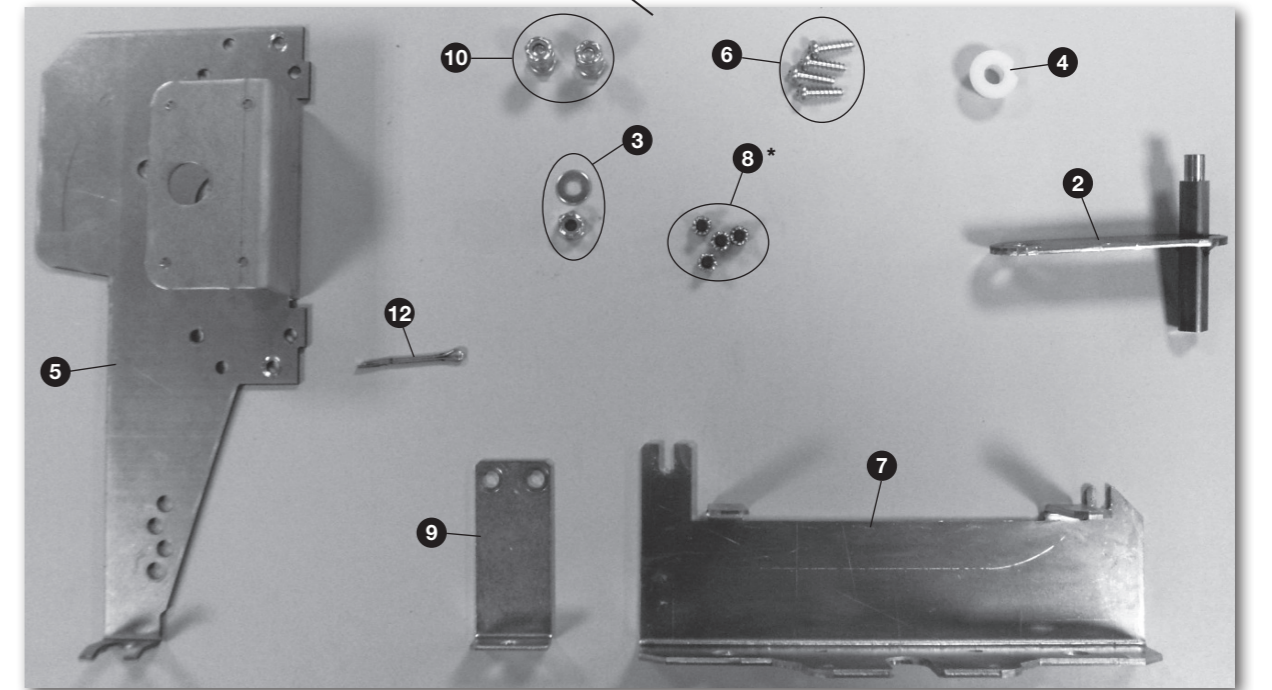

**STEP 1**

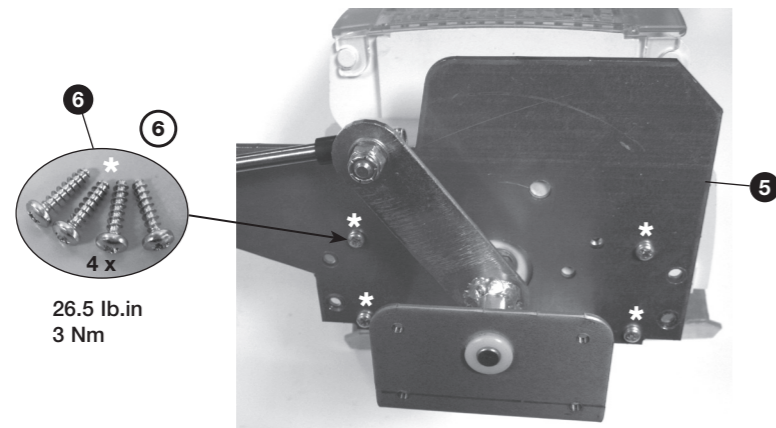
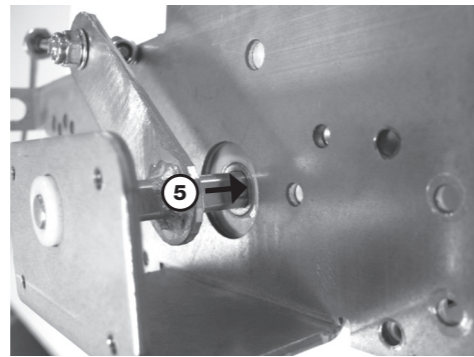
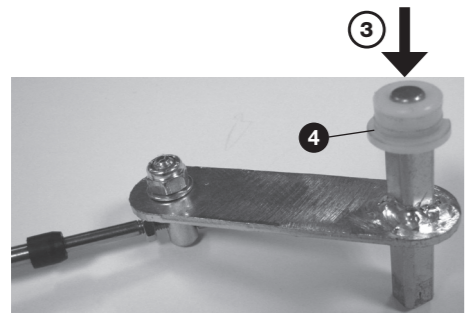
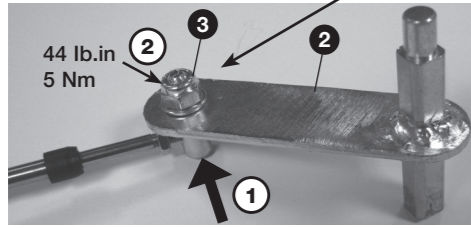
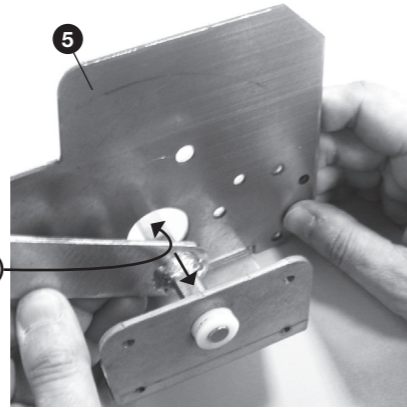
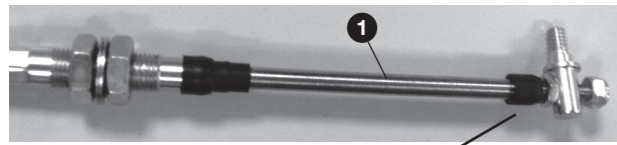

**STEP 2**

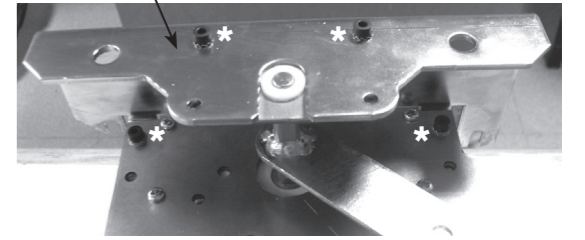
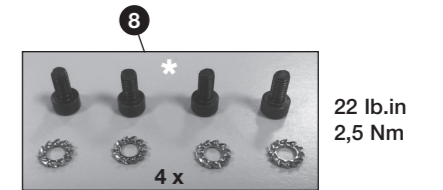
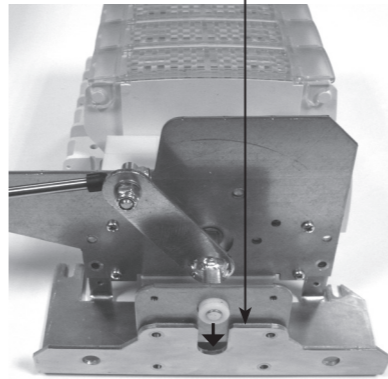
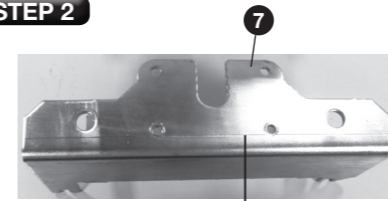

**STEP 3**

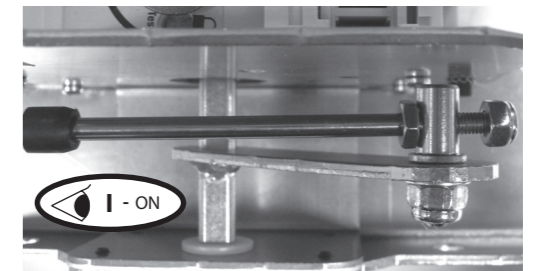
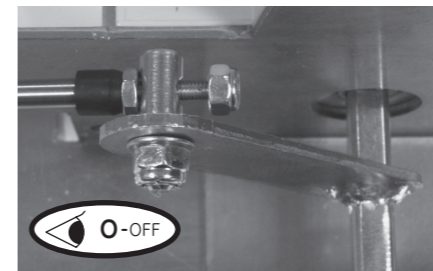
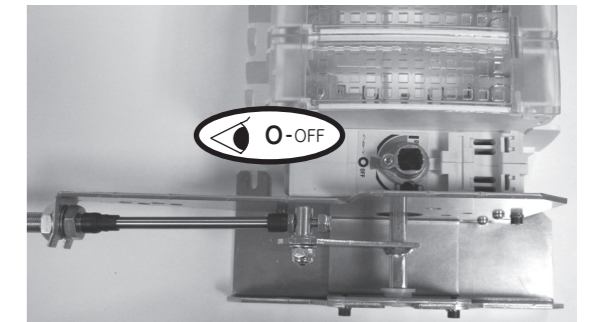
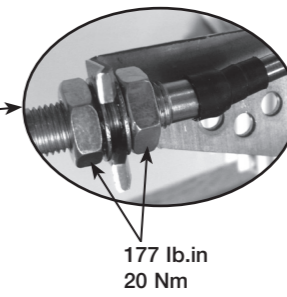
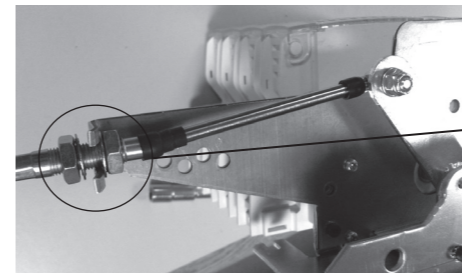

**STEP 4**

