

ADE-1F2 non-armored cable glands

IECEX/ATEX
NEMA 4X
IP66/IP68

1G

1G

ADE-1F2 cable glands are designed to provide a flameproof and weatherproof seal on the outer sheath of non-armored, tray, marine shipboard or Type P cable. ADE glands are available in a wide range of corrosion-resistant materials to suit any harsh, industrial application.

Cable types:

- Non-armored and tray cable – TC, TC-ER (HL)
- Marine shipboard cable; Type P cable



Standard materials:

- Nickel-plated brass for superior corrosion resistance
- 316L stainless steel, bronze and aluminum (optional); it is recommended that a suitable lubricant be used on all threads of stainless steel and aluminum versions

Ingress protection (IP):

- IP66/IP68 according to the method of attachment and the condition of the equipment area. IP66 protection is achieved through thread-to-thread engagement. Additional protection up to IP68 can be achieved through the addition of sealing washer or thread sealant.
- NEMA 4X

Certifications and compliances:



- Suitable for use in Class I, Division 2 hazardous locations when installed in accordance with NEC501.10(B)(4)

ATEX Certificate No.: INERIS12ATEX0032X

- Zones 1 & 2, Groups IIA, IIB, IIC
- Zones 21 & 22, Groups IIIA, IIIB, IIIC
- Ex II2GD / Ex db IIC / Ex eb IIC / Ex tb IIIC
- Ex II3G Ex nRc IIC

IECEX Certificate No.: IECEx INE 12.0025X

- Zones 1 & 2, Groups IIA, IIB, IIC
- Zones 21 & 22, Groups IIIA, IIIB, IIIC
- Ex db IIC / Ex eb IIC / Ex nRc IIC / Ex tb IIIC

UL certifications:

UL 3DJN E310130, Class I, Zone 1, AEx e II

- ADE sizes 3 to 8, 1/2" to 1 1/4" NPT or ISO 20 to 40 with TC-ER-HL non-armored cable up to 1" diameter

cULus LISTED 3DJN E310130, Class I, Zone 2, AEx e II, Ex e II

- ADE sizes 3 to 17, 1/2" to 4" NPT or ISO 20 to 110 with non-armored cable types ITC, MV, PLTC, TC-ER, TC-ER-HL, TC

UL LISTED 3LRC E314047, Class I, Zone 2, AEx e II, Ex e II

- ADE sizes 3 to 17, 1/2" to 4" NPT or ISO 20 to 110 with non-armored marine cable

Other certifications:

- CEPEL 05.0558X
- CCoE P360379-1
- KOSHA 2015-BO-0249 to 0256
- NANIO TC-RU C-FR. F605.B.00858
- NEPSI GYJ13.1082X
- SABS MS/15-0314X

Shipping application:

- ABS 14-HS1274083-PDA
- BV 40910/A0 BV
- DNV TAE000010X
- Lloyds 11/00072
- DTS-01:1991 compliant



Operating temperature:

- -60°C to +140°C

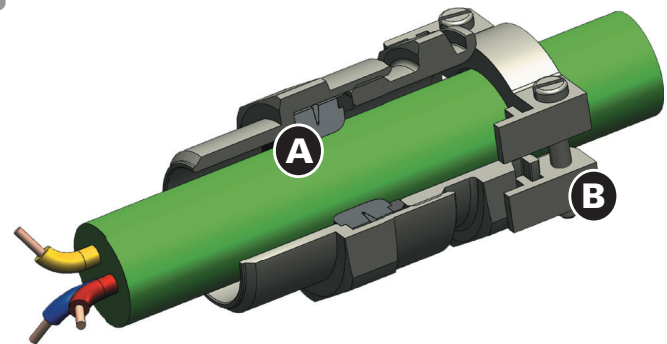

Features:

- Ⓐ **Specifically formulated elastomer** – used on the outer sheath of the cable to provide IP66 or IP68 moisture ingress protection
- Ⓑ **Optional external clamp** – provides additional external strain relief for rugged applications

Provides 25% of cable clamping. As per IEC60079 § A.2.3.2 for Group II or III cable glands, "Without a clamping device, additional clamping of the cable is needed to ensure that pulling and twisting is not transmitted to the terminations." We recommend using the certified ADE clamping module.

Ordering information:

Part number example
ADE1N0752NPNK1

ADE1

N075

2

NPN

K1

Hub size

NPT	Hub	Metric	Hub
N025	¼"	M12	12mm
N038	⅜"	M16	16mm
N050	½"	M20	20mm
N075	¾"	M25	25mm
N100	1"	M32	32mm
N125	1¼"	M40	40mm
N150	1½"	M50	50mm
N200	2"	M63	63mm
N250	2½"	M75	75mm
N300	3"	M90	90mm
N350	3½"	M110	110mm
N400	4"		

Cable sealing range

0	Extra small
1	Small
2	Medium
3	Large

Material

NPN	Nickel-plated brass
SSN	Stainless steel
BZN	Bronze
ALN	Aluminum

Accessory kits (see page 228)

BLANK	No kit
K1	Locknut, green composite washer
K2	Locknut, green composite washer, earth tag, shroud
K3	Locknut, green composite washer, earth tag, shroud, serrated washer

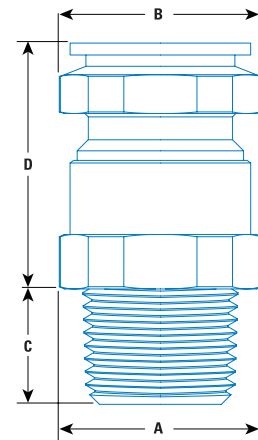

NPT thread size	Cat. # NPT	Metric thread size	Cat. # Metric	Cable sealing range			A and B	NPT threads (C)	Metric threads (C)	D	Gland size
				Min.	Max.	NPT max.					
1/4" ^A	ADE1N0253NPN	M12	ADE1M123NPN	0.18 (4.5)	0.31 (8.0)		0.67 (17.0)	0.65 (16.6)	0.59 (15.0)	0.98 (25.0)	4
3/8" ^A	ADE1N0382NPN	M16	ADE1M162NPN	0.18 (4.5)	0.33 (8.5)		0.67 (17.0)	0.65 (16.6)	0.59 (15.0)	0.98 (25.0)	4
3/8" ^A	ADE1N0383NPN	M16	ADE1M163NPN	0.28 (7.0)	0.47 (12.0)		0.75 (19.0)	0.65 (16.6)	0.59 (15.0)	1.08 (27.5)	5
1/2"	ADE1N0500NPN	M20	ADE1M200NPN	0.11 (2.8)	0.22 (5.5)		0.59 (15.0)	0.87 (22.2)	0.59 (15.0)	0.94 (24.0)	3
1/2"	ADE1N0501NPN	M20	ADE1M201NPN	0.18 (4.5)	0.33 (8.5)		0.67 (17.0)	0.87 (22.2)	0.59 (15.0)	0.98 (25.0)	4
1/2"	ADE1N0502NPN	M20	ADE1M202NPN	0.28 (7.0)	0.47 (12.0)		0.75 (19.0)	0.87 (22.2)	0.59 (15.0)	1.08 (27.5)	5
1/2"	ADE1N0503NPN	M20	ADE1M203NPN	0.39 (10.0)	0.63 (16.0)	0.61 (15.5)	0.94 (24.0)	0.87 (22.2)	0.59 (15.0)	1.26 (32.0)	6
3/4"	ADE1N0751NPN	M25	ADE1M251NPN	0.28 (7.0)	0.47 (12.0)		0.75 (19.0)	0.87 (22.2)	0.59 (15.0)	1.08 (27.5)	5
3/4"	ADE1N0752NPN	M25	ADE1M252NPN	0.39 (10.0)	0.63 (16.0)		0.94 (24.0)	0.87 (22.2)	0.59 (15.0)	1.26 (32.0)	6
3/4"	ADE1N0753NPN	M25	ADE1M253NPN	0.53 (13.5)	0.81 (20.5)		1.18 (30.0)	0.87 (22.2)	0.59 (15.0)	1.44 (36.5)	7
1"	ADE1N1003NPN	M32	ADE1M323NPN	0.71 (18.0)	1.08 (27.5)	1.02 (26.0)	1.61 (41.0)	1.07 (27.3)	0.59 (15.0)	1.81 (46.0)	8
1 1/4"	ADE1N1252NPN	M40	ADE1M402NPN	0.71 (18.0)	1.08 (27.5)	1.02 (26.0)	1.89 (48.0)	1.10 (28.0)	0.59 (15.0)	1.97 (50.0)	8
1 1/4"	ADE1N1253NPN	M40	ADE1M403NPN	0.91 (23.0)	1.34 (34.0)		1.89 (48.0)	1.10 (28.0)	0.59 (15.0)	1.97 (50.0)	9
1 1/2"	ADE1N1501NPN	M50	ADE1M501NPN	1.14 (29.0)	1.61 (41.0)		2.17 (55.0)	1.12 (28.5)	0.63 (16.0)	2.05 (52.0)	10
2"	ADE1N2002NPN	M50	ADE1M502NPN	1.38 (35.0)	1.77 (45.0)	1.89 (48.0)	2.52 (64.0)	1.15 (29.2)	0.63 (16.0)	2.22 (56.5)	11
2"	ADE1N2003NPN	M63	ADE1M633NPN	1.65 (42.0)	2.20 (56.0)	2.09 (53.0)	2.83 (72.0)	1.15 (29.2)	0.67 (17.0)	2.36 (60.0)	12
2 1/2"	ADE1N2503NPN	M75	ADE1M753NPN	1.97 (50.0)	2.56 (65.0)	2.46 (62.5)	3.35 (85.0)	1.67 (42.5)	0.71 (18.0)	2.66 (67.5)	13
3"	ADE1N3002NPN	M90	ADE1M902NPN	2.28 (58.0)	2.91 (74.0)		3.74 (95.0)	1.73 (44.0)	0.87 (22.0)	2.72 (69.0)	14
3"	ADE1N3003NPN	M90	ADE1M903NPN	2.60 (66.0)	3.27 (83.0)	3.07 (78.0)	4.33 (110.0)	1.73 (44.0)	0.87 (22.0)	3.15 (80.0)	15
3 1/2"	ADE1N3502NPN	M110	ADE1M1102NPN	2.95 (75.0)	3.66 (93.0)	3.62 (92.0)	4.72 (120.0)	1.78 (45.2)	0.87 (22.0)	3.15 (80.0)	16
4"	ADE1N4003NPN	M110	ADE1M1103NPN	3.35 (85.0)	4.09 (104.0)		5.31 (135.0)	1.83 (46.5)	0.87 (22.0)	3.54 (90.0)	17

Catalog numbers are for nickel-plated brass; refer to part number builder above for other options.

Dimensions shown in inches (millimeters).

^ANot UL certified.