

UNF, UNL, UNY, UNA unions and EL elbows

Cl. I, Div. 1 & 2, Groups A, B, C, D
 Cl. II, Div. 1, Groups E, F, G
 Cl. II, Div. 2, Groups F, G
 Cl. III

Explosionproof
 Dust-ignitionproof

4F
 4F

Applications:

UNY and UNF unions are installed in threaded thick wall conduit systems:

- UNY – to connect conduit to a conduit fitting, junction box or device enclosure
- UNF – to connect conduit to conduit, or to provide a means for future modification of the conduit system

UNA unions are used in conduit and fitting installations when entrance angle is between 90° and 180°.

EL elbows are installed in conduit run or in box or fitting hub:

- To change direction in threaded rigid conduit run by 90°, or when terminating at a box or fitting

Features:

UNY, UNF and UNL unions have:

- Compact design which permits assembly with a minimum of clearance to other adjacent conduit and/or equipment
- Strong and durable construction

UNA unions:

- Have a single clamping nut on angle, making it both a union and a connector
- Permit conduit joints at angles between 90° and 180°

EL elbows have a smooth interior and are both strong and compact.

Standard materials:

- UNY, UNF unions – 1/2" to 1" and 1 1/2": steel
- UNY, UNF unions – 1 1/4" to 6": Feraloy iron alloy
- UNL, UNA unions – Feraloy iron alloy
- EL elbows – Feraloy iron alloy or ductile iron

Standard finishes:

- Steel – electrogalvanized with chromate treatment
- Feraloy iron alloy, malleable iron – electrogalvanized and aluminum acrylic paint

Options:

- Description** **Suffix**
- Copper-free aluminum..... **SA**
Not available on UNA or 5" and 6" UNY/UNF

Certifications and compliances:

NEC/CEC:

EL 1/2", 3/4", 1"
UNF/UNY -105, -215, -205, -305
UNL -105, -125, -215, -205

- Class I, Divisions 1 & 2, Groups A, B, C, D
- Class II, Division 1, Groups E, F, G
- Class II, Division 2, Groups F, G
- Class III

UNF/UNY -406, -506, -606, -706, -806, -905, -1005

- Class I, Divisions 1 & 2, Groups B, C, D
- Class II, Division 1, Groups E, F, G
- Class II, Division 2, Groups F, G
- Class III

EL, UNF, UNL, UNY – All Sizes

- Class I, Divisions 1 & 2, Groups C, D
- Class II, Division 1, Groups E, F, G
- Class II, Division 2, Groups F, G
- Class III

UNA

- Class I, Divisions 1 & 2, Group D
- Class II, Division 1, Groups E, F, G
- Class II, Division 2, Groups F, G
- Class III

UL standard:

- UL1203

CSA standard:

- C22.2 No. 30

Ordering information:

UNY male



1/2" - 4"

UNF female



1/2" - 4"



5" - 6"



5" - 6"

| Hub size | Cat. # UNY | Hub size | Cat. # UNF |
|--------------------------|------------|--------------|------------|
| 1/2" | UNY105 | 1/2" | UNF105 |
| 1/2" female to 3/4" male | UNY215 | 3/4" to 1/2" | UNF215 |
| 3/4" | UNY205 | 3/4" | UNF205 |
| 1" | UNY305 | 1" | UNF305 |
| 1 1/4" | UNY405 | 1 1/4" | UNF405 |
| 1 1/2" | UNY406 | 1 1/2" | UNF406 |
| 1 1/2" | UNY505 | 1 1/2" | UNF505 |
| 1 1/2" | UNY506 | 1 1/2" | UNF506 |
| 2" | UNY605 | 2" | UNF605 |
| 2" | UNY606 | 2" | UNF606 |
| 2 1/2" | UNY705 | 2 1/2" | UNF705 |
| 2 1/2" | UNY706 | 2 1/2" | UNF706 |
| 3" | UNY805 | 3" | UNF805 |
| 3" | UNY806 | 3" | UNF806 |
| 3 1/2" | UNY905 | 3 1/2" | UNF905 |
| 4" ^B | UNY1005 | 4" | UNF1005 |
| 5" ^B | UNY012 | 5" | UNF012 |
| 6" ^B | UNY014 | 6" | UNF014 |

UNL 90° angle



| Hub size | Cat. # |
|--------------------------|--------|
| 1/2" to 1/2" | UNL105 |
| 3/4" female to 1/2" male | UNL125 |
| 1/2" female to 3/4" male | UNL215 |
| 3/4" to 3/4" | UNL205 |

^ASee Certifications and compliances section for classification of each product.

^BNot UL Listed.

UNF, UNL, UNY, UNA unions and EL elbows

Cl. I, Div. 1 & 2, Groups A, B, C, D ●
 Cl. II, Div. 1, Groups E, F, G
 Cl. II, Div. 2, Groups F, G
 Cl. III

Explosionproof
 Dust-ignitionproof

4F

Dimensions (in inches):

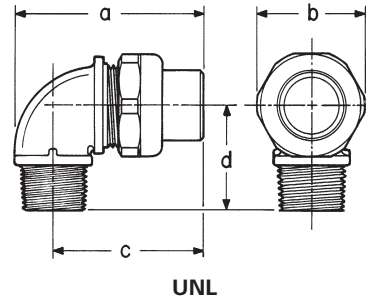
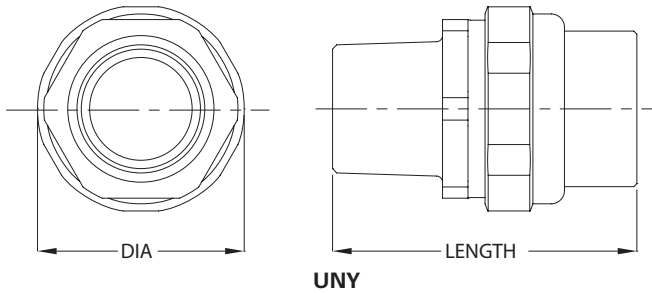

UNY/UNF

| Hub size | Material | UNY | | UNF | |
|-------------|----------|---------------------------------|---------------------------------|---------------------------------|---------------------------------|
| | | Length | Max. dia. | Length | Max. dia. |
| 1/2" | Iron | 2 ⁵ / ₈ | 1 ³ / ₁₆ | 1 ²⁷ / ₃₂ | 1 ³ / ₁₆ |
| 1/2" | Aluminum | 2 ⁵ / ₃₂ | 1 ¹ / ₂ | 1 ⁵ / ₈ | 1 ¹ / ₂ |
| 3/4" | Iron | 2 ¹¹ / ₁₆ | 1 ¹ / ₈ | 1 ³¹ / ₃₂ | 1 ¹ / ₈ |
| 3/4" | Aluminum | 2 ⁵ / ₈ | 1 ²⁵ / ₃₂ | 1 ²⁹ / ₃₂ | 1 ²⁵ / ₃₂ |
| 3/4" - 1/2" | Iron | 2 ⁵ / ₈ | 1 ¹ / ₈ | 1 ⁷ / ₈ | 1 ¹ / ₈ |
| 3/4" - 1/2" | Aluminum | 2 ⁵ / ₈ | 1 ¹ / ₈ | 1 ⁷ / ₈ | 1 ⁷ / ₈ |
| 1" | Iron | 3 | 2 ⁹ / ₁₆ | 2 ⁷ / ₃₂ | 2 ⁷ / ₁₆ |
| 1" | Aluminum | 3 | 2 ¹ / ₃₂ | 2 ³ / ₃₂ | 2 ¹ / ₃₂ |
| 1 1/4" | Iron | 3 ²³ / ₃₂ | 2 ¹⁵ / ₁₆ | 2 ¹ / ₄ | 2 ¹⁵ / ₁₆ |
| 1 1/4" | Aluminum | 3 ⁹ / ₈ | 2 ³ / ₄ | 2 ¹ / ₄ | 2 ³ / ₄ |
| 1 1/2" | Iron | 4 ⁷ / ₃₂ | 3 ¹ / ₁₆ | 2 ³ / ₄ | 3 ¹ / ₁₆ |
| 1 1/2" | Aluminum | 3 ³¹ / ₃₂ | 3 ¹ / ₁₆ | 2 ¹³ / ₃₂ | 3 ¹ / ₁₆ |
| 2" | Iron | 4 ⁷ / ₃₂ | 3 ⁷ / ₈ | 2 ¹¹ / ₁₆ | 3 ⁷ / ₈ |
| 2" | Aluminum | 4 ³ / ₃₂ | 3 ⁷ / ₈ | 2 ²¹ / ₃₂ | 3 ⁷ / ₈ |
| 2 1/2" | Iron | 5 ¹³ / ₃₂ | 4 ⁵ / ₃₂ | 3 ¹ / ₈ | 4 ⁵ / ₃₂ |
| 2 1/2" | Aluminum | 5 ¹ / ₃₂ | 4 ⁵ / ₈ | 3 ¹ / ₈ | 4 ⁵ / ₈ |
| 3" | Iron | 5 ¹³ / ₁₆ | 5 ¹ / ₁₆ | 3 ¹ / ₁₆ | 5 ¹ / ₁₆ |
| 3" | Aluminum | 5 ²⁵ / ₃₂ | 5 ⁵ / ₃₂ | 3 ¹ / ₁₆ | 5 ⁵ / ₃₂ |
| 3 1/2" | Iron | 6 ⁹ / ₁₆ | 5 ¹ / ₁₆ | 4 ¹ / ₈ | 5 ¹ / ₁₆ |
| 3 1/2" | Aluminum | 6 ¹⁵ / ₃₂ | 5 ⁵ / ₈ | 4 ¹ / ₈ | 5 ⁵ / ₈ |
| 4" | Iron | 6 ⁵ / ₈ | 6 ¹ / ₁₆ | 4 ¹ / ₈ | 6 ¹ / ₁₆ |
| 4" | Aluminum | 6 ¹⁵ / ₃₂ | 6 ¹ / ₁₆ | 4 ¹ / ₁₆ | 6 ¹ / ₁₆ |

UNL

| Dim. | 105 | 125 | 215 | 205 |
|------|---------------------------------|---------------------------------|---------------------------------|---------------------------------|
| a | 2 ¹¹ / ₁₆ | 2 ¹ / ₁₆ | 2 ⁷ / ₈ | 2 ⁷ / ₈ |
| b | 1 ¹⁷ / ₃₂ | 1 ¹³ / ₁₆ | 1 ¹³ / ₁₆ | 1 ¹³ / ₁₆ |
| c | 2 ¹ / ₁₆ | 2 ¹ / ₁₆ | 2 ¹ / ₄ | 2 ¹ / ₄ |
| d | 1 ⁷ / ₁₆ | 1 ⁷ / ₁₆ | 1 ⁵ / ₈ | 1 ⁵ / ₈ |

● See Certifications and compliances section for classification of each product.

UNF, UNL, UNY, UNA unions and EL elbows

Cl. I, Div. 1 & 2, Groups C, D
 Cl. II, Div. 1, Groups E, F, G
 Cl. II, Div. 2, Groups F, G
 Cl. III

Explosionproof
 Dust-ignitionproof

4F

Ordering information (continued):

UNA



Male
 (with removable nipple)

Male

| Hub size | Cat. # |
|----------|--------|
| 1/2" | UNA16 |
| 3/4" | UNA26 |
| 1" | UNA36 |

EL



90° male



90° female



45° female



90° male and female

90° male

| Hub size | Cat. # |
|----------|--------|
| 1/2" | EL195 |
| 3/4" | EL295 |
| 1" | EL395 |

45° female

| Hub size | Cat. # |
|----------|--------|
| 1/2" | EL1 |
| 3/4" | EL2 |
| 1" | EL3 |
| 1 1/4" | EL4 |
| 1 1/2" | EL5 |
| 2" | EL6 |
| 2 1/2" | EL7 |
| 3" | EL8 |
| 3 1/2" | EL9 |
| 4" | EL10 |

90° female

| Hub size | Cat. # |
|----------|--------|
| 1/2" | EL19E |
| 3/4" | EL29E |
| 1" | EL39E |
| 1 1/4" | EL49E |
| 1 1/2" | EL59E |
| 2" | EL69E |
| 2 1/2" | EL79 |

90° male and female

| Hub size | Cat. # |
|----------|--------|
| 1/2" | EL196E |
| 3/4" | EL296E |
| 1" | EL396E |
| 1 1/4" | EL496 |

Dimensions (in inches):

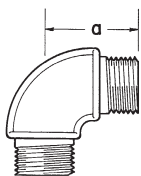

90° male

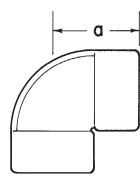

90° female

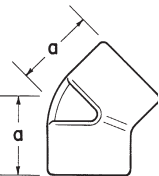

45° female

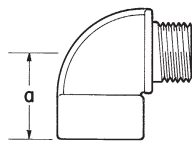

90° male and female

EL

UNA

Male

| Hub size | Length | Width |
|----------|---------------------------------|-------------------------------|
| 1/2" | 4 ⁵ / ₁₆ | 2 ⁵ / ₈ |
| 3/4" | 4 ¹³ / ₁₆ | 2 ⁷ / ₈ |
| 1" | 5 ¹¹ / ₁₆ | 3 ¹ / ₂ |

EL

| Hub size | 90° male and female | | | |
|----------|---------------------------------|--------------------------------|---------------------------------|---------------------------------|
| | 45° female | 90° male | 90° female | 90° male and female |
| a | a | a | a | |
| 1/2" | 1 ¹ / ₁₆ | 1 ¹ / ₁₆ | 1 ¹⁷ / ₃₂ | 1 ¹⁷ / ₃₂ |
| 3/4" | 1 ³ / ₈ | 1 ⁵ / ₈ | 1 ³ / ₄ | 1 ⁵ / ₈ |
| 1" | 1 ²¹ / ₃₂ | 1 ⁷ / ₈ | 2 | 1 ⁷ / ₈ |
| 1 1/4" | 1 ³ / ₄ | 2 ¹ / ₄ | 2 ¹ / ₈ | 2 ¹ / ₈ |
| 1 1/2" | 1 ¹⁵ / ₁₆ | 4 | 4 | 4 |
| 2" | 2 ¹ / ₄ | 5 | 5 | 5 |
| 2 1/2" | 2 ³ / ₄ | 6 ⁷ / ₁₆ | 6 ⁷ / ₁₆ | 6 ⁷ / ₁₆ |
| 3" | 3 ¹ / ₈ | 7 ¹ / ₈ | 7 ¹ / ₈ | 7 ¹ / ₈ |
| 3 1/2" | 3 ⁷ / ₁₆ | 8 ¹ / ₈ | 8 ¹ / ₈ | 8 ¹ / ₈ |
| 4" | 3 ⁷ / ₈ | 9 ¹ / ₈ | 9 ¹ / ₈ | 9 ¹ / ₈ |

Ⓧ See Certifications and compliances section for classification of each product.

Ⓧ Available in copper-free aluminum. To order, add suffix 'SA' to end of catalog number.

UNY and UNF unions – stainless steel

Cl. I, Div. 1 & 2, Groups A, B, C, D
 Cl. II, Div. 1, Groups E, F, G
 Cl. II, Div. 2, Groups F, G
 Cl. III

Explosionproof
 Dust-ignitionproof

Applications:

UNY and UNF unions are installed in threaded thick wall conduit systems:

- UNY – to connect conduit to a conduit fitting, junction box or device enclosure
- UNF – to connect conduit to conduit, or to provide a means for future modification of the conduit system

Features:

UNY and UNF unions have:

- Compact design which permits assembly with a minimum of clearance to other adjacent conduit and/or equipment
- Strong and durable construction

Stainless steel benefits:

- Self-healing properties help reduce the penetration of rust/corrosion and eliminate damage to the fitting
- Retain strength in extreme heat and extreme cold conditions
- Surface is easy to maintain and keep clean
- Easy cleaning capabilities make these fittings perfect for food processing and other hygienic areas where wash downs are common
- Superior strength and durability greatly reduce replacement – this will lower your total cost of ownership and increase your return on investment
- Do not require harsh environment-damaging cleaners to keep them looking like new

Ordering information:

| Hub size | Cat. # UNY | Hub size | Cat. # UNF |
|-----------------------------|---------------|--------------|---------------|
| 1/2" | UNY105 SS | 1/2" | UNF105 SS |
| 1/2" female to 3/4" male | UNY215 SS | 3/4" to 1/2" | UNF215 SS |
| 3/4" | UNY205 SS | 3/4" | UNF205 SS |
| 1" | UNY305 SS | 1" | UNF305 SS |

Certifications and compliances:

NEC/CEC:

- Class I, Divisions 1 & 2, Groups A, B, C, D
- Class II, Division 1, Groups E, F, G
- Class II, Division 2, Groups F, G
- Class III

UL standard:

- UL1203

CSA standard:

- C22.2 No. 30

Standard material:

- 316 stainless steel

Standard finish:

- Passivated



UNY



UNF

Dimensions (in inches):

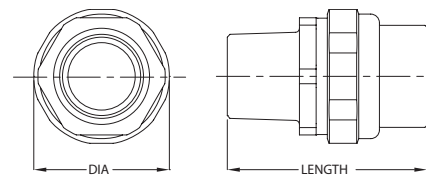

UNY

| Hub size | UNY | | UNF | |
|-------------|--------------------------------|---------------------------------|---------------------------------|---------------------------------|
| | Length | Max. dia. | Length | Max. dia. |
| 1/2" | 2 ⁵ / ₃₂ | 1 1/2 | 1 ⁵ / ₈ | 1 1/2 |
| 3/4" | 2 ⁷ / ₈ | 1 ²⁵ / ₃₂ | 1 ²⁵ / ₃₂ | 1 ²⁵ / ₃₂ |
| 3/4" - 1/2" | 2 ⁵ / ₈ | 1 7/8 | 1 7/8 | 1 7/8 |
| 1" | 3 | 2 1/32 | 2 1/32 | 2 1/32 |