

# Liquidtight fittings

## Non-metallic liquidtight conduit fittings

### Applications:

- For use with non-metallic Type B liquidtight conduit to terminate and seal conduit to liquidtight, oiltight or raintight box or enclosure

### Features:

- Liquidtight, raintight, oiltight for protection and long life in wet, dusty and corrosive environments
- Hex shaped gland nut allows for easy wrenching, providing a fast, tight installation
- Suitable for wet locations
- Reusable, long ferrule prevents pull-out and tight bend conduit pop-out
- Furnished with locknut and sealing ring
- Third party certified
- Available in straight and 90 degree configurations
- Available in sizes 3/8" to 2"
- Available in black or gray color

### Certifications and compliances:

- UL Listed liquidtight flexible non-metallic conduit fittings are suitable for use in the following hazardous locations under NEC:
  - Class I, Division 2;
  - Class II, Divisions 1 & 2; and
  - Class III, Divisions 1 & 2;
- Suitable for grounding in sizes 3/8" through 1 1/4" under NEC
- UL Standards 514B, 467
- cUL Standard C22.2 No. 18F
- UL File No. E-19189



### Standard materials:

- Body – straight: nylon  
90°: nylon
- Ferrule – steel
- Gland nut sealing ring – nylon
- Sealing gasket – polypropylene
- Locknut – steel

### Standard finishes:

- Nylon – natural
- Steel – natural

Liquidtight

### Straight connectors – non-metallic

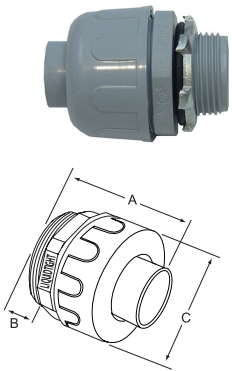

Trade size	Cat. # Gray	Cat. # Black	Unit qty.	Wt. lbs. per 100	A	B	C
3/8"	LT38NM	LT38NMBL	25	5	2.000	0.540	1.400
1/2"	LT50NM	LT50NMBL	25	5	2.000	0.540	1.400
3/4"	LT75NM	LT75NMBL	10	7	2.200	0.640	1.700
1"	LT100NM	LT100NMBL	5	14	2.280	0.740	2.000
1 1/4"	LT125NM	LT125NMBL	5	20	2.440	0.760	2.400
1 1/2"	LT150NM	LT150NMBL	2	30	2.700	0.800	2.670
2"	LT200NM	LT200NMBL	2	40	2.990	0.850	3.280

### 90° angle connectors – non-metallic

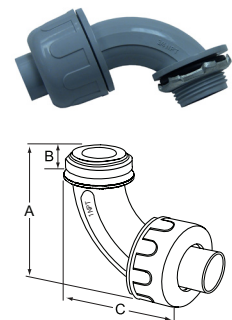

Trade size	Cat. # Gray	Cat. # Black	Unit qty.	Wt. lbs. per 100	A	B	C
3/8"	LT3890NM	LT3890NMBL	10	5	2.120	0.540	3.120
1/2"	LT5090NM	LT5090NMBL	10	5	2.120	0.540	3.120
3/4"	LT7590NM	LT7590NMBL	10	10	2.500	0.520	3.600
1"	LT10090NM	LT10090NMBL	5	16	3.130	0.700	4.130
1 1/4"	LT12590NM	LT12590NMBL	5	28	4.450	0.760	5.200
1 1/2"	LT15090NM	LT15090NMBL	2	40	4.750	0.800	5.200
2"	LT20090NM	LT20090NMBL	2	50	5.420	0.860	5.800

# Liquidtight fittings

## Non-metallic liquidtight conduit fittings

### MULTI-ANGLE CONNECTORS

#### Features:

- Swivel design can change from a 0 degree to a 90 degree angle
- No disassembly required
- Eliminate inventory by using the swivel design as a straight or 90 degree connector

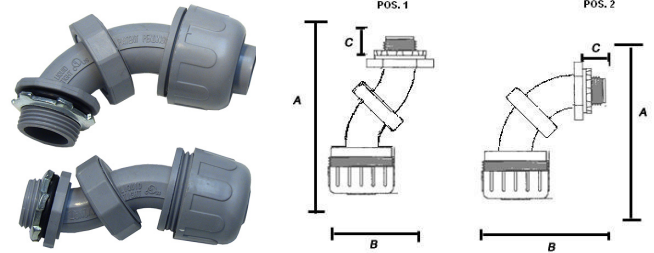

Cat. #	Trade size	Unit qty.	Certification	Wt. lbs. per 100	A	B	C
LT50U90NM	1/2"	10	cULus	10	Pos. 1 = 3.350"/ Pos. 2 = 3.025"	Pos. 1 = 2.150"/ Pos. 2 = 2.395"	Pos. 1 = 0.500"/ Pos. 2 = 0.500"
LT75U90NM	3/4"	10	cULus	15	Pos. 1 = 4.300"/ Pos. 2 = 3.850"	Pos. 1 = 2.650"/ Pos. 2 = 3.350"	Pos. 1 = 0.520"/ Pos. 2 = 0.520"

### SCREW-IN CONNECTORS

#### Features:

- Unique one-piece design
- Design allows for excellent liquidtight seal and optimum pull strength without compression nut

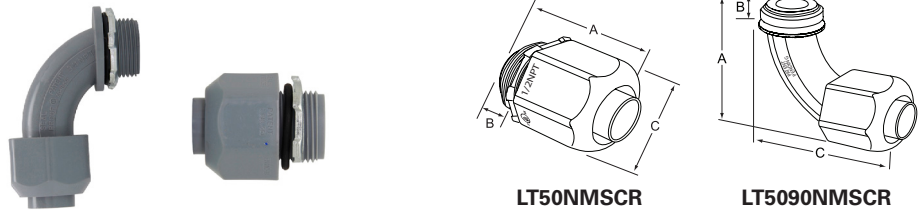

Cat. #	Trade size	Unit qty.	Wt. lbs. per 100	A	B	C
<b>Straight Connectors</b>						
LT50NMSCR	1/2"	25	5	1.750"	0.500"	1.250"
LT75NMSCR	3/4"	25	7	1.800"	0.625"	1.500"
<b>90 Degree Angle Connectors</b>						
LT5090NMSCR	1/2"	10	7	1.875"	0.500"	3.125"
LT7590NMSCR	3/4"	10	9	2.375"	0.625"	3.500"

### LIQUIDTIGHT WHIPS

#### Features:

- Available in 1/2" and 3/4" conduit sizes
- 4 ft. and 6 ft. lengths
- Easy installation
- Assembled with all UL components
- Resists corrosion, oil and water
- 1/2" filled with three #10 AWG THHN copper stranded wires
- 3/4" filled with one #10 AWG THHN copper stranded wire and two #8 AWG THHN copper stranded wires



LTWHP50NM4

Cat. #	Trade size	Unit qty.	Wt. lbs. per 100
<b>4 ft.</b>			
LTWHP50NM4	1/2"	24	138
LTWHP75NM4	3/4"	24	188
<b>6 ft.</b>			
LTWHP50NM6	1/2"	24	196
LTWHP75NM6	3/4"	12	267

# Liquidtight fittings

## Non-metallic liquidtight conduit fittings

### UL TYPE B FLEXIBLE, NON-METALLIC LIQUIDTIGHT CONDUIT

#### Applications:

- For use with non-metallic liquidtight fittings to terminate and seal conduit to liquidtight, oiltight or raintight box or enclosure
- Typical applications include wiring motors, transformers, processing equipment, pumps, etc.

#### Features:

- Resists abrasion, oil, water, acid and metal shavings
- Smooth inside for easier wire pulling; no hazardous sharp edges or burrs; will not damage conductors
- Corrosion-resistant for tough environmental conditions
- Suitable for wet locations
- Quick installation; cuts with utility knife or PVC cutter
- 90° has smooth interior to prevent abrasion of conductors
- Rated for 80°C dry; 60°C wet; 70°C oil-resistant

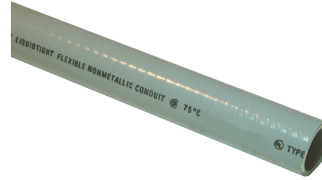

LTCOND38NM100 - GRAY



LTCOND38NMBL100 - BLACK

#### Standard material:

- Integral rigid and flexible PVC construction

#### Certifications and compliances:

- UL Listed
- CSA certified



Cat. # Type B 80°C dry 60°C wet 70°C - gray	Cat. # Type B 105°C dry 60°C wet 70°C - black	Trade size	Wt. lbs. per 100 Ft.	Coil/ reel size	O.D. min. - max.	I.D. min. - max.
LTCOND38NM100	LTCOND38NMBL100	3/8"	13	100 ft.	0.690 - 0.710"	0.484 - 0.504"
LTCOND50NM100	LTCOND50NMBL100	1/2"	15	100 ft.	0.820 - 0.840"	0.622 - 0.642"
LTCOND75NM100	LTCOND75NMBL100	3/4"	20	100 ft.	1.030 - 1.050"	0.820 - 0.840"
LTCOND100NM100	LTCOND100NMBL100	1"	27	100 ft.	1.290 - 1.315"	1.041 - 1.066"
LTCOND125NM100	LTCOND125NMBL100	1 1/4"	35	100 ft.	1.630 - 1.660"	1.380 - 1.410"
LTCOND150NM50	LTCOND150NMBL50	1 1/2"	46	50 ft.	1.865 - 1.900"	1.575 - 1.600"
LTCOND200NM50	LTCOND200NMBL50	2"	66	50 ft.	2.340 - 2.375"	2.020 - 2.045"
LTCOND38NM1200		3/8"	14	1200 ft.	0.690 - 0.710"	0.484 - 0.504"
LTCOND50NM1000		1/2"	17	1000 ft.	0.820 - 0.840"	0.622 - 0.642"
LTCOND75NM800		3/4"	22	800 ft.	1.030 - 1.050"	0.820 - 0.840"
LTCOND100NM500		1"	30	500 ft.	1.290 - 1.315"	1.041 - 1.066"

## NON-METALLIC LIQUIDTIGHT ELECTRICAL TUBING

#### Features:

- Quick installation; cuts with utility knife or PVC cutter
- Suitable for use in high vibration or flexing applications
- Resists corrosion, oil and water
- Maximum flexibility; can be used in extremely tight areas
- Resists abuse, pulling and crushing



ET25NM100

#### Certifications and compliances:

- UL Listed
- CSA certified



Cat. #	Trade size	Wt. lbs. per 100 ft.	Coil/ reel size	O.D. min. - max.	I.D. min. - max.
ET25NM100 <sup>W</sup>	1/4"	8	100 ft.	0.560 - 0.575"	0.385 - 0.405"
ET38NM100	3/8"	9	100 ft.	0.690 - 0.710"	0.484 - 0.504"
ET50NM100	1/2"	10	100 ft.	0.820 - 0.840"	0.622 - 0.642"
ET75NM100	3/4"	14	100 ft.	1.030 - 1.050"	0.820 - 0.840"
ET100NM100	1"	19	100 ft.	1.290 - 1.315"	1.041 - 1.066"
ET125NM100	1 1/4"	22	100 ft.	1.630 - 1.660"	1.380 - 1.410"
ET150NM50	1 1/2"	28	50 ft.	1.865 - 1.900"	1.575 - 1.600"
ET200NM50	2"	42	50 ft.	2.340 - 2.375"	2.020 - 2.045"

<sup>W</sup>Not CSA certified.