

Conduit hubs

CONDUIT HUBS – MALLEABLE IRON

Applications:

- Ideal for terminating electrical conduit through the walls of enclosures
- Designed for use indoors or outdoors with rigid conduit and IMC; specific applications include: food processing plants, distilleries, breweries, sewage disposal plants, chemical plants, paper processing mills and refineries

Features:

- Male thread type
- Tapered female thread for rigid conduit and IMC
- Recessed o-ring gasket assures raintight and secure environmental connections
- Insulated throat provides smooth pulling surface
- Locking screw on the nut doubles as a grounding screw for added safety
- Complete size range from 1/2" to 6"
- Hubs fit standard knockouts; no special tools required

Certifications and compliances:

- UL Standard 514B
- cUL Listed – Certified by UL to CSA Standard C22.2 No. 18
- NEMA: FB-1
- Suitable for wet locations
- RoHS compliant



Standard material and finish:

- Material – malleable iron
- Finish – zinc electroplate

Options:

- | | |
|---------------------------------|---------------|
| Description | Suffix |
| • Mechanically galvanized | HDG |

Cat. #	Size	Unit qty.	Wt. lbs. per 100	A	B	C
MHUB1	1/2"	25	18	1.35	1.53	1.45
MHUB2	3/4"	25	25	1.62	1.84	1.51
MHUB3	1"	5	50	1.81	2.06	1.79
MHUB4	1 1/4"	5	25	2.32	2.62	2.02
MHUB5	1 1/2"	2	20	2.76	3.13	2.05
MHUB6	2"	1	10	3.15	3.58	2.14
MHUB7	2 1/2"	1	10	3.69	4.18	2.91
MHUB8	3"	1	5	4.44	5.05	3.15
MHUB9	3 1/2"	1	5	5.11	5.82	3.21
MHUB10	4"	1	2	5.47	6.24	3.40
MHUB11	5"	1	1	6.85	7.79	3.60
MHUB12	6"	1	1	7.83	8.92	3.78

Dimensions (in inches):

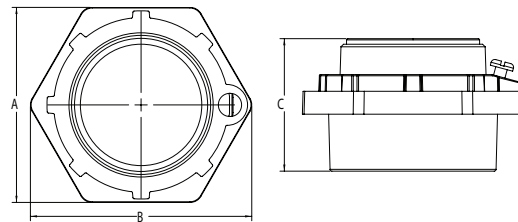

Conduit hubs

Hot Dip Galvanized Products

Conduit hubs

CONDUIT HUBS – MECHANICALLY GALVANIZED MALLEABLE IRON

Applications:

- Ideal for terminating electrical conduit through the walls of enclosures
- Designed for use indoors or outdoors with rigid conduit and IMC, specific applications include food processing plants, distilleries, breweries, sewage disposal plants, chemical plants, paper processing mills and refineries

Features:

- Male thread type
- Tapered female thread for rigid conduit and IMC
- Recessed o-ring gasket assures raintight and secure environmental connections
- Insulated throat provides smooth pulling surface
- Locking screw on the nut doubles as a grounding screw for added safety
- Complete size range from 1/2" to 6"
- Hubs fit standard knockouts; no special tools required

Certifications and compliances:

- UL Standard 514B
- UL Listed – Certified by UL to CSA Standard C22.2 No. 18
- NEMA: FB-1
- Suitable for wet locations



Standard material:

- Malleable iron

Standard finish:

- Mechanically galvanized

Cat. #	Size	Unit qty.	Wt. lbs. per 100
MHUB1 HDG	1/2"	25	18
MHUB2 HDG	3/4"	25	25
MHUB3 HDG	1"	5	50
MHUB4 HDG	1 1/4"	5	25
MHUB5 HDG	1 1/2"	2	20
MHUB6 HDG	2"	1	10
MHUB7 HDG	2 1/2"	1	10
MHUB8 HDG	3"	1	5
MHUB9 HDG	3 1/2"	1	5
MHUB10 HDG	4"	1	2
MHUB11 HDG	5"	1	1
MHUB12 HDG	6"	1	1

Hot dip
galvanized

Conduit hubs

CONDUIT HUBS – IRON SPACE-SAVER

Applications:

- Ideal for terminating rigid/IMC conduit through the walls of enclosures
- Designed for use indoors or outdoors with rigid and IMC conduit; specific applications include: food processing plants, distilleries, breweries, sewage disposal plants, chemical plants, paper processing mills and refineries



Features:

- Male thread is on the nut for a low profile, space saving fit
- Quick and easy when installing rigid conduit nipple between two existing enclosures
- Insulated throat provides smooth pulling surface
- Furnished with SG sealing gasket
- Hub fits standard knockouts; no special tools required

Standard materials:

- Body and nut – malleable iron
- Sealing ring – steel and rubber

Standard finishes:

- Body and nut – zinc electroplate
- Sealing ring – natural

Certifications and compliances:

- UL and cUL Listed, File No. E-19189
- UL Standard 514B
- Certified by UL to CSA Standard C22.2 No. 18
- Suitable for wet locations



Conduit hubs

Cat. #	Size	Unit qty.	Wt. lbs. per 100	A	B
HUB1	1/2"	25	18	1.49	1.30
HUB2	3/4"	10	25	1.44	1.54
HUB3	1"	5	50	1.57	1.78
HUB4	1 1/4"	5	25	1.98	2.16
HUB5	1 1/2"	2	20	2.00	2.37
HUB6	2"	1	10	2.19	2.93
HUB7	2 1/2"	1	10	2.61	3.56
HUB8	3"	1	5	2.81	4.18
HUB9	3 1/2"	1	5	3.02	4.64
HUB10	4"	1	2	3.65	5.21

Dimensions (in inches):

