

8 7 6 5 4 3 2 1

D  
C  
B  
A

D  
C  
B  
A

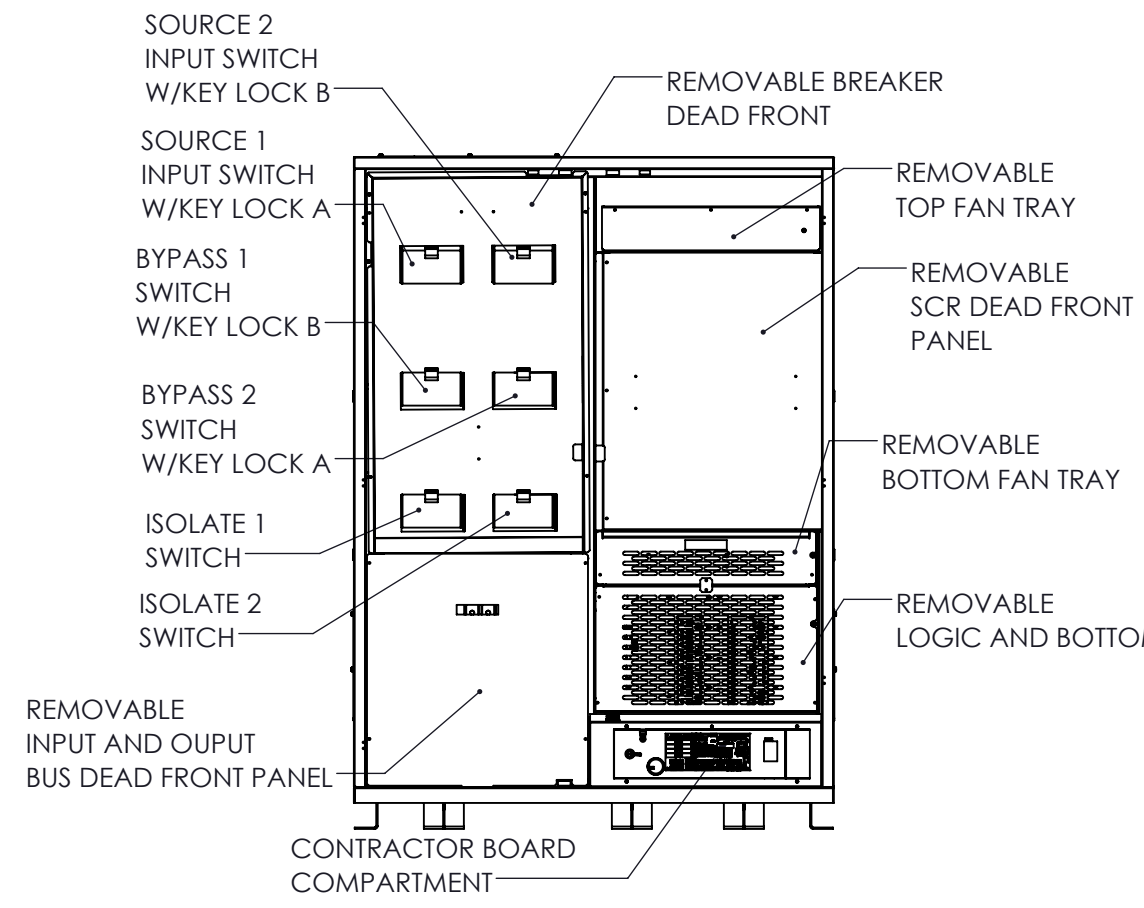

VIEW WITHOUT FRONT DOORS

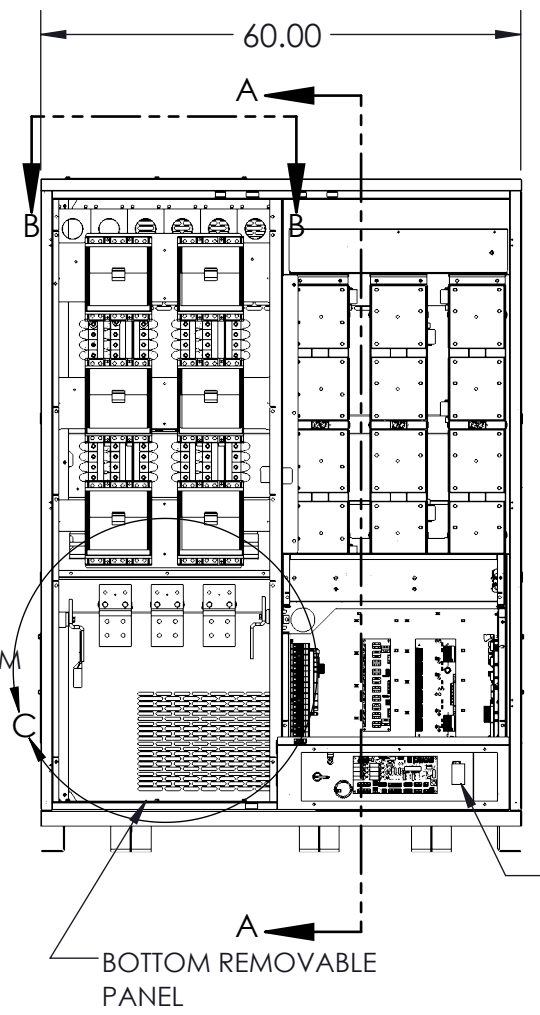

VIEW WITHOUT FRONT DOORS AND DEAD FRONT

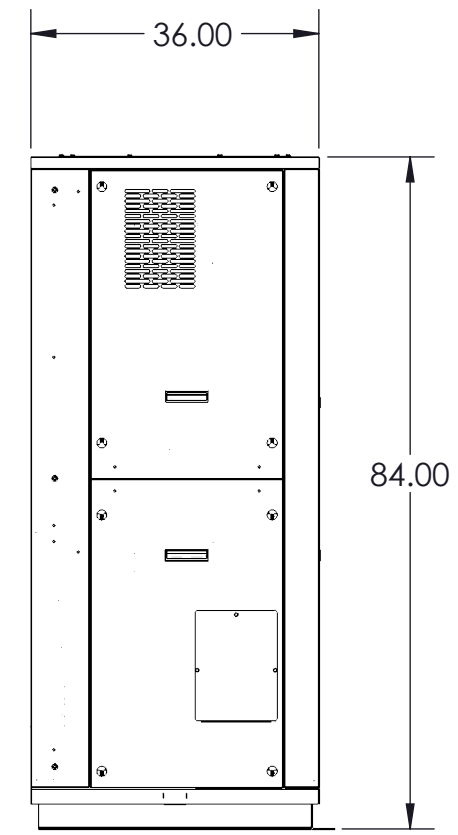

CONTRACTOR BOARD ACCESS PANEL

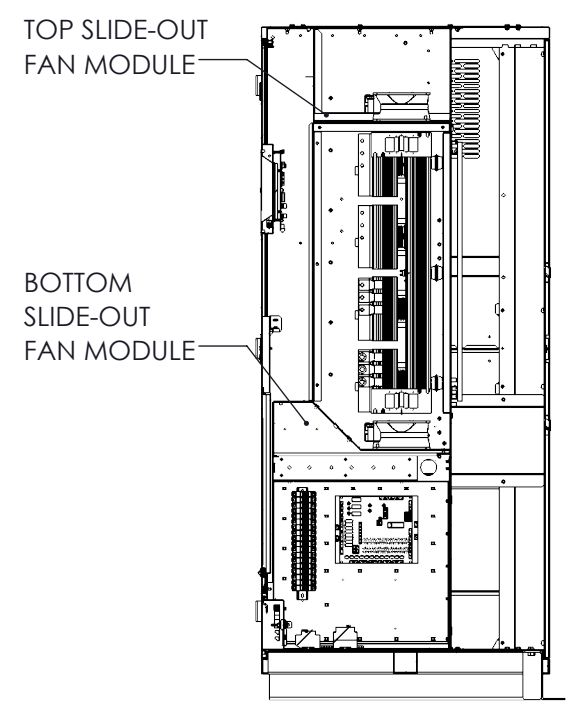

SECTION A-A

GENERAL SPECIFIED CABINET CHARACTERISTIC:  
 ENCLOSURE : NEMA 1  
 LOCATION : INDOOR  
 MECHANICAL:  
 MOUNTING: BOLT TO CONCRETE FLOOR OR FLOOR STAND  
 MATERIAL: STEEL  
 WEIGHT : 2000 LBS. APPROX.  
 FRONT ACCESS FOR INSTALLATION AND MAINTENANCE  
 ALL OPERATOR CONTROLS ARE FRONT ACCESS WITHOUT EXPOSURE TO LIVE PARTS  
 MINIMUM 6" FOR SIDE AND REAR FOR VENTILATION

UNLESS OTHERWISE SPECIFIED:  
 DIMENSIONS ARE IN INCHES  
 [ ] IN MILLIMETER  
 ANGULAR: ±0.5° BEND ±1°  
 TWO PLACE DECIMAL ±0.02  
 THREE PLACE DECIMAL ±0.005

THIS DRAWING CONTAINS CONFIDENTIAL & PROPRIETARY INFORMATION AND SHALL NOT BE DISCLOSED OR COPIED WITHOUT THE EXPRESSED, WRITTEN PERMISSION OF SMITHS POWER



THIRD ANGLE PROJECTION		DO NOT SCALE DRAWING	
APPROVALS		DATE	
DRAWN	FI	1/24/2018	
CHECKED			
ENG. APPR.	AW	1/24/2018	

TITLE: TFA STS OUTLINE DRAWING 800A - 1200A TFA STS BOTTOM ENTRY/EXIT		
SIZE B	DWG. NO. STS66987	REV B
PART NO.		SHEET 1 OF 5

8 7 6 5 4 3 2 1

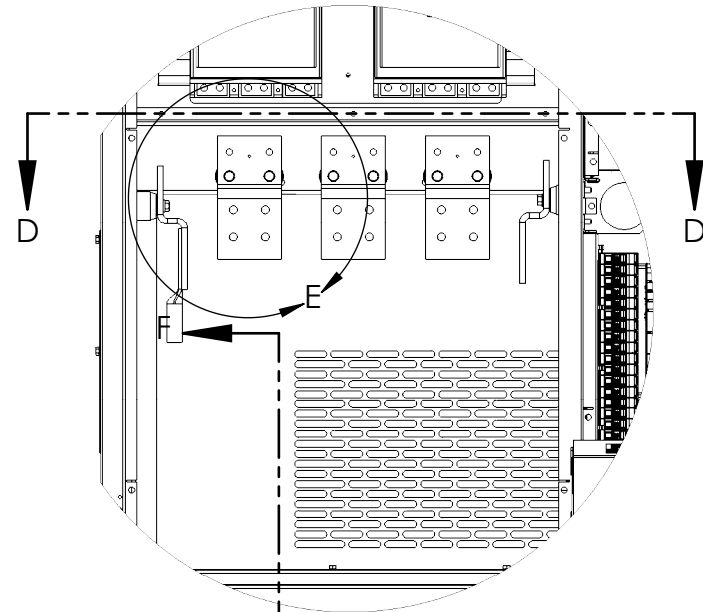

DETAIL C  
SCALE 1 : 12

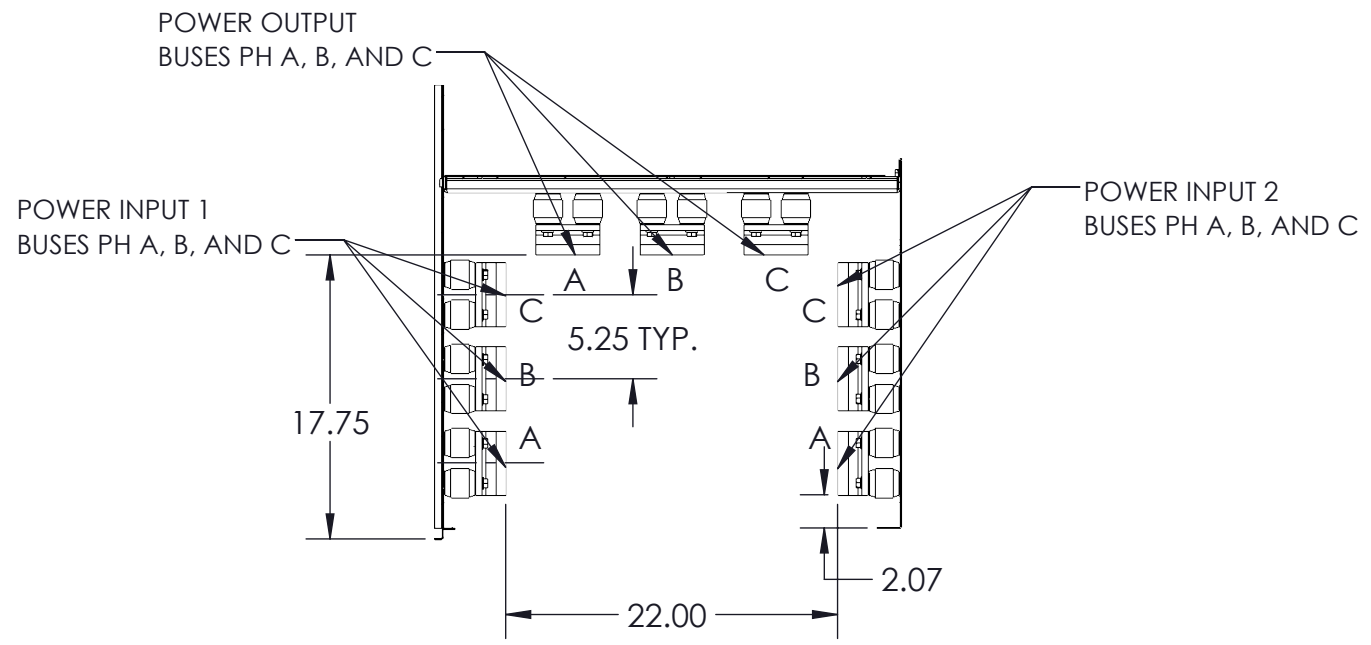

SECTION D-D  
SCALE 1 : 12

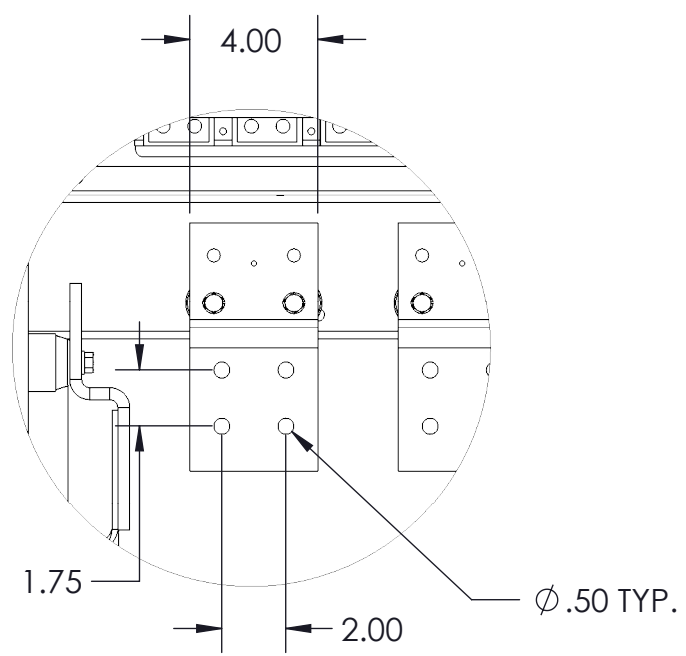

DETAIL E  
SCALE 1 : 6

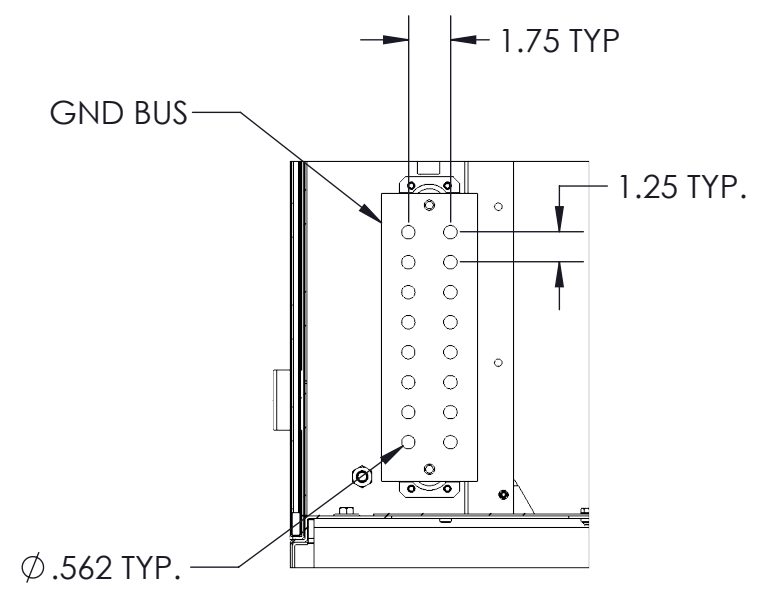

SECTION F-F  
SCALE 1 : 8

SIZE <b>B</b>	DWG. NO. <b>STS66987</b>	REV <b>B</b>
SCALE: NTS		SHEET 2 OF 5

8 7 6 5 4 3 2 1

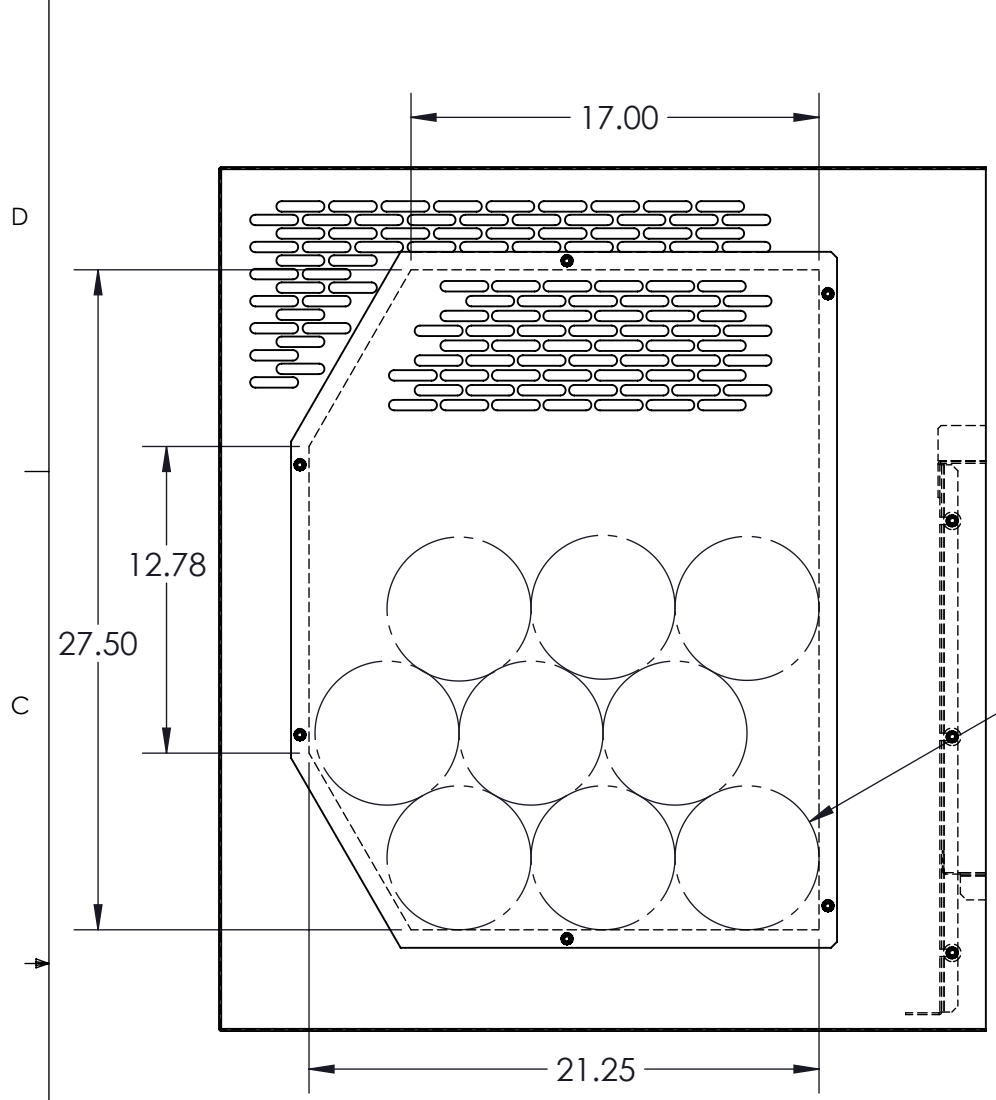

SECTION B-B  
SCALE 1 : 8  
**BOTTOM KNOCK-OUT AREA**

Ø 6.0  
4" CONDUIT SPACE

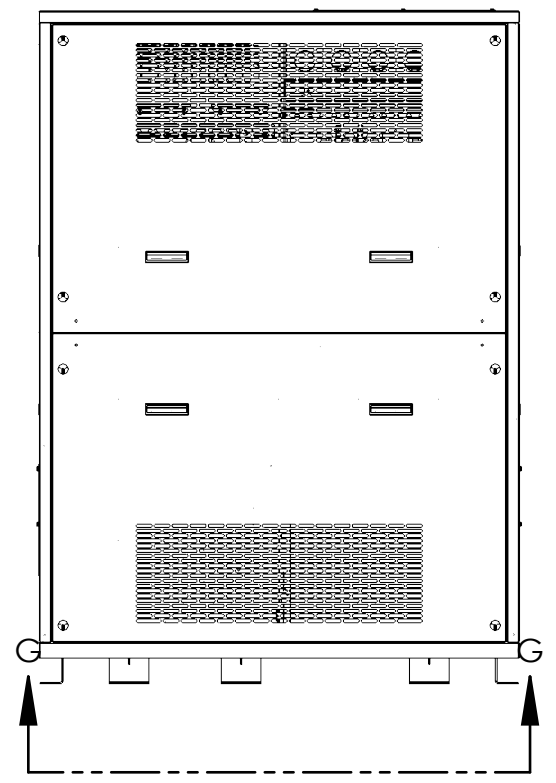

OPTIONAL TFA MOUNT BRACKET (2X)  
2.50  
37.50  
14.00  
2X .63 X 1.750  
REAR CHASSIS MOUNT HOLE (2X)  
31.25  
34.34  
Ø .75  
58.00  
2.38 FROM FRONT OF STS

SECTION G-G  
SCALE 1 : 24

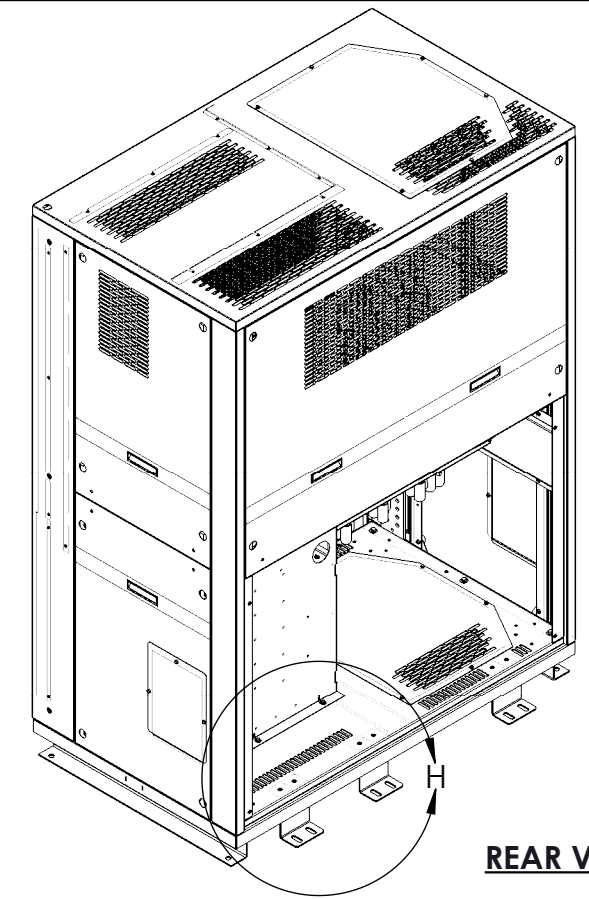

**REAR VIEW**

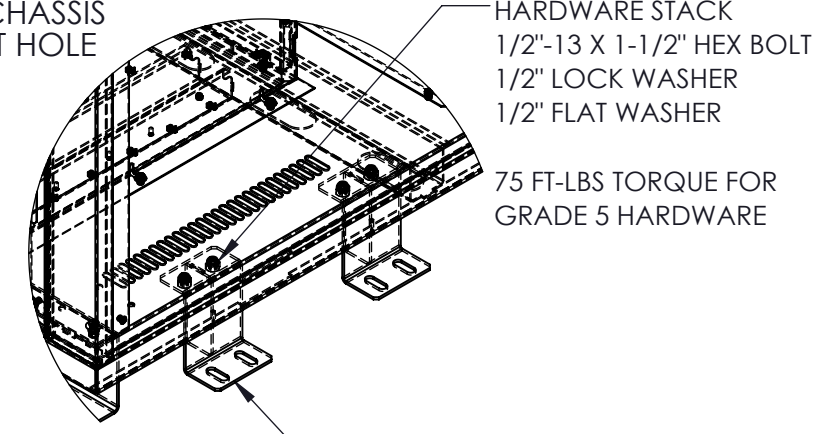

DETAIL H  
SCALE 1 : 12

**OPTIONAL TFA MOUNTING BRACKET**

HARDWARE STACK  
1/2"-13 X 1-1/2" HEX BOLT  
1/2" LOCK WASHER  
1/2" FLAT WASHER  
75 FT-LBS TORQUE FOR GRADE 5 HARDWARE

TFA MOUNTING BRACKETS  
MOUNT BRACKETS PRIOR TO PLACING UNIT

CONDUCTOR RECOMMENDATION:

CONDUCTOR BASED ON 90DEG C CABLE AT 40DEG C AMBIENT TEMPERTURE REFER TO UL, NEC OR AUTHORITY HAVING JURISDICTION (AHJ) FOR APPROPRIATE CONDUCTOR SIZE.

STS AMPERAGE	CU CONDUCTOR PER PHASE	MIN. # OF CONDUIT	AL CONDUCTOR PER PHASE	MIN. # OF CONDUIT
800A	2-600 MCM	3	3-400 MCM	5
	3-300 MCM	3		
	4-3/0 AWG	2		
1000A	3-400 MCM	3	3-600 MCM	9
	4-250 MCM	3	4-350 MCM	6
1200A	3-600 MCM	5	4-500 MCM	6
	4-350 MCM	4		

SIZE <b>B</b>	DWG. NO. <b>STS66987</b>	REV <b>B</b>
SCALE: NTS		SHEET 3 OF 5

8 7 6 5 4 3 2 1

8 7 6 5 4 3 2 1

D  
C  
B  
A

D  
C  
B  
A

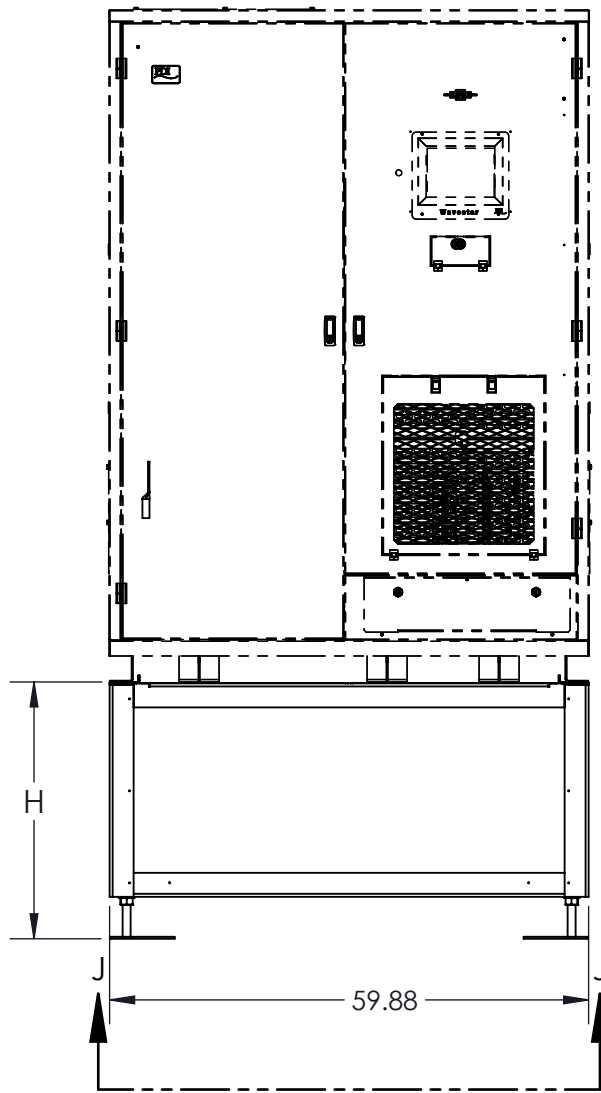

REMOVABLE  
PANELS

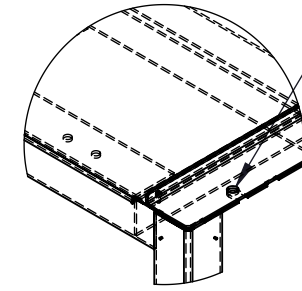
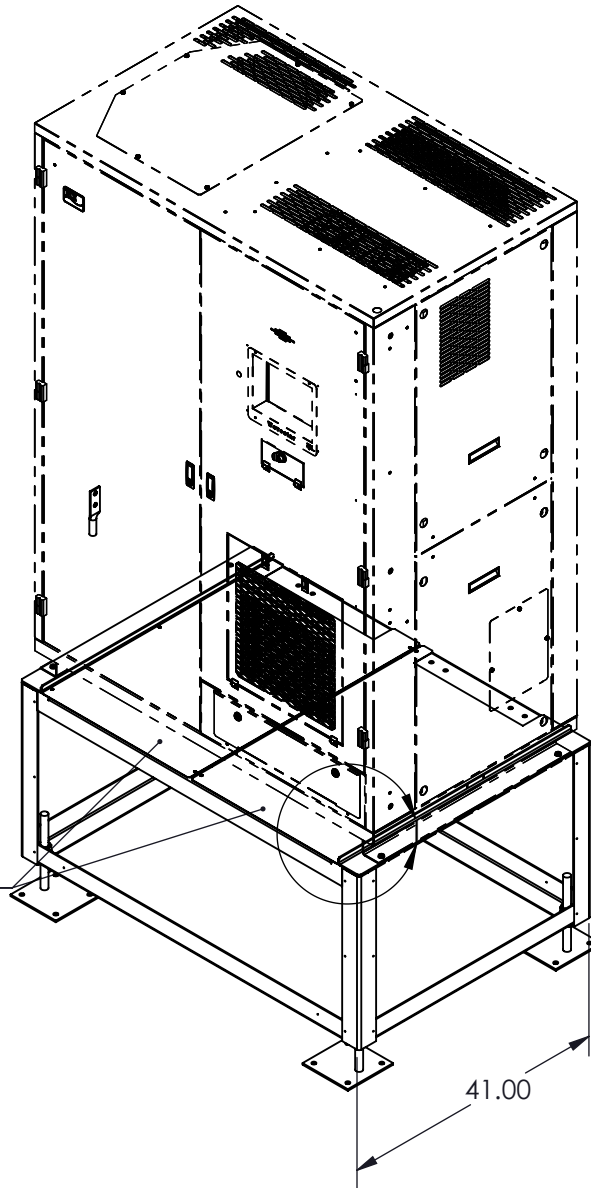

HARDWARE STACK  
1/2"-13 X 1-1/2" HEX BOLT  
1/2" FLAT WASHER  
STS AND FLOOR STAND  
1/2" FLAT WASHER  
1/2" LOCK WASHER  
1/2"-13 HEX NUT

APPLY ON ALL 4 CORNERS

DETAIL I  
SCALE 1 : 12

75 FT-LBS TORQUE FOR  
GRADE 5 HARDWARE

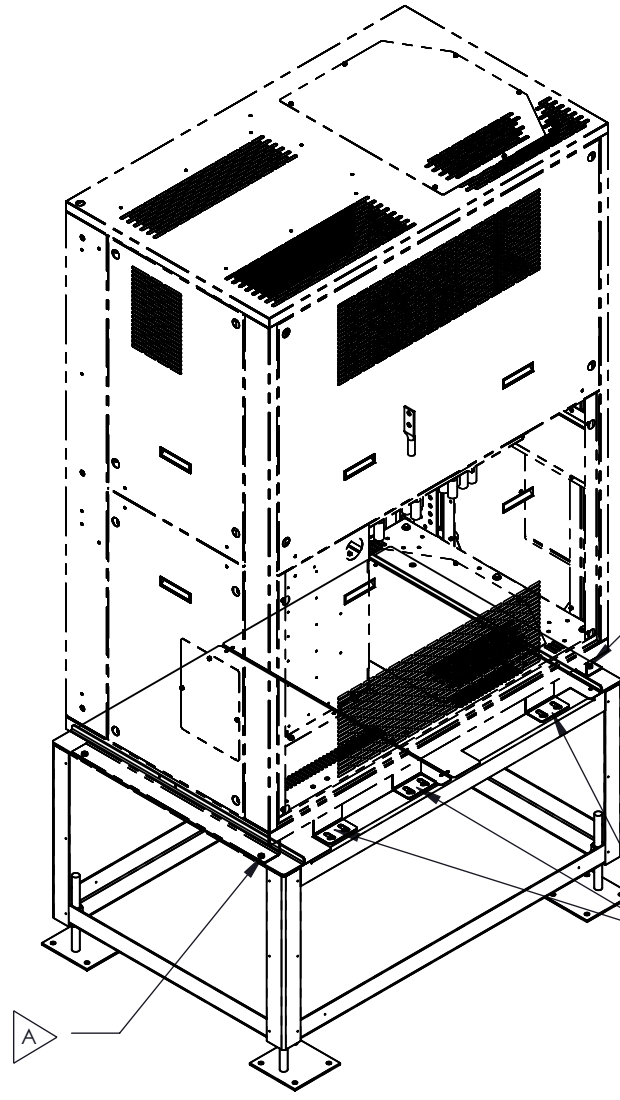

USE TFA MOUNTING BRACKETS  
IF STS REAR MOUNTING  
HOLES  $\triangle$  ARE INACCESSIBLE  
SEE SHEET 3 FOR MOUNTING DETAIL

**MACHINE  
REAR**

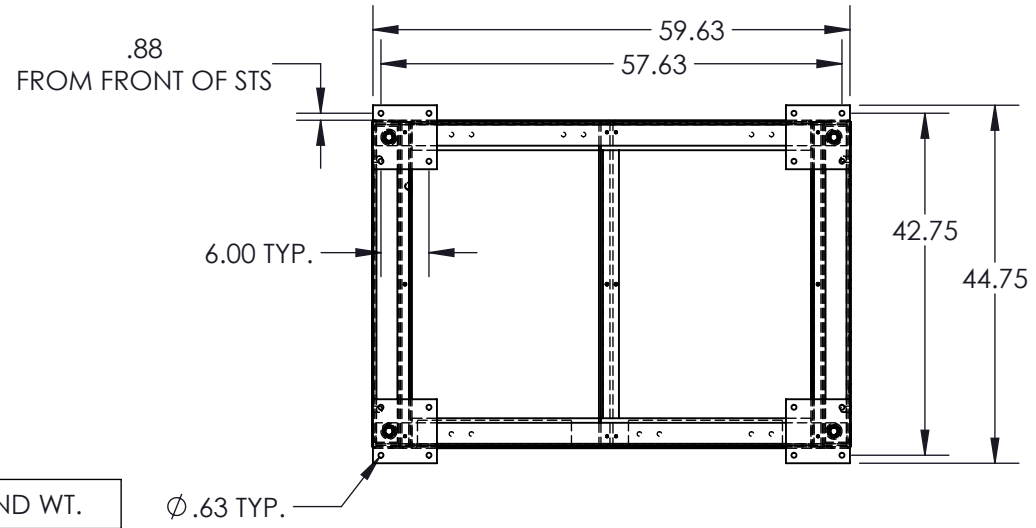

SECTION J-J  
SCALE 1 : 24

PART NUMBER	H (ADJUSTABLE RANGE)	FLOOR STAND WT.
CHS66968-H16	12"-20"	175 LBS
CHS66968-H24	20"-28"	285 LBS
CHS66968-H32	28"-36"	290 LBS
CHS66968-H40	36"-44"	300 LBS
CHS66968-H48	44"-52"	310 LBS

SIZE <b>B</b>	DWG. NO. <b>STS66987</b>	REV <b>B</b>
SCALE: NTS		SHEET 4 OF 5

8 7 6 5 4 3 2 1

8 7 6 5 4 3 2 1

D

D

C

C

B

B

A

A

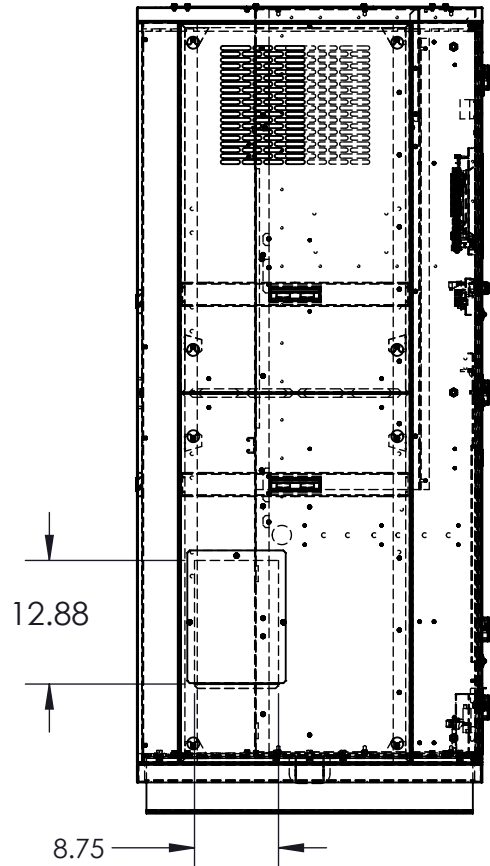

**AVAILABLE CABLE PASS THRU SPACE  
ON THE LEFT HAND SIDE OF SWITCH**

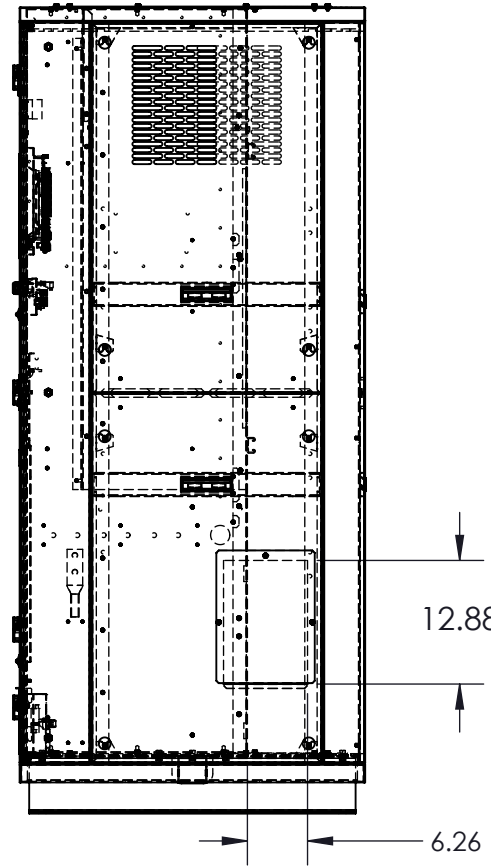

**AVAILABLE CABLE PASS THRU SPACE  
ON THE RIGHT HAND SIDE OF SWITCH**

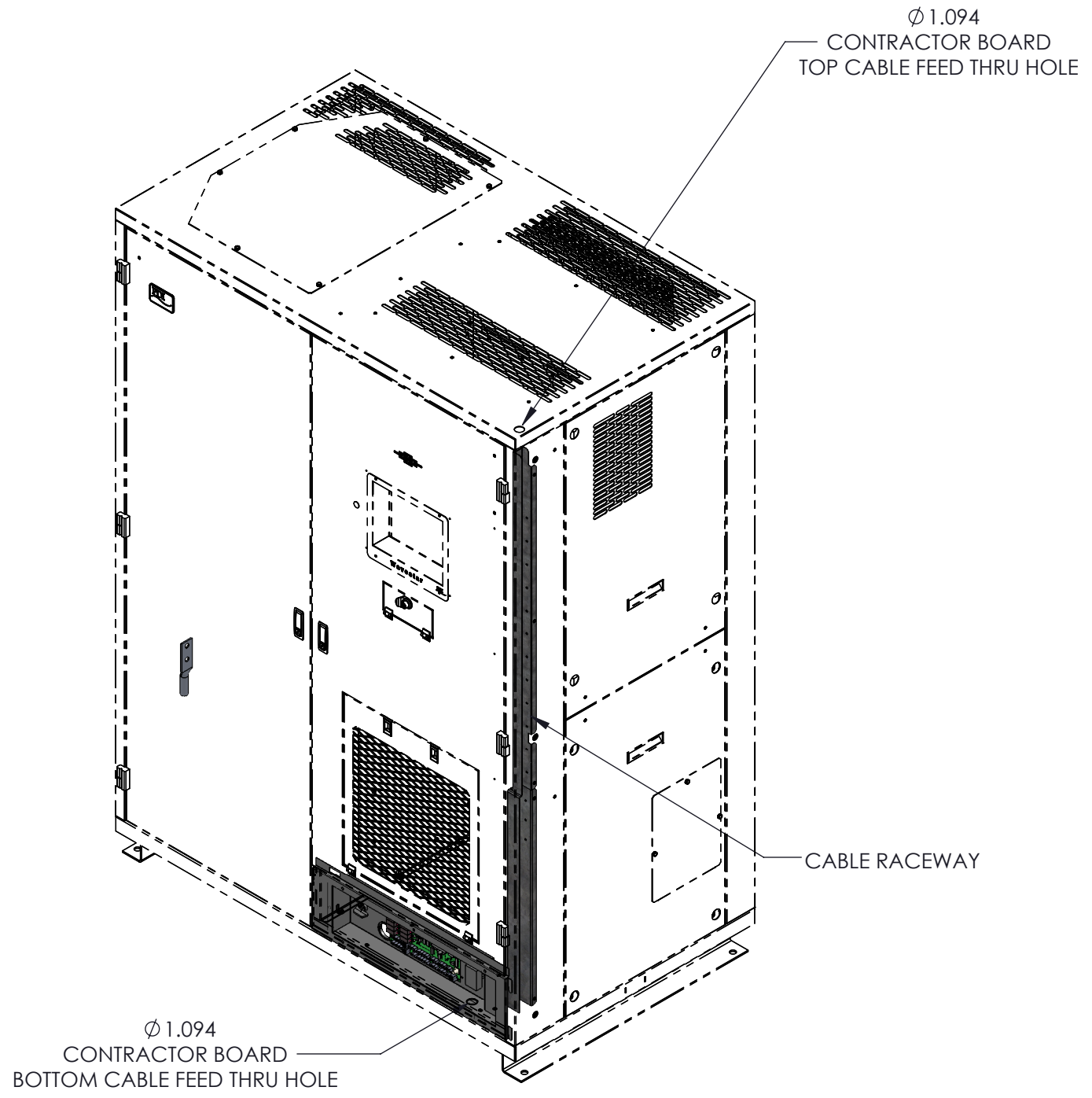

SIZE <b>B</b>	DWG. NO. <b>STS66987</b>	REV <b>B</b>
SCALE: NTS		SHEET 5 OF 5

8 7 6 5 4 3 2 1