

8 7 6 5 4 3 2 1

REMOVABLE
INPUT AND OUPUT
BUS DEAD FRONT PANEL

SOURCE 2
INPUT SWITCH
W/KEY LOCK B

SOURCE 1
INPUT SWITCH
W/KEY LOCK A

BYPASS 1
SWITCH
W/KEY LOCK B

BYPASS 2
SWITCH
W/KEY LOCK A

ISOLATE 1
SWITCH

ISOLATE 2
SWITCH

REMOVABLE BREAKER
DEAD FRONT

REMOVABLE
TOP FAN TRAY

REMOVABLE
SCR DEAD FRONT
PANEL

REMOVABLE
BOTTOM FAN TRAY

REMOVABLE
LOGIC AND BOTTOM

CONTRACTOR BOARD
COMPARTMENT

VIEW WITHOUT FRONT DOORS

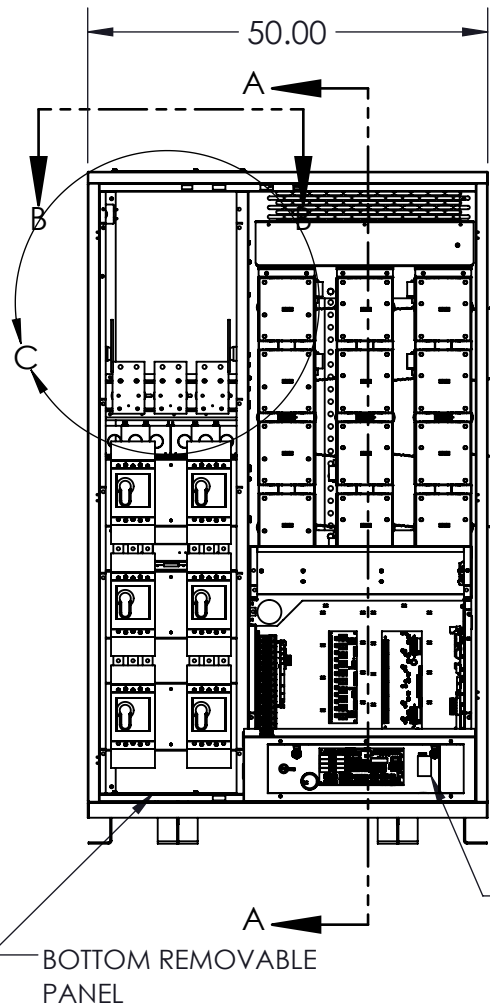

VIEW WITHOUT FRONT DOORS AND DEAD FRONT

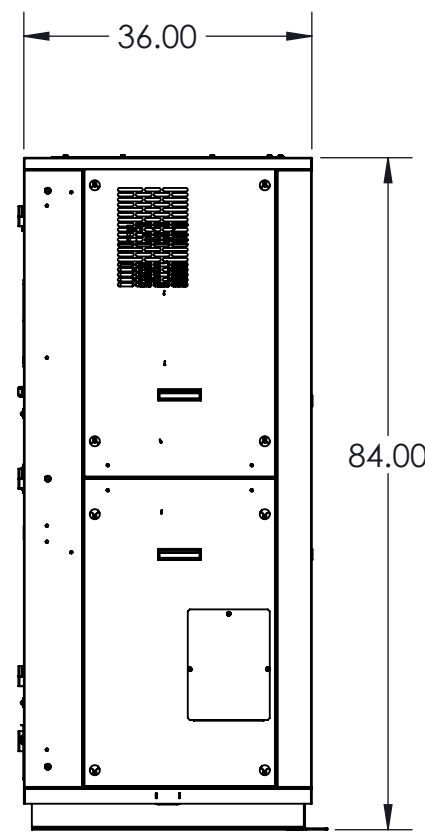

OPTIONAL EPO BUTTON

TOUCH SCREEN
DISPLAY

REDUNDANT OPERATOR INTERFACE
BOARD ACCESS

FILTER DOOR

CONTRACTOR BOARD ACCESS PANEL

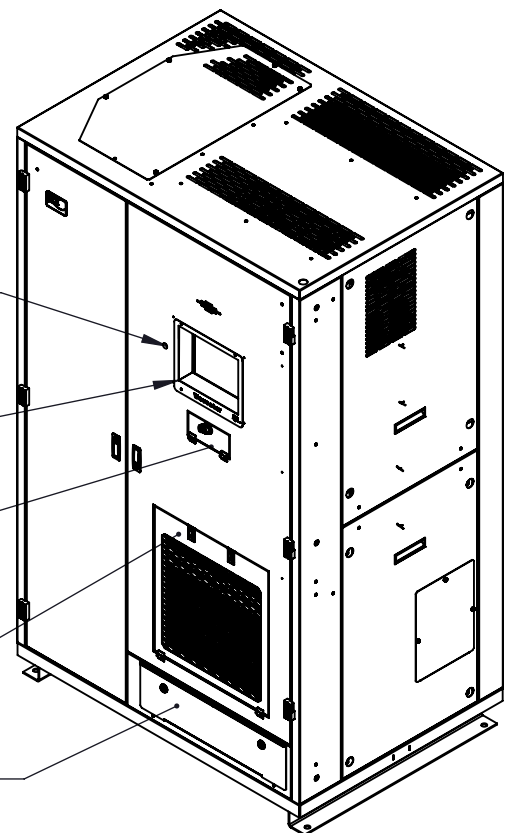

TOP SLIDE-OUT
FAN MODULE

BOTTOM
SLIDE-OUT
FAN MODULE

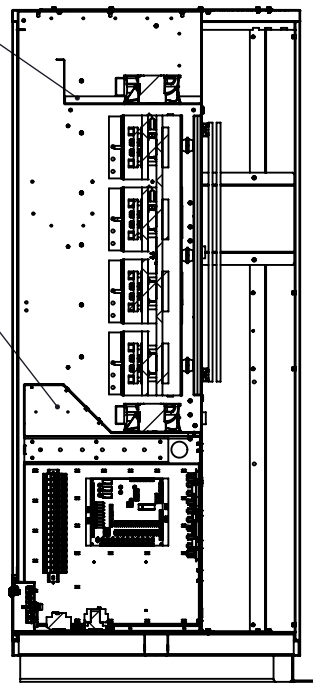

SECTION A-A

GENERAL SPECIFIED
CABINET CHARACTERISTIC:
ENCLOSURE : NEMA 1
LOCATION : INDOOR
MECHANICAL:
MOUNTING: BOLT TO CONCRETE FLOOR OR FLOOR STAND
MATERIAL: STEEL
WEIGHT : 1400 LBS. APPROX.
FRONT ACCESS FOR INSTALLATION AND MAINTENANCE
ALL OPERATOR CONTROL ARE FRONT ACCESS WITHOUT EXPOSE TO LIVE PARTS
MINIMUM 6" FOR SIDE AND REAR FOR VENTILATION

UNLESS OTHERWISE SPECIFIED:
DIMENSIONS ARE IN INCHES
[] IN MILLIMETER
ANGULAR: ±0.5° BEND ±1°
TWO PLACE DECIMAL ±0.02
THREE PLACE DECIMAL ±0.005

THIS DRAWING CONTAINS
CONFIDENTIAL & PROPRIETARY
INFORMATION AND SHALL NOT
BE DISCLOSED OR COPIED
WITHOUT THE EXPRESSED,
WRITTEN PERMISSION OF
SMITHS POWER



THIRD ANGLE PROJECTION		DO NOT SCALE DRAWING	
APPROVALS		DATE	
DRAWN	ISF	8/24/2018	
CHECKED			
ENG. APPR.	AW	8/24/2018	

TITLE: TFA STS OUTLINE DRAWING 250A - 600A TFA STS TOP ENTRY AND EXIT		
SIZE B	DWG. NO. STS68556	REV B
PART NO.		SHEET 1 OF 5

A

A

8 7 6 5 4 3 2 1

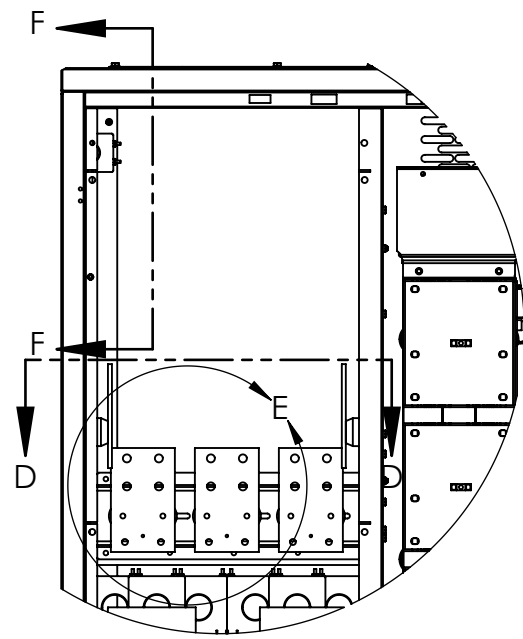

DETAIL C
SCALE 1 : 12

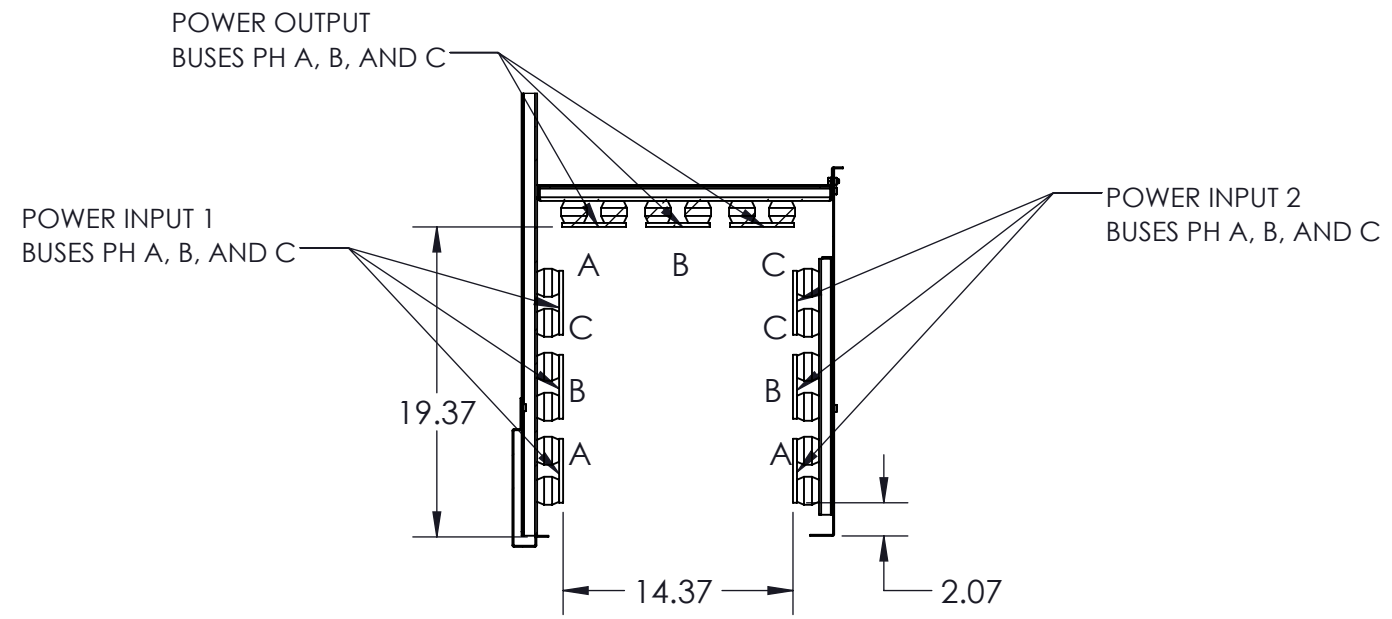

SECTION D-D
SCALE 1 : 12

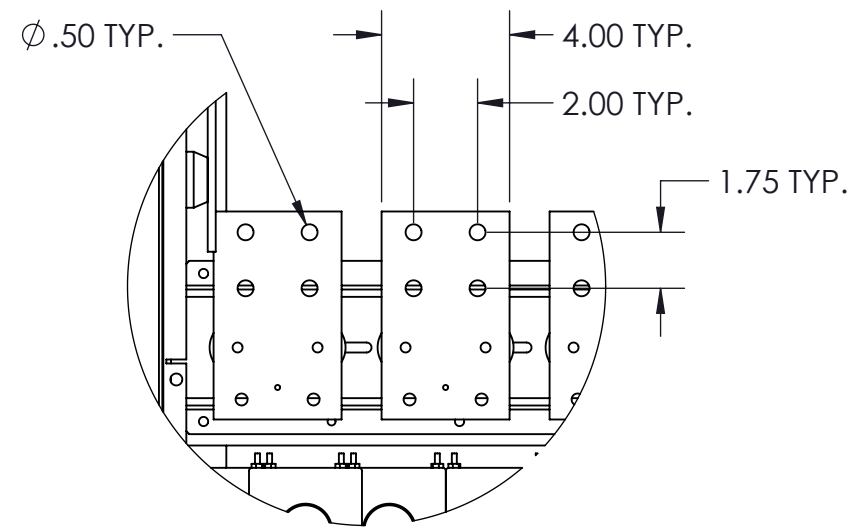

DETAIL E
SCALE 1 : 6

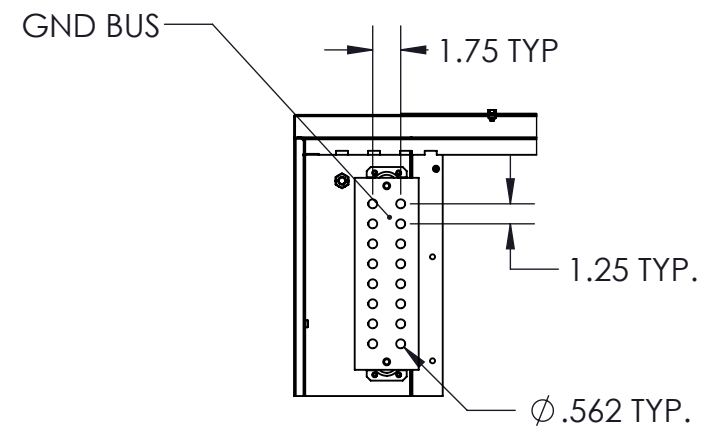

SECTION F-F
SCALE 1 : 12

SIZE B	DWG. NO. STS68556	REV A
SCALE: NTS		SHEET 2 OF 5

8 7 6 5 4 3 2 1

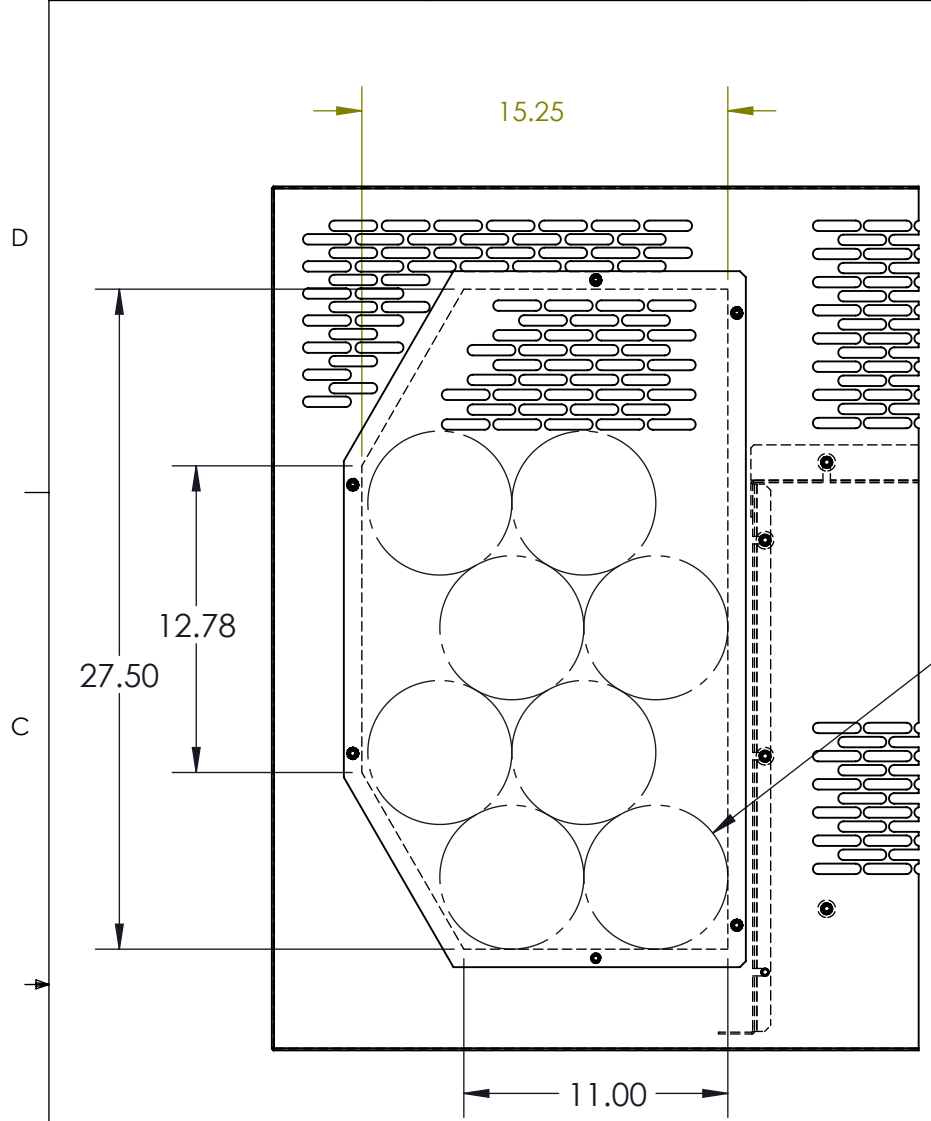

SECTION B-B
SCALE 1 : 8
TOP KNOCK-OUT AREA

Ø 6.0
4" CONDUIT SPACE

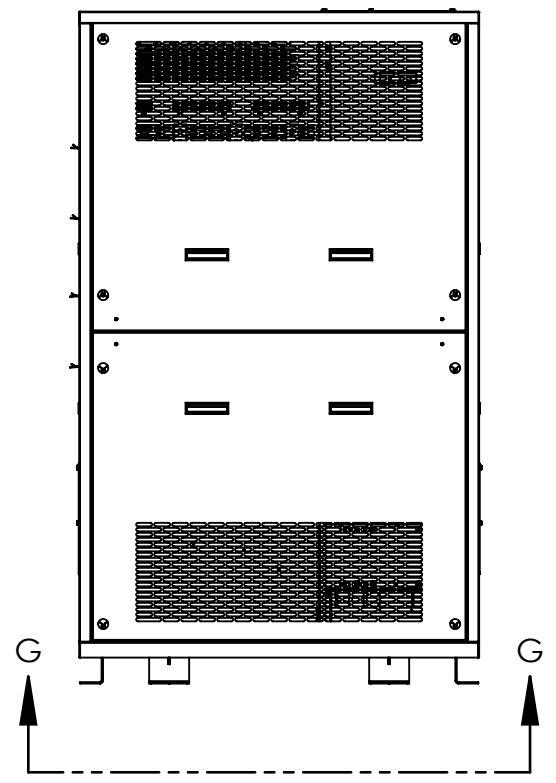

SECTION G-G
SCALE 1 : 24

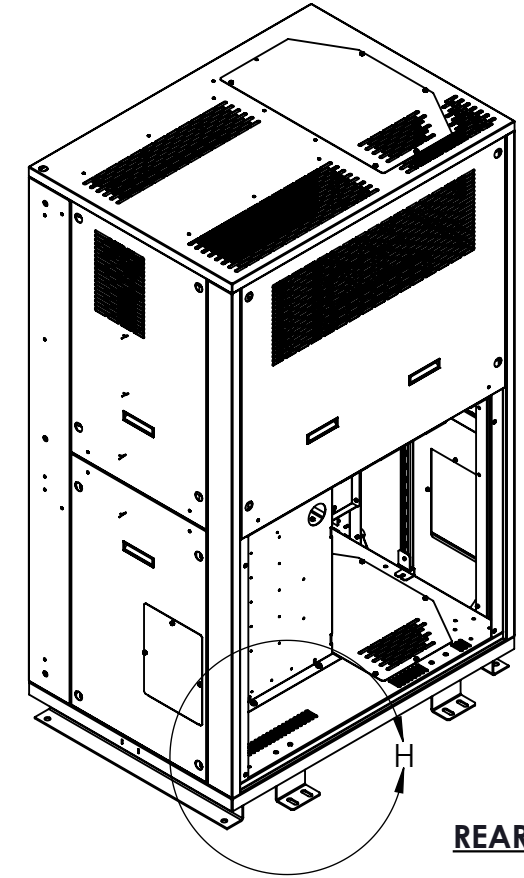

REAR VIEW

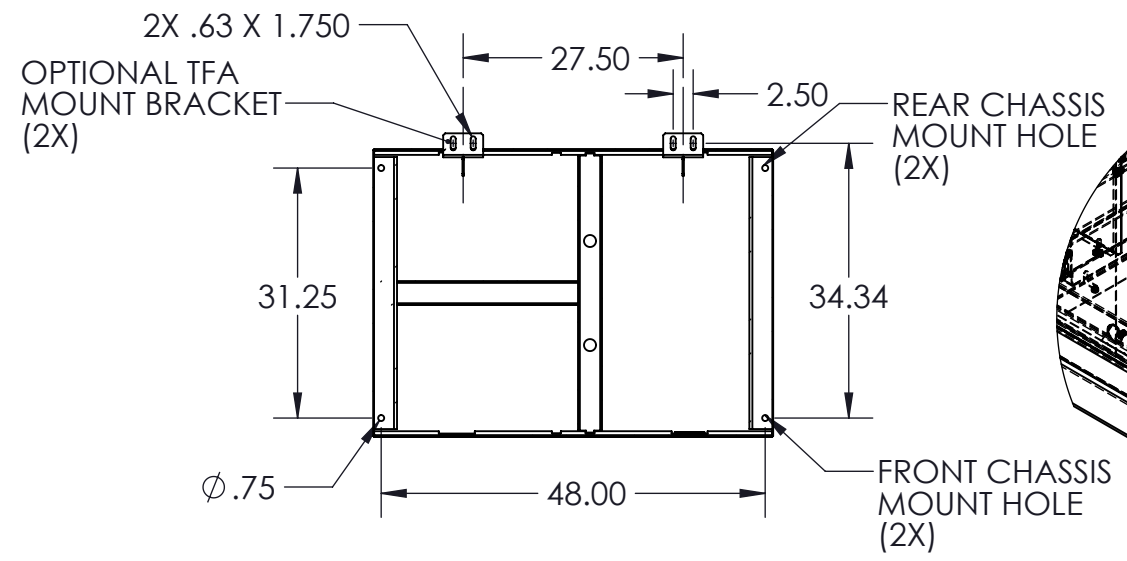

DETAIL H
SCALE 1 : 12

HARDWARE STACK
1/2"-13 X 1-1/2 HEX BOLT
1/2" LOCK WASHER
1/2" FLAT WASHER
75 FT-LBS TORQUE FOR
GRADE 5 HARDWARE

TFA MOUNTING BRACKETS
MOUNT BRACKETS
PRIOR PLACING UNIT

CONDUCTOR RECOMMENDATION:
CONDUCTOR BASED ON 90DEG C CABLE AT 40DEG C AMBIENT TEMPERTURE
REFER TO UL, NEC OR AUTHORITY HAVING JURISDICTION (AHJ) FOR APPROPRIATE CONDUCTOR SIZE.

STS AMPAGE	CU CONDUCTOR PER PHASE	MIN. # OF 4" CONDUIT	AL CONDUCTOR PER PHASE	MIN. # OF 4" CONDUIT
250A	1-250 MCM	1	1-350 MCM	2
400A	1-600 MCM	2	2-250 MCM	2
	2-3/0 AWG	1		
600A	2-350 MCM	2	2-500 MCM	3
	3-3/0 AWG	2	3-250 MCM	2

OPTIONAL TFA MOUNTING BRACKET
BOTH SIDE ACCESS REQUIRE FOR
TOP ENTRY AND EXIT CONFIGURATION

SIZE B	DWG. NO. STS68556	REV A
SCALE: NTS	SHEET 3 OF 5	

8 7 6 5 4 3 2 1

8 7 6 5 4 3 2 1

D
C
B
A

D
C
B
A

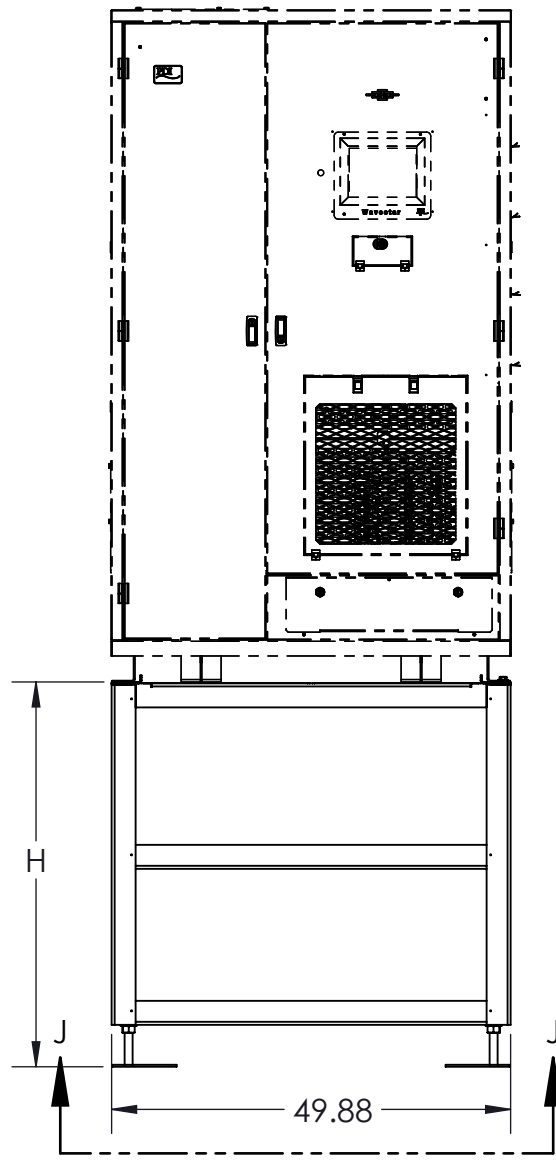

REMOVAL BE
PANELS

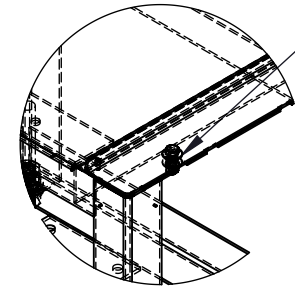
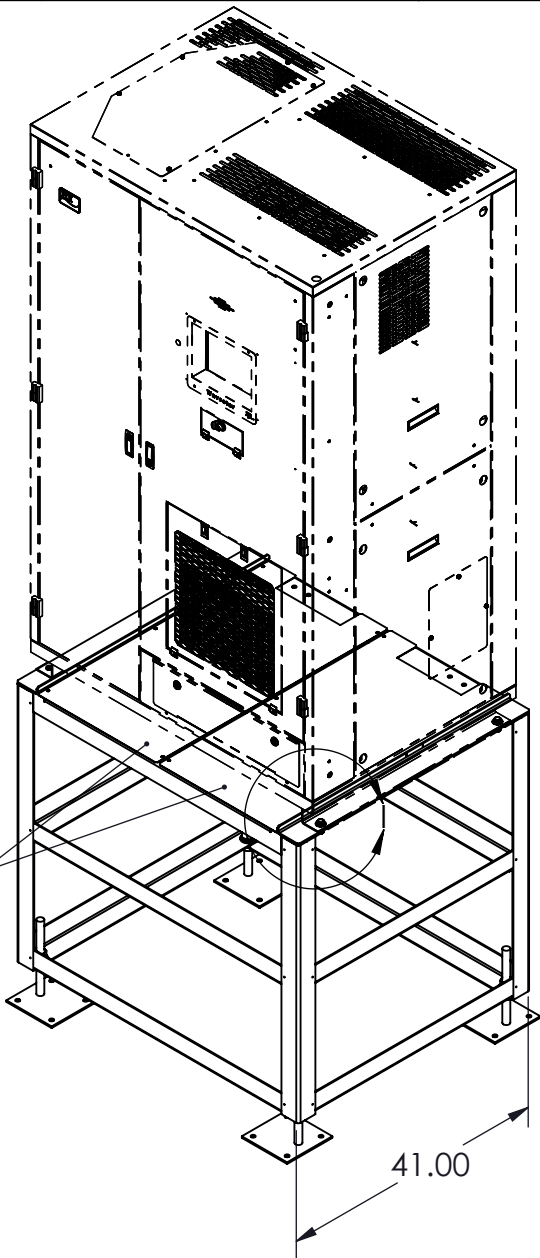

HARDWARE STACK
1/2"-13 X 1-1/2 HEX BOLT
1/2" FLAT WASHER
STS AND FLOOR STAND
1/2" FLAT WASHER
1/2" LOCK WASHER
1/2"-13 HEX NUT

APPLY ON ALL 4 CORNERS

75 FT-LBS TORQUE FOR
GRADE 5 HARDWARE

DETAIL I
SCALE 1 : 12

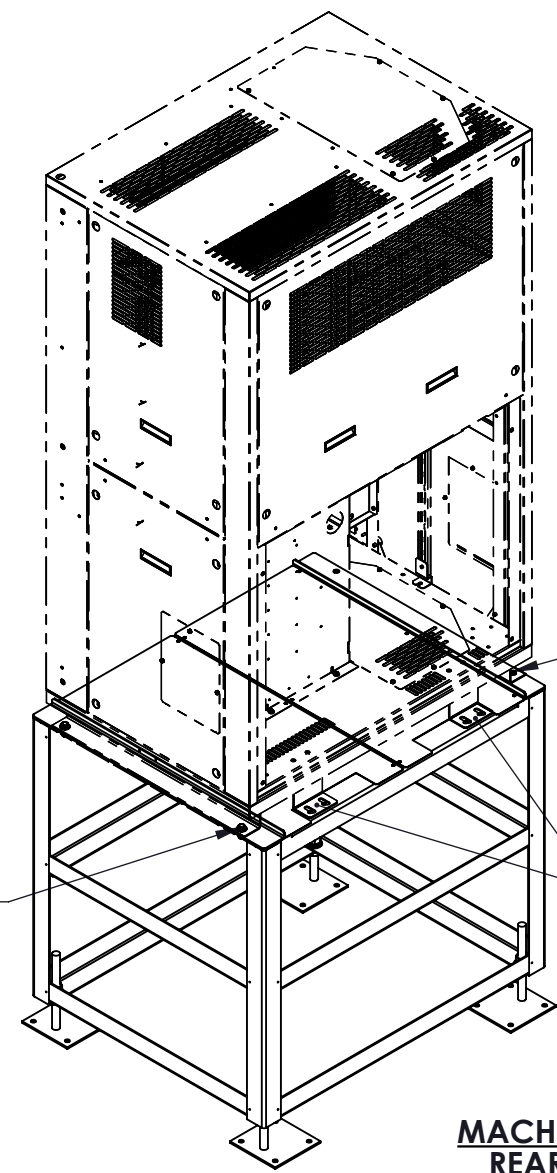

USE TFA MOUNTING BRACKETS
IF STS REAR MOUNTING
HOLES 'A' ARE INACCESSIBLE
SEE SHEET 3 FOR MOUNTING DETAIL

**MACHINE
REAR**

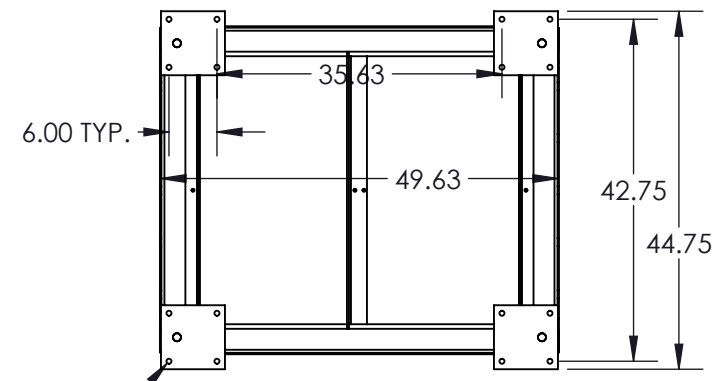

SECTION J-J
SCALE 1 : 24

PART NUMBER	H (ADJUSTABLE RANGE)	FLOOR STAND WT.
CHS66569-H16	12"-20"	165 LBS
CHS66569-H24	20"-28"	275 LBS
CHS66569-H32	28"-36"	280 LBS
CHS66569-H40	36"-44"	290 LBS
CHS66569-H48	44"-52"	300 LBS

SIZE B	DWG. NO. STS68556	REV A
SCALE: NTS	SHEET 4 OF 5	

8 7 6 5 4 3 2 1

8

7

6

5

4

3

2

1

D

C

B

A

D

C

B

A

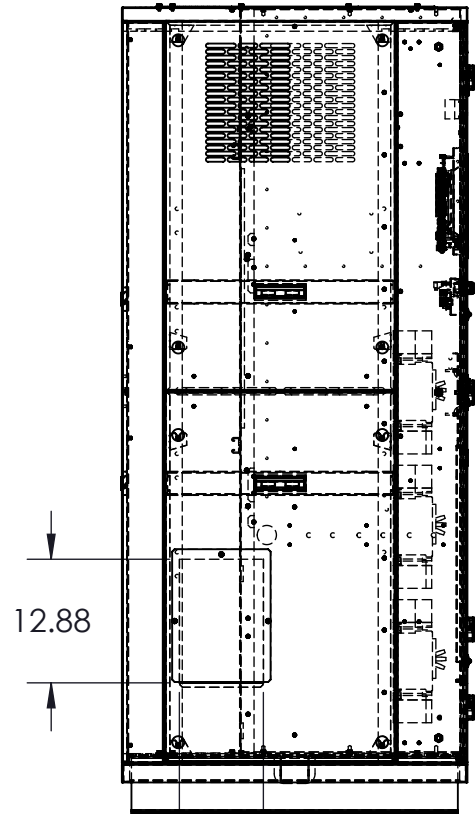

12.88

8.75

**AVAILABLE CABLE PASS THRU SPACE
ON THE LEFT HAND SIDE OF SWITCH**

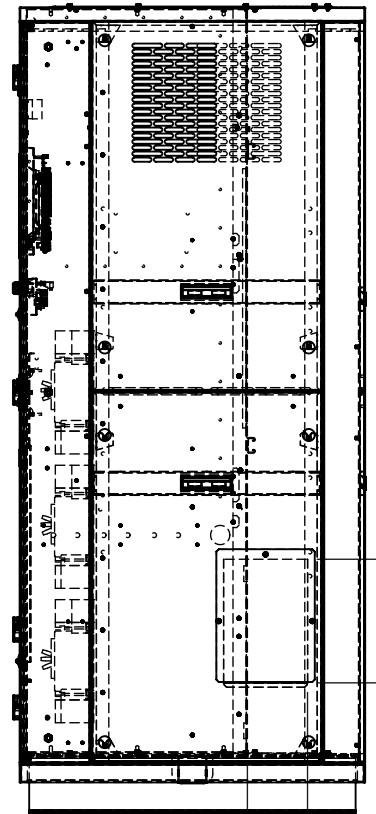

12.88

6.26

**AVAILABLE CABLE PASS THRU SPACE
ON THE RIGHT HAND SIDE OF SWITCH**

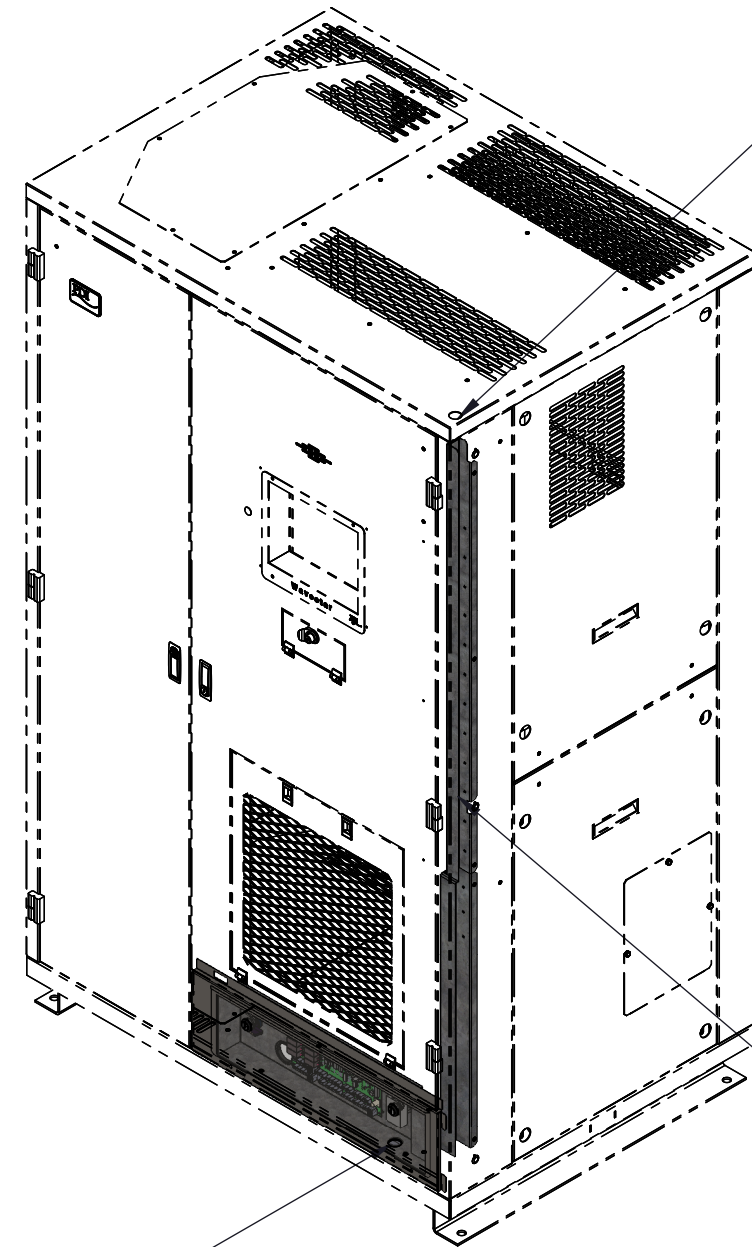

$\phi 1.094$

CONTRACTOR BOARD
TOP CABLE FEED THRU HOLE

REMOVE CONTRACTOR BOARD
ACCESS PANEL
FEED CABLE THRU

CABLE RACEWAY

$\phi 1.094$
CONTRACTOR BOARD
BOTTOM CABLE FEED THRU HOLE

SIZE B	DWG. NO. STS68556	REV
SCALE: NTS	SHEET 5 OF 5	

8

7

6

5

4

3

2

1