

**FRONT VIEW**  
(DOOR & COVERS REMOVED)

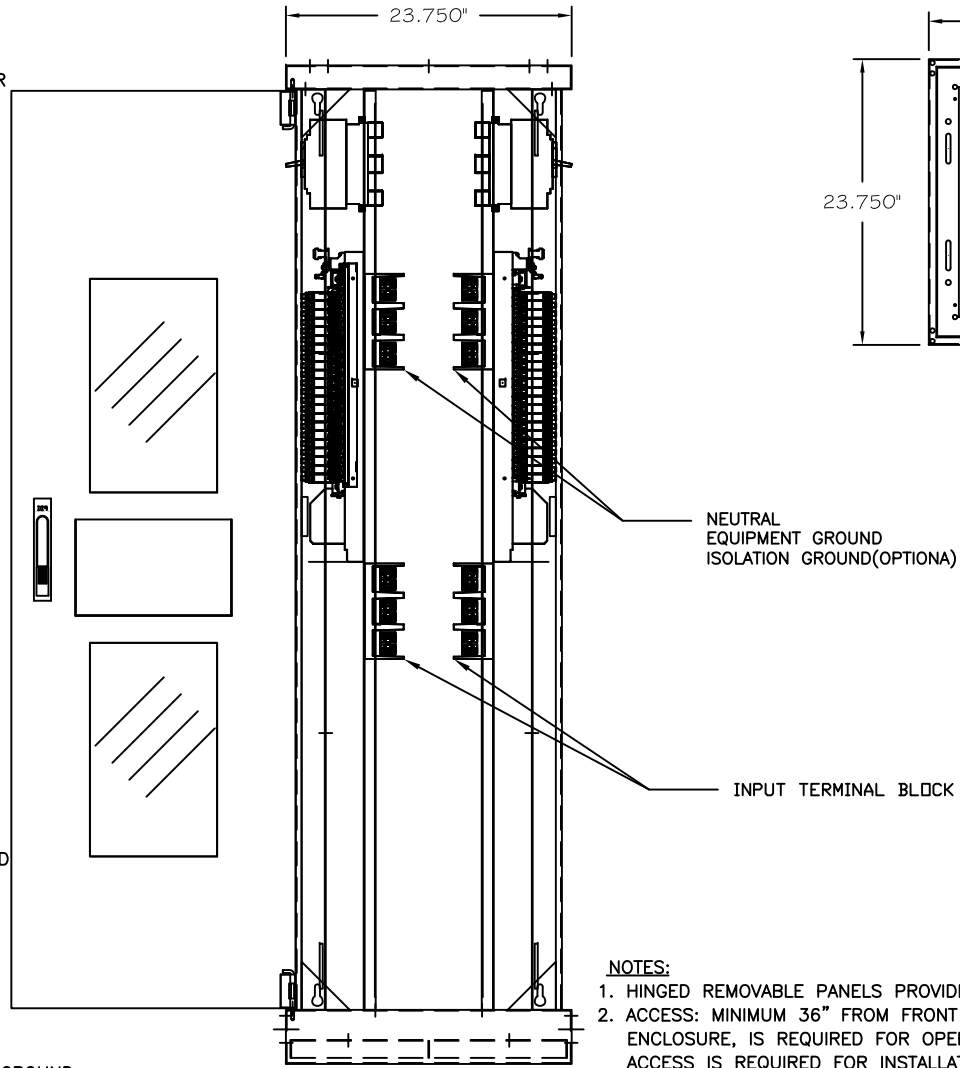

**SIDE VIEW**  
(DOOR & COVERS REMOVED)

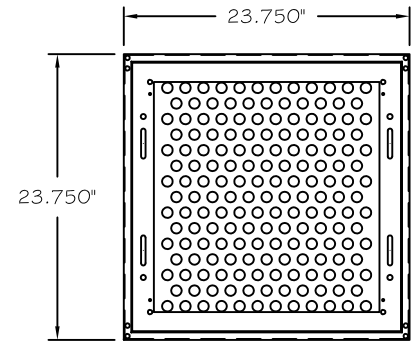

**FOOT PRINT**

**NOTES:**

1. HINGED REMOVABLE PANELS PROVIDED ON SIDES.
2. ACCESS: MINIMUM 36" FROM FRONT & REAR OF ENCLOSURE, IS REQUIRED FOR OPERATION. SIDE ACCESS IS REQUIRED FOR INSTALLATION & MAINTENANCE.
3. APPROXIMATE WEIGHT: 600lbs.
4. (2) CIRCUIT BREAKERS, (2) 42 CIRCUIT PANELBOARD (2) INPUT TERMINAL
5. (168)- 0.875Ø KNOCKOUTS PROVIDED.

THIS DRAWING CONTAINS CONFIDENTIAL & PROPRIETARY INFORMATION AND SHALL NOT BE DISCLOSED OR COPIED WITHOUT THE EXPRESSED, WRITTEN PERMISSION OF POWER DISTRIBUTION INC.		TITLE		-OUTLINE-	
		2) MAINS & (2) PANELBOARDS (2) INPUT TERMINAL BLOCKS		REMOTE POWER PANEL (RPP)	
		DWG. NUMBER	SHEET 1 OF 1	REVISION	
		RPP18311		-A-	
		DRAWN BY	ISF	CHECKED BY	LJN
DATE	04-27-15	DATE	04-27-15		

