

NOTES:

1. OPERATOR INTERFACE PANEL.
2. MAIN INPUT CIRCUIT BREAKER.
3. 1-6 (50-250A) SUBFEEDS.
4. 225A SECONDARY MAIN CIRCUIT BREAKER.
5. (42) POLE DISTRIBUTION PANELBOARDS.
6. RECOMMEND A MINIMUM OF 30" IN REAR OR SIDE OF UNIT FOR MAINTENANCE.
7. MINIMUM OF 36" CLEARANCE FOR DOOR SWING.
8. RECOMMEND 6" CLEARANCE BETWEEN VENTILATED SIDES AND WALL FOR PROPER COOLING.
9. FRONT, REAR AND RIGHT-SIDE ACCESS REQUIRED.

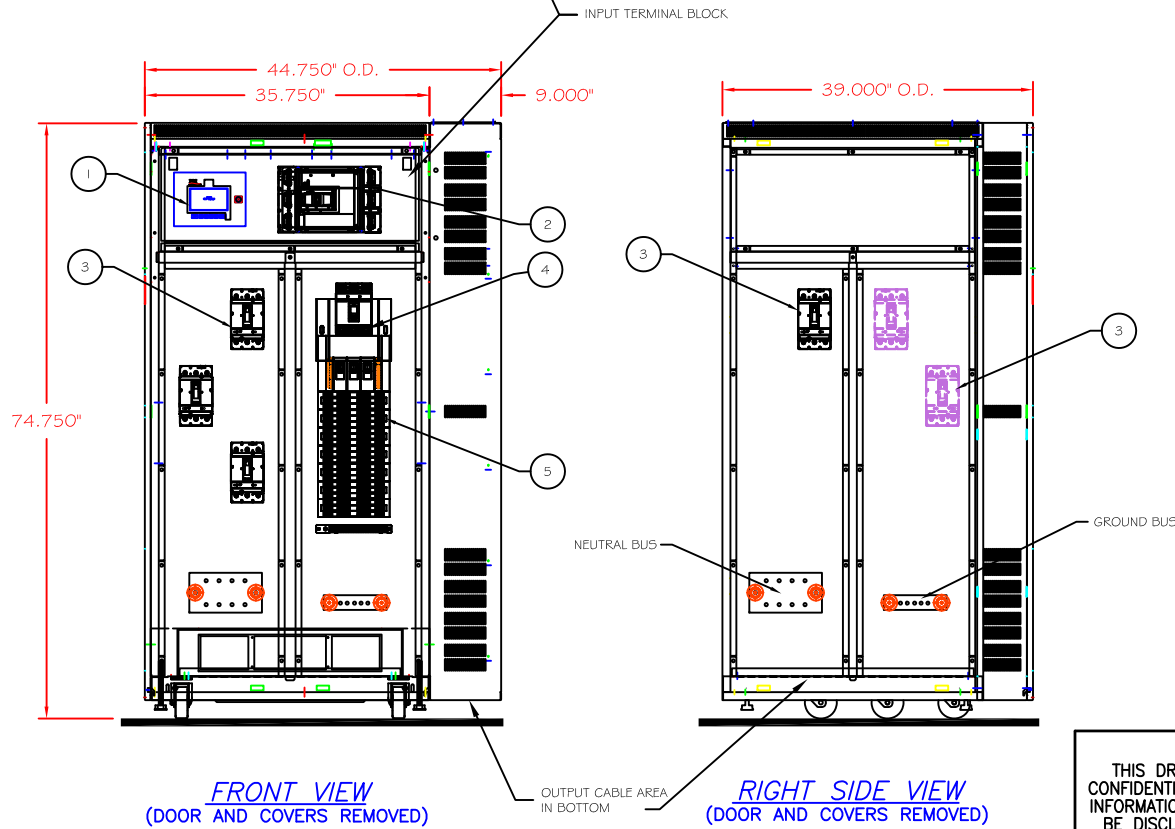

THIS DRAWING CONTAINS CONFIDENTIAL & PROPRIETARY INFORMATION AND SHALL NOT BE DISCLOSED OR COPIED WITHOUT THE EXPRESSED, WRITTEN PERMISSION OF POWER DISTRIBUTION INC.

TITLE			-OUTLINE-		
PDU (200-300kVA)			W/ RH SIDECAR		
(1) 42 POLE PANEL BOARD & 1-6 (50-250A) SUBFEEDS					
DWG. NUMBER	SHEET 1 OF 1	REVISION			
PDU18580		-A-			
DRAWN BY	RAE	CHECKED BY	KRH		
DATE	6-15-15	DATE	6-15-15		

PDI
creating the perfect wave