

NOTES:

1. OPERATOR INTERFACE PANEL.
2. MAIN INPUT CIRCUIT BREAKER.
3. 800A I-LINE PANEL BOARD (HCM2364-8).
4. (1-10) 50-250A SUBFEEDS.
5. RECOMMEND A MINIMUM OF 6" IN REAR AND RIGHT SIDE OF UNIT FOR VENTILATION.
6. MINIMUM OF 36" CLEARANCE FOR DOOR SWING IN FRONT.
7. MINIMUM OF 36" CLEARANCE FOR DOOR SWING ON LEFT SIDE.

NEUTRAL BUS
GROUND BUS

PLAN VIEW

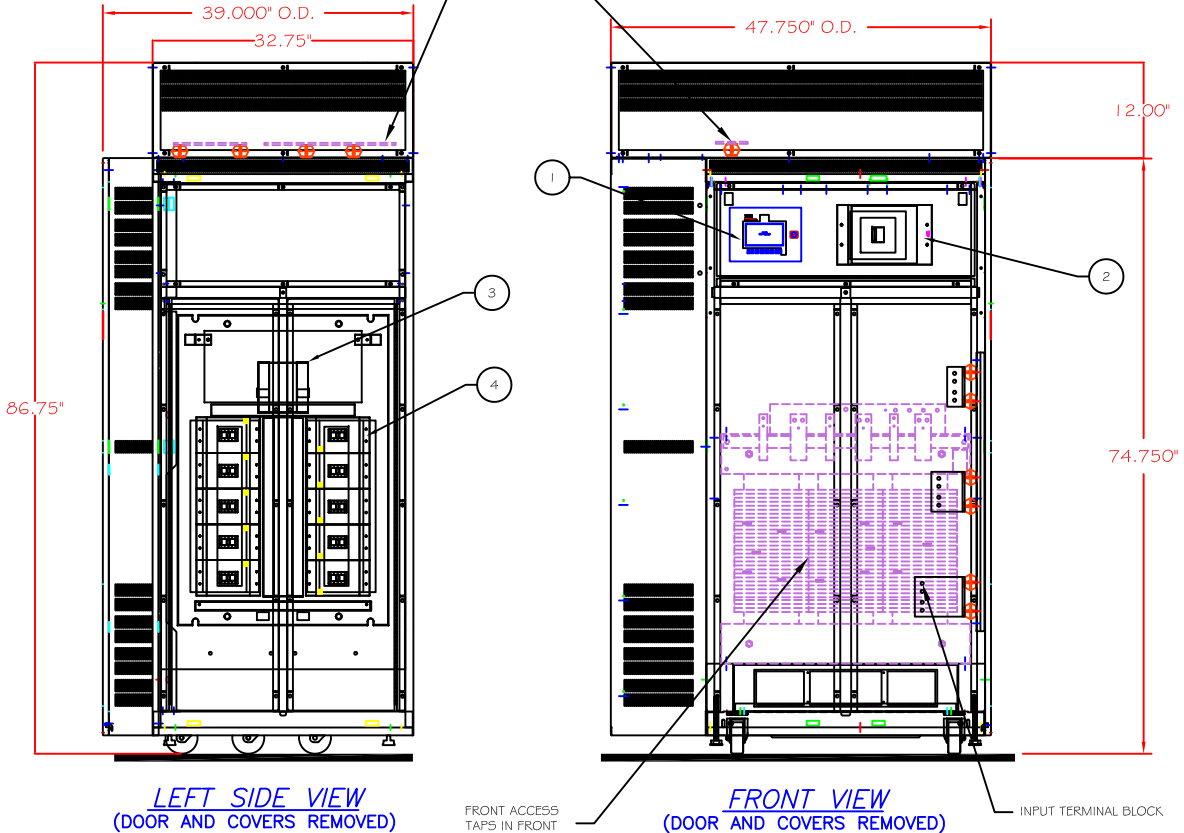

LEFT SIDE VIEW
(DOOR AND COVERS REMOVED)

FRONT VIEW
(DOOR AND COVERS REMOVED)

FRONT ACCESS
TAPS IN FRONT

INPUT TERMINAL BLOCK

TOP ENTRY/EXIT

THIS DRAWING CONTAINS CONFIDENTIAL & PROPRIETARY INFORMATION AND SHALL NOT BE DISCLOSED OR COPIED WITHOUT THE EXPRESSED, WRITTEN PERMISSION OF POWER DISTRIBUTION INC.		TITLE		-OUTLINE-	
		PDU (200-300 kVA)		W/ LH 12" SIDECAR	
		800A I-LINE PANEL W/ (1-10) 50-250A SUBFEEDS			
		DWG. NUMBER	SHEET 1 OF 1	REVISION	
PDU18381		-A-			
DRAWN BY	RAE	CHECKED BY	KRH		
DATE	05-14-15	DATE	05-14-15		

