

NOTES:

1. OPERATOR INTERFACE PANEL.
2. 500AT MAIN INPUT BREAKER.
3. 6 (225A) SUBFEEDS.
4. INPUT CONNECTION LOCATION.
5. MINIMUM OF 36" CLEARANCE FOR DOOR SWING.
6. RECOMMEND 6" CLEARANCE BETWEEN VENTILATED SIDES AND WALL FOR PROPER COOLING.
7. UNIT SHIPPED ASSEMBLED.
8. ESTIMATED SHIPPING WEIGHT 2680#.

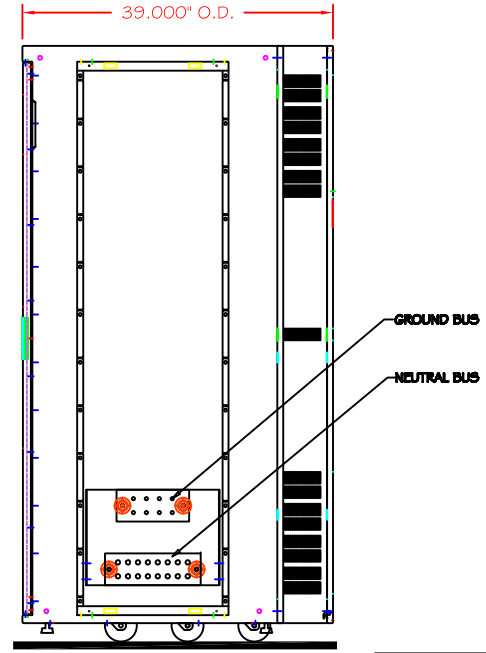
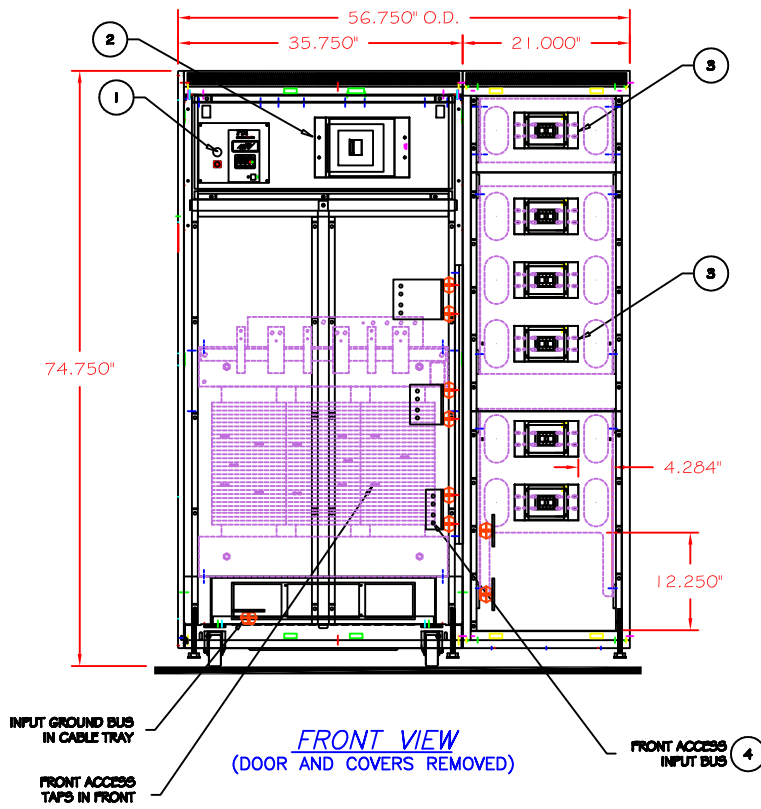

THIS DRAWING CONTAINS CONFIDENTIAL & PROPRIETARY INFORMATION AND SHALL NOT BE DISCLOSED OR COPIED WITHOUT THE EXPRESSED, WRITTEN PERMISSION OF POWER DISTRIBUTION INC.		-OUTLINE-	
		PDU (300 kVA) FRONT ACCESS W/ RH FS SIDECAR 6 (225A) SUBFEEDS MOUNTED HORIZONTAL	
DWG. NUMBER	SHEET 1 OF 1	REVISION	
DWG11113-NL		-A-	
DRAWN BY	RAE	CHECKED BY	DAS
DATE	01-02-08	DATE	01-12-08

PDI
creating the perfect wave