

ZoneBarrier 4PPOE range

Din rail mount protection system

CAUTION

IMPORTANT SAFETY INSTRUCTIONS

1. Never install ethernet wiring during a lightning storm.
2. This product is intended for INDOOR USE ONLY.
3. Secondary Protectors are intended for use on the equipment side of a listed UL 497B Protector.
4. Risk of Electric Shock - Protector is not to be used without the arrester assembly installed.

Installation

1. Read and understand all instructions.
2. The SPD modules can be installed individually, mounting to any flat surface using the two screw holes. SPD modules can also be installed on a Din Rail.

In planning an installation, location of the SPD unit in close proximity to the correct ground point is essential for protection performance. The correct ground point is defined as the ground reference used by the system to be protected. In most applications this is AC power ground. MINIMIZE the distance between the SPD unit and the identified ground point as short as possible.

Stand-alone installation

3. To install the SPD unit as a stand-alone unit, attach a ground wire (minimum #16AWG for Secondary Protector) to the SPD using the recommended accessories and using screws(or bolts) as appropriate, mount the unit to the flat surface (see figure 1).

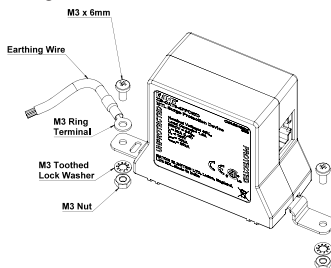

Figure 1 - Stand-alone Installation

Mounting and grounding on a Din Rail

4. To install a SPD surge protector on a Din Rail, locate the Din Rail foot over the Din Rail and securely push the clip onto the Din Rail. Rotate downward and push the SPD onto the Din Rail until the latch snaps on to the rail. (see figure 2).

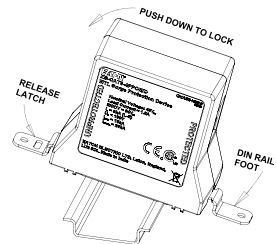

Figure 2 - Mounting and grounding on a Din Rail

The surge protector is now securely grounded to the Din Rail. An existing or customer supplied Din Rail can be used providing the rail is securely connected to the correct ground (see grounding section). To remove a module, gently pull the release latch forward and rotate the SPD upward off of the Din Rail.

5. Connect the incoming line to the port marked "unprotected" on the SPD module. Run cable from the SPD port marked "protected" to the equipment to be protected. Patch cable wire size must not exceed #24AWG.
6. Connect a green ground wire from the Din Rail or from the SPD unit to the identified grounding point (see grounding section).
7. Save these instructions.

Grounding

The Din Rail grounding stud must be connected to the ground reference used by the system being protected. In a computer room environment this grounding point may be the ground bar in the AC power panel. Ground leads longer than 0.25 meter are not recommended

	<p>WARNING !</p> <p>The grounding lead must be as short as is practically possible. Minimize length to the inch. The ground wire should be a minimum #14AWG for Secondary Protector applications.</p>
---	--

Independent grounds

Surge protection devices must not be connected to independently derived grounds.

Wiring instructions

All SPDs are clearly labeled with one end marked “Protected” and one end marked “Unprotected”. Connect field cables to the unprotected side. Connect cables from equipment to be protected to the end marked protected.

Models



RJ45 interface ZoneBarriers:

1. Simply connect the patch cable between the protected side of the ZoneBarrier and the equipment to be protected.
2. Connect the field cable to the unprotected side of the ZoneBarrier
3. NOTE: All RJ45 models universally accept RJ11 jacks

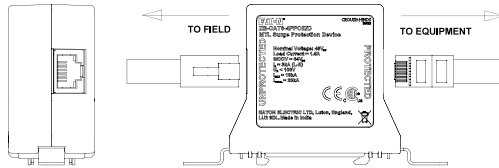

Rated voltage breakdown range		
	Strikevoltage Vdc,(@100V/S)	Strikevoltage Vdc,(@100V/μS)
ZB-CAT6-4PPOE/D	120-180	<1000

NOTE:

The protected device should also have AC suppression or it will still be vulnerable to transients from the incoming AC power. This can show up as failures on the communication interface.



Eaton Electric Limited,
Great Marlings, Butterfield, Luton
Beds, LU2 8DL, UK.
Tel: + 44 (0)1582 723633 Fax: + 44 (0)1582 422283
E-mail: mtlenquily@eaton.com
www.eaton.com
© 2023 Eaton
All Rights Reserved
Publication No. INS 801-774 Rev A 170323
March 2023

EUROPE (EMEA):
+44 (0)1582 723633
mtlenquily@eaton.com

THE AMERICAS:
+1 800 835 7075
mtl-us-info@eaton.com

ASIA-PACIFIC:
+65 6645 9864 / 9865
sales.mtsing@eaton.com

The given data is only intended as a product description and should not be regarded as a legal warranty of properties or guarantee. In the interest of further technical developments, we reserve the right to make design changes.