



Powering Business Worldwide

SITE PLANNING DATA 9395P 250/300KVA-MBS

Page 1

Dimensional Drawings

Page 2

Customer Connections

Page 3

Isometric View of Customer Connections

Page 4

Electrical Wiring of single unit

Page 5

Product Specifications



METRIC		THIRD ANGLE PROJECTION		EATON CORPORATION			
DIMENSIONS ARE IN MILLIMETERS AFTER PLATING, DIMENSIONS AND TOLERANCES IN ACCORDANCE WITH ASME Y14.5M-1994. SEE NOTES FOR TOLERANCES.							
DESCRIPTION: 9395P 300KVA with MBS							
ORIGINATED: ATIF RASHEED	27.04.2015	ECO:	NAME:	REVISION: 001	SIZE: A2		
MODIFIED:				STATE: RELEASED	SCALE: 1:1		
CHECKED:		DOCUMENT TYPE:	P-110000417		SHEET:		
SAFETY:		AUTOCAD DRAWING			OF		
APPROVED:							
EATON CORPORATION - CONFIDENTIAL AND PROPRIETARY NOTICE TO PERSONS RECEIVING THIS DOCUMENT AND/OR TECHNICAL INFORMATION THIS DOCUMENT, INCLUDING THE DRAWING AND INFORMATION CONTAINED THEREIN, IS CONFIDENTIAL AND IS THE EXCLUSIVE PROPERTY OF EATON CORPORATION AND IS LOANED TO YOU AND SUBJECT TO RECALL BY EATON AT ANY TIME. BY TAKING POSSESSION OF THIS DOCUMENT, THE RECIPIENT ACKNOWLEDGES AND AGREES THAT THIS DOCUMENT CANNOT BE USED IN ANY MANNER HARMFUL TO THE INTERESTS OF EATON AND THAT NO PORTION OF THIS DOCUMENT MAY BE COPIED OR OTHERWISE REPRODUCED WITHOUT THE PRIOR WRITTEN CONSENT OF EATON. IN THE CASE OF CONFLICTING CONTRACTUAL PROVISIONS, THIS NOTICE SHALL GOVERN THE STATUS OF THIS DOCUMENT. © 2011 Eaton Corporation - All Rights Reserved.							

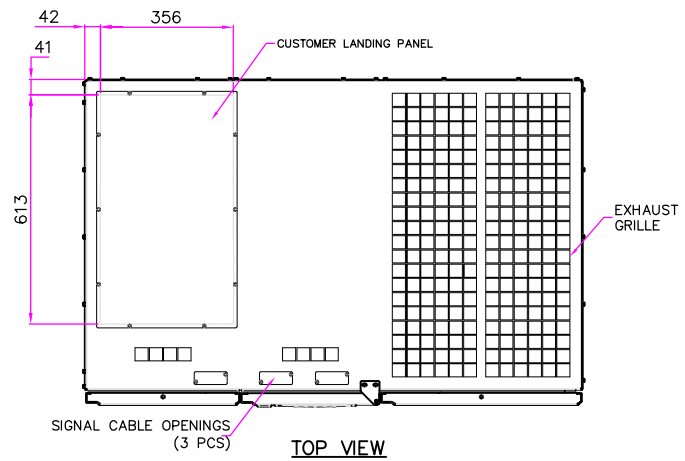

Product Specifications						
UPS Rating		Max Heat Dissipation at 100% Load	Dimensions WXD _X H	Approx. Weight Unpacked	Floor Landing	Cooling Air
KVA	KW	KW	MM	Kg	Kg/m ²	L/S
250	250	11.2	1342X875X1878	830	752	1160
300	275	12.7	1342X875X1878	830	752	1160

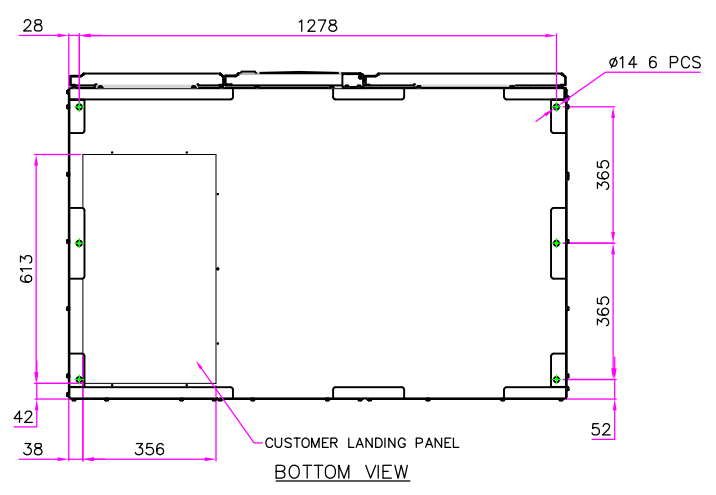
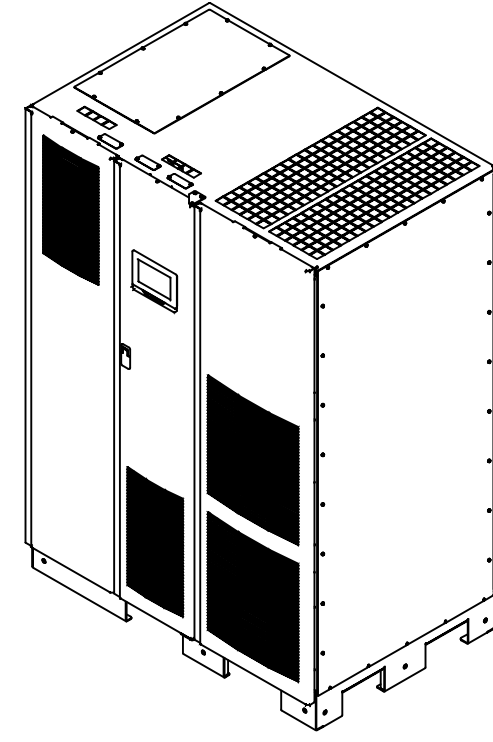
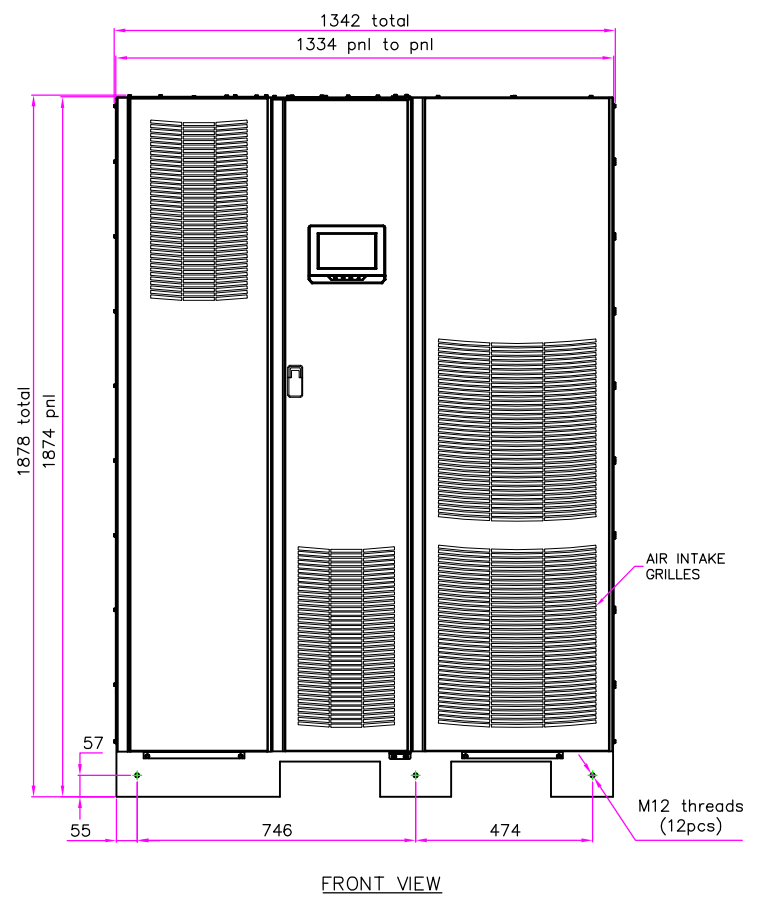
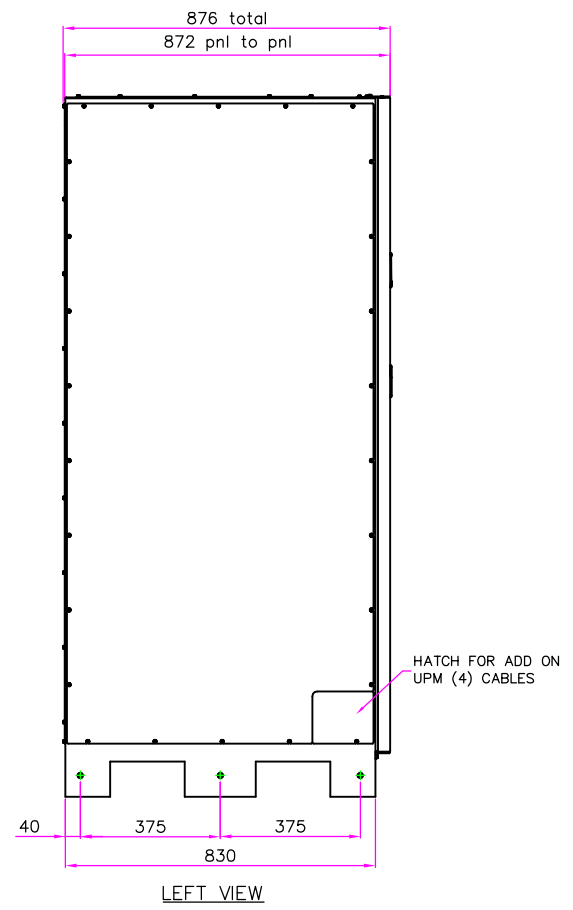

- Notes:
1. The system must be installed in a temperature and humidity controlled indoor area free of conductive contaminants.
 2. Continues ambient temperature range: 0–40°C (32–104F); Maximum relative humidity: 95% non–condensing.
 3. Minimum overhead clearance for ventilation above the UPS cabinet is 457mm (18in.).
 4. Minimum 915mm (36in.) clearance in front of the UPS cabinet is required for cooling air intake and servicing space.
 5. Top and bottom cable entries through removable access plates are standard for all configurations. Access plates shall be custom–modified to suit conduit sizes.

METRIC	THIRD ANGLE PROJECTION	EATON CORPORATION		EATON	
DIMENSIONS ARE IN MILLIMETERS AFTER PLATING, DIMENSIONS AND TOLERANCES IN ACCORDANCE WITH ASME Y14.5M-1994. SEE NOTES FOR TOLERANCES.					
DESCRIPTION: 9395P 250/300KVA Dimensional Drawings					
ORIGINATED: ATIF RASHEED	27.04.2015	ECO:	NAME:	REVISION: 001	SIZE: A2
MODIFIED:				STATE: RELEASED	SCALE: 1:14
CHECKED:		DOCUMENT TYPE:	P-110000417		SHEET: 1 OF 5
SAFETY:		AUTOCAD DRAWING			
APPROVED:		EATON CORPORATION - CONFIDENTIAL AND PROPRIETARY NOTICE TO PERSONS RECEIVING THIS DOCUMENT AND/OR TECHNICAL INFORMATION			
<small>THIS DOCUMENT, INCLUDING THE DRAWING AND INFORMATION CONTAINED THEREIN, IS CONFIDENTIAL AND IS THE EXCLUSIVE PROPERTY OF EATON CORPORATION AND IS MERELY ON LOAN AND SUBJECT TO RECALL BY EATON AT ANY TIME. NO PART OF THIS DOCUMENT IS TO BE REPRODUCED OR TRANSMITTED IN ANY FORM OR BY ANY MEANS, ELECTRONIC OR MECHANICAL, INCLUDING PHOTOCOPYING, RECORDING, OR BY ANY INFORMATION STORAGE AND RETRIEVAL SYSTEM, WITHOUT THE PRIOR WRITTEN CONSENT OF EATON. IN THE CASE OF CONFLICTING CONTRACTS, PROVISIONS, THIS NOTICE SHALL GOVERN THE STATUS OF THIS DOCUMENT. © 2011 Eaton Corporation - All Rights Reserved.</small>					

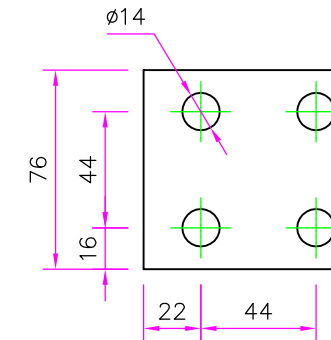
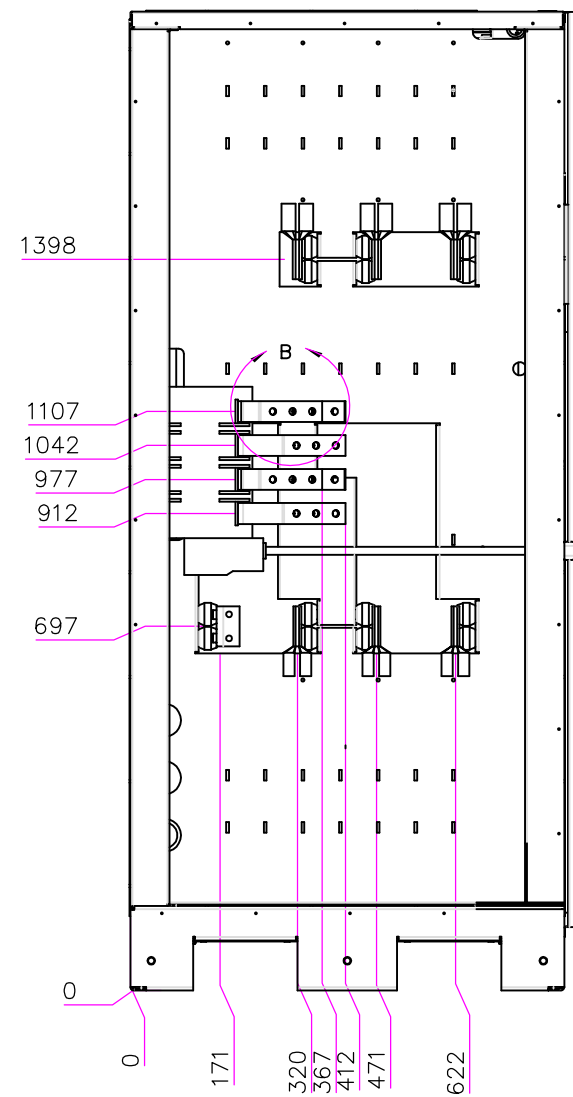
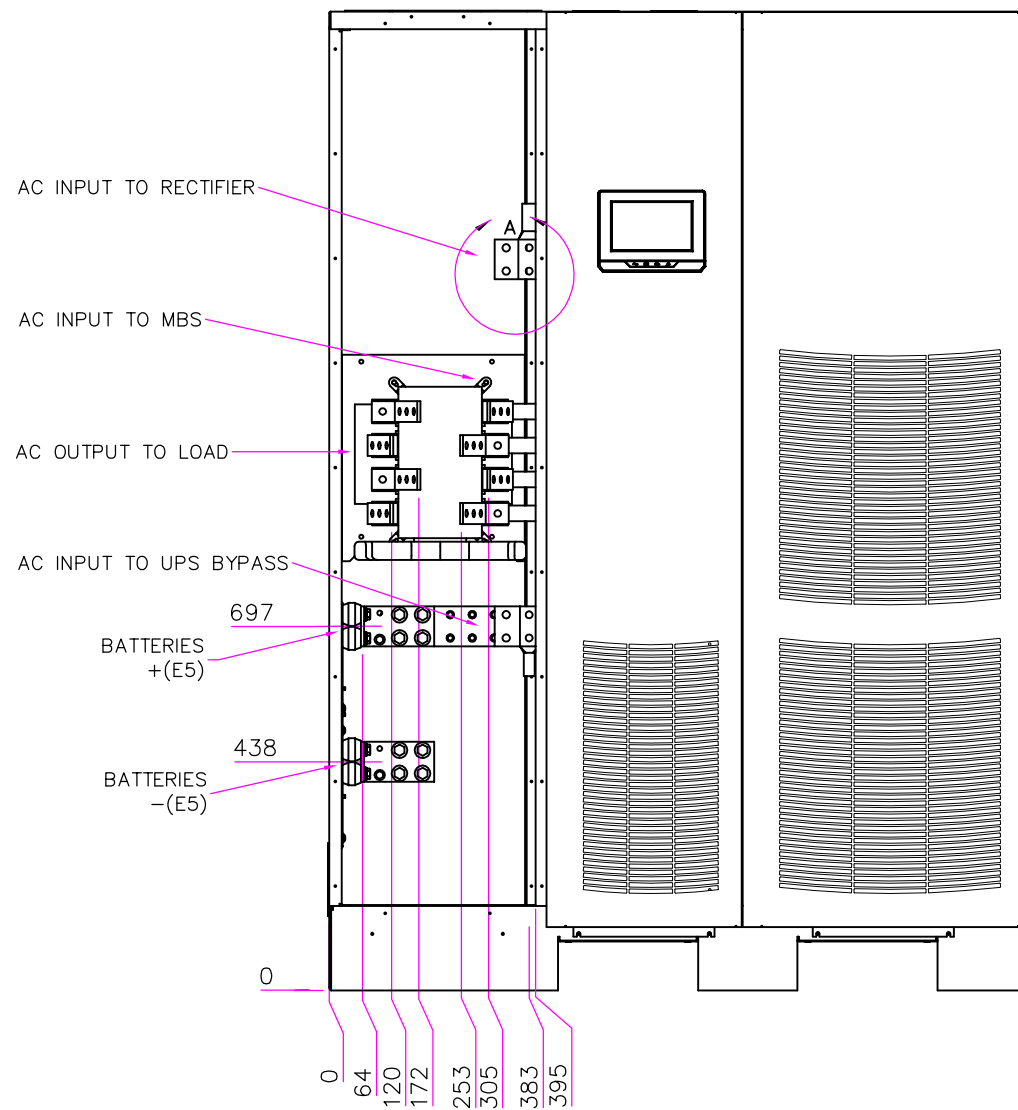

Detail View A
Scale 2:1

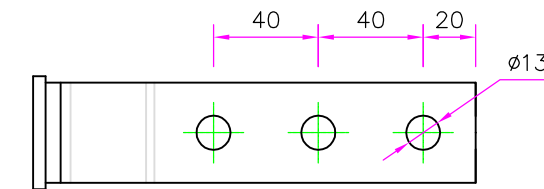

Detail View B
Scale 2:1

Note:
1. The Bus Bars are Tin coated and suitable for both Cu and Al connections.

METRIC		THIRD ANGLE PROJECTION		EATON CORPORATION		EATON	
DIMENSIONS ARE IN MILLIMETERS AFTER PLATING, DIMENSIONS AND TOLERANCES IN ACCORDANCE WITH ASME Y14.5M-1994. SEE NOTES FOR TOLERANCES.							
DESCRIPTION: 9395P 250/300KVA Customer Connections with MBS							
ORIGINATED: ATIF RASHEED	27.04.2015	ECO:	NAME:	REVISION: 001	SIZE: A2		
MODIFIED:		CHECKED:	DOCUMENT TYPE: P-110000417	STATE: RELEASED	SCALE: 1:10		
SAFETY:		APPROVED:			SHEET: 2 OF 5		
<small>EATON CORPORATION - CONFIDENTIAL AND PROPRIETARY NOTICE TO PERSONS RECEIVING THIS DOCUMENT AND/OR TECHNICAL INFORMATION THIS DOCUMENT, INCLUDING THE DRAWING AND INFORMATION CONTAINED THEREIN, IS CONFIDENTIAL AND IS THE EXCLUSIVE PROPERTY OF EATON CORPORATION AND IS LOANED AND SUBJECT TO RECALL BY EATON AT ANY TIME. BY THEIR POSSESSION OF THIS DOCUMENT, THE RECEIPTS ACKNOWLEDGES AND AGREES THAT THIS DOCUMENT CANNOT BE USED IN ANY MANNER HARMFUL TO THE INTERESTS OF EATON AND THAT NO PORTION OF THIS DOCUMENT MAY BE COPIED OR OTHERWISE REPRODUCED WITHOUT THE PRIOR WRITTEN CONSENT OF EATON. IN THE CASE OF CONFLICTING CONTRACTUAL PROVISIONS, THIS NOTICE SHALL GOVERN THE STATUS OF THIS DOCUMENT. © 2011 Eaton Corporation - All Rights Reserved.</small>							

BEHIND COVERS

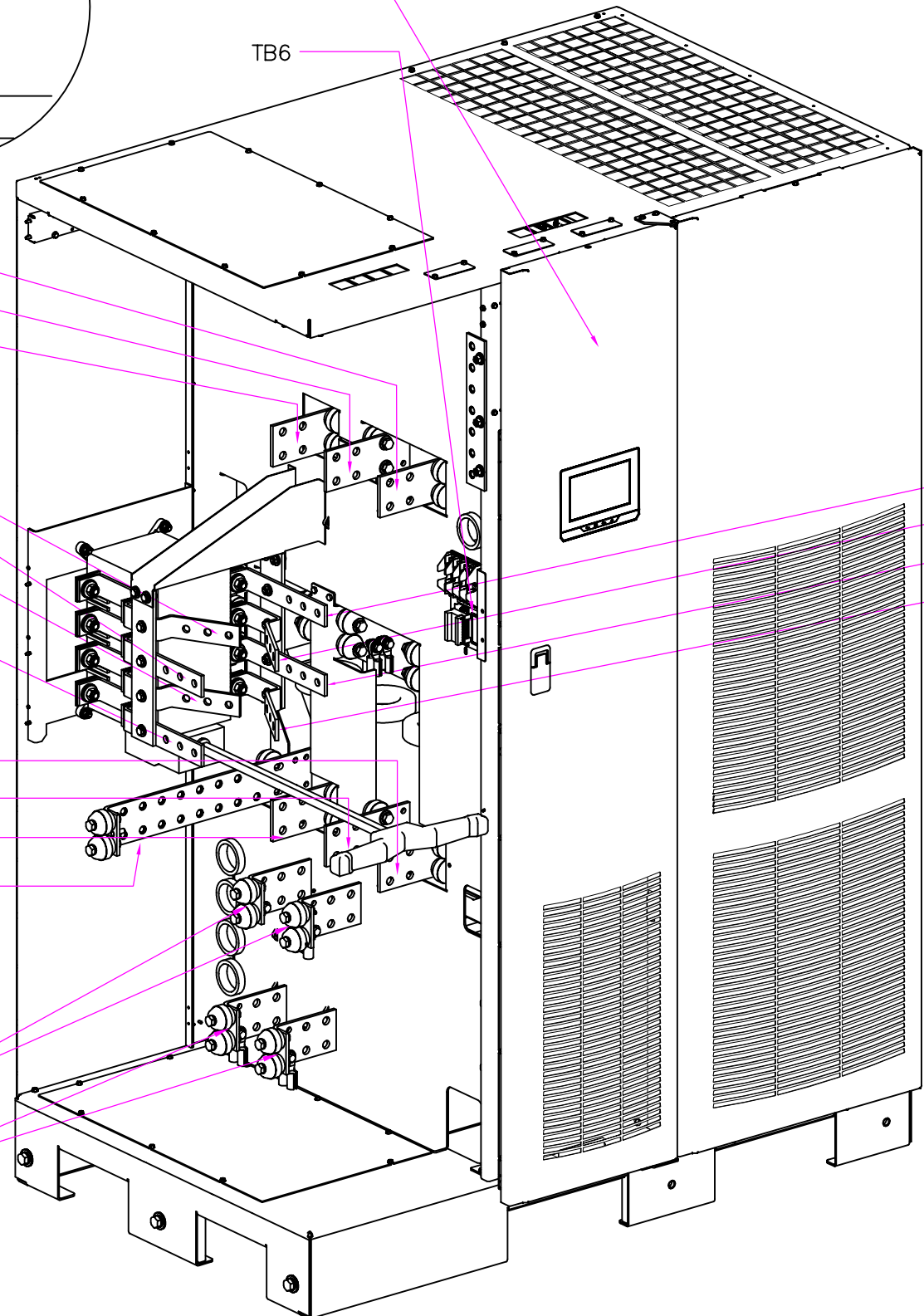
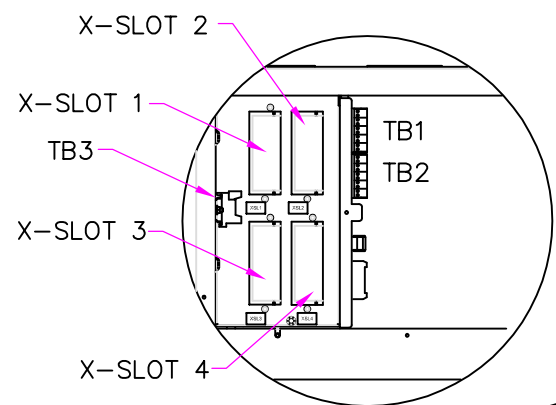

- TB1**
- 1 REMOTE EPO NC
 - 2 REMOTE EPO NO RTN
 - 3 REMOTE EPO NO
 - 4 REMOTE EPO NO RTN
 - 5 BATT AUX
 - 6 BATT AUX RTN
 - 7 BATT SHUNT +
 - 8 BATT SHUNT -
 - 9 K3 NC AUX
 - 10 K3 NC AUX

- TB2**
- 1 PULL CHAIN
 - 2 PULL CHAIN RTN
 - 3 ALRM RELAY NC
 - 4 ALRM RELAY RTN
 - 5 ALRM RELAY NO
 - 6 ALRM RELAY RTN

MECHANICAL BYPASS FEED

- L1(E1)
- L2(E2)
- L3(E3)
- N

- TB3**
- 1 BLDG ALARM 1
 - 2 BLDG ALARM 1 RTN
 - 3 BLDG ALARM 2
 - 4 BLDG ALARM 2 RTN
 - 5 BLDG ALARM 3
 - 6 BLDG ALARM 3 RTN
 - 7 BLDG ALARM 4
 - 8 BLDG ALARM 4 RTN
 - 9 BLDG ALARM 5
 - 10 BLDG ALARM 5 RTN

- TB6**
- 1 BYP ϕ L1
 - 2 BYP ϕ L2
 - 3 BYP ϕ L3
 - 4 BYP N
 - 5 OUT ϕ L1
 - 6 OUT ϕ L2
 - 7 OUT ϕ L3
 - 8 SYNC ϕ L1
 - 9 SYNC ϕ L2
 - 10 SYNC ϕ L3

- AC INPUT**
- L3(E3)
 - L2(E2)
 - L1(E1)

- UPS OUTPUT**
- L1(E9)
 - L2(E10)
 - L3(E11)
 - N

- BYPASS INPUT**
- L3(E8)
 - L2(E7)
 - L1(E6)
 - N(E12)

- BATTERY CONNECTIONS**
- +(E4)
 - (E5)

METRIC		THIRD ANGLE PROJECTION		EATON CORPORATION			
DIMENSIONS ARE IN MILLIMETERS AFTER PLATING, DIMENSIONS AND TOLERANCES IN ACCORDANCE WITH ASME Y14.5M-1994. SEE NOTES FOR TOLERANCES.							
DESCRIPTION: 9395P 250/300KVA Isometric view With MBS							
ORIGINATED: ATIF RASHEED	27.04.2015	ECO:	NAME:	REVISION: 001	SIZE: A2		
MODIFIED:		CHECKED:	DOCUMENT TYPE: P-110000417	STATE: RELEASED	SCALE: 1:16		
SAFETY:		APPROVED:			SHEET: 3 OF 5		
<small>EATON CORPORATION - CONFIDENTIAL AND PROPRIETARY NOTICE TO PERSONS RECEIVING THIS DOCUMENT AND/OR TECHNICAL INFORMATION THIS DOCUMENT, INCLUDING THE DRAWING AND INFORMATION CONTAINED THEREIN, IS CONFIDENTIAL AND IS THE EXCLUSIVE PROPERTY OF EATON CORPORATION AND IS LOANED TO YOU AND SUBJECT TO RECALL BY EATON AT ANY TIME. BY TAKING POSSESSION OF THIS DOCUMENT, THE RECIPIENT ACKNOWLEDGES AND AGREES THAT THIS DOCUMENT CANNOT BE USED IN ANY MANNER WITHOUT THE WRITTEN CONSENT OF EATON. IN THE CASE OF CONFLICTING CONTRACTUAL PROVISIONS, THIS NOTICE SHALL GOVERN THE STATUS OF THIS DOCUMENT. © 2011 Eaton Corporation - All Rights Reserved.</small>							

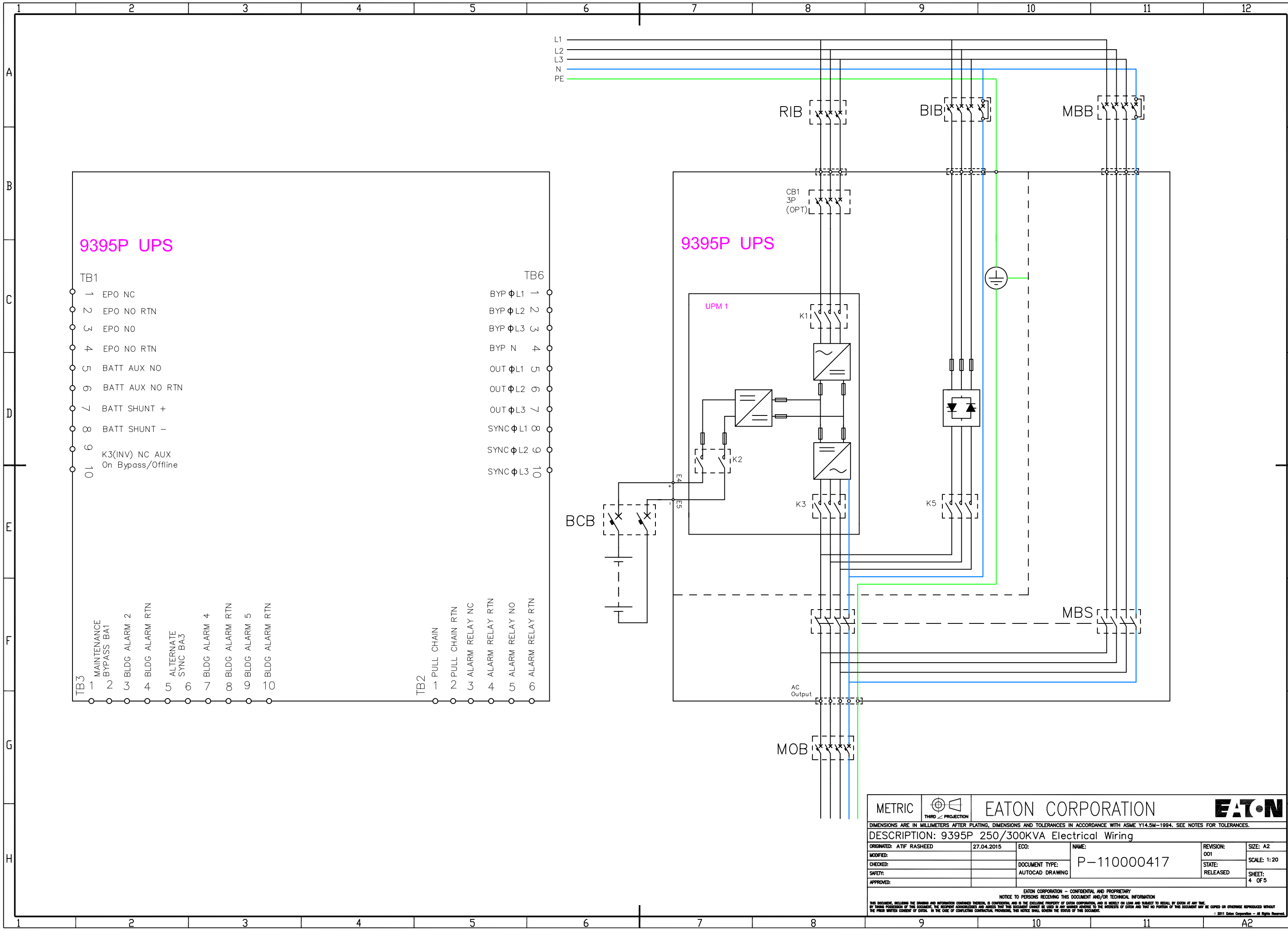

9395P UPS

TB1	1	EPO NC	TB6	1	BYP ϕ L1
	2	EPO NO RTN		2	BYP ϕ L2
	3	EPO NO		3	BYP ϕ L3
	4	EPO NO RTN		4	BYP N
	5	BATT AUX NO		5	OUT ϕ L1
	9	BATT AUX NO RTN		9	OUT ϕ L2
	7	BATT SHUNT +		7	OUT ϕ L3
	8	BATT SHUNT -		8	SYNC ϕ L1
	01	K3(INV) NC AUX On Bypass/Offline		6	SYNC ϕ L2
				10	SYNC ϕ L3
TB3	1	MAINTENANCE BYPASS BA1	TB2	1	PULL CHAIN
	2	BLDG ALARM 2		2	PULL CHAIN RTN
	3	BLDG ALARM RTN		3	ALARM RELAY NC
	4	ALTERNATE SYNC BA3		4	ALARM RELAY RTN
	5	BLDG ALARM 4		5	ALARM RELAY NO
	6	BLDG ALARM RTN		6	ALARM RELAY RTN
	7	BLDG ALARM 5			
	8	BLDG ALARM RTN			
	9	BLDG ALARM RTN			
	10	BLDG ALARM RTN			

METRIC		EATON CORPORATION		EATON	
DIMENSIONS ARE IN MILLIMETERS AFTER PLATING, DIMENSIONS AND TOLERANCES IN ACCORDANCE WITH ASME Y14.5M-1994. SEE NOTES FOR TOLERANCES.					
DESCRIPTION: 9395P 250/300KVA Electrical Wiring					
ORIGINATED: ATIF RASHEED	27.04.2015	ECO:	NAME:	REVISION: 001	SIZE: A2
MODIFIED:				STATE: RELEASED	SCALE: 1:20
CHECKED:		DOCUMENT TYPE:	P-110000417		SHEET: 4 OF 5
SAFETY:					
APPROVED:					
EATON CORPORATION - CONFIDENTIAL AND PROPRIETARY NOTICE TO PERSONS RECEIVING THIS DOCUMENT AND/OR TECHNICAL INFORMATION THIS DOCUMENT, INCLUDING THE DRAWING AND INFORMATION CONTAINED THEREIN, IS CONFIDENTIAL AND IS THE EXCLUSIVE PROPERTY OF EATON CORPORATION, AND IS LOANED AND SUBJECT TO RECALL BY EATON AT ANY TIME. BY THEIR POSSESSION OF THIS DOCUMENT, THE RECEIPTS ACKNOWLEDGES AND AGREES THAT THIS DOCUMENT CANNOT BE USED IN ANY MANNER CONTRARY TO THE INTERESTS OF EATON AND THAT NO PORTION OF THIS DOCUMENT MAY BE COPIED OR OTHERWISE REPRODUCED WITHOUT THE PRIOR WRITTEN CONSENT OF EATON. IN THE CASE OF CONFLICTING CONTRACTUAL PROVISIONS, THIS NOTICE SHALL GOVERN THE STATUS OF THIS DOCUMENT. © 2011 Eaton Corporation - All Rights Reserved.					

9395 P 300 KVA-MBS UPS Site Planning Data

Product Specifications

UPS Rating		AC Input		3P Rectifier Input Breaker (RIB)		3P+Bolted N Bypass Input Breaker (BIB)			4P Inverter AC output Breaker MOB			Battery Breaker (BCB)				Maintenance Bypass Breaker (MBB)	Maintenance Bypass Switch (MBS)		
				Nominal Current	Maximum Current	Nominal Current at 400v Input	Maximum Current at 10% under voltage	Integrated Bypass Fuse	AC Output	Output Current	Short Circuit Current	Auxiliary Switches	Rating	Separate Battery Configuration (UPM Bttery)	Common Battery Configuration (UPS Battery)	Trip Device (Shunt Trip)	Auxiliary Switches	Rating	Rating
KVA	KW	v	A	A	A	A	Type	v	A	A	Qty	VDC	A	A	VDC	Qty	A	A	Qty
250	250	400	380	455	361	398	170M4467 700A	400	435	760	2	600	664	664	48	1	435	435	1
300	275	400	420	500	435	479	170M4467 700A	400	435	760	2	600	733	733	48	1	435	435	1

Notes:

1. Rectifier AC input current calculations: Nominal – 100% load without charging; Maximum – 100% load with maximum charging (Rectifier current limit).
2. Inverter AC output current calculation: At 100% rated output load.
3. The system must be installed on a level floor suitable for computer or electronic equipment.
4. All wiring and installations must be in accordance with applicable National and Local Electric Regulations.
5. AC input to UPS: (3) phases, (1) neutral, (1) ground.
AC output to load: (3) phases, (1) neutral, (1) ground.
DC input from battery to UPS: (1) positive, (1) negative, (1) ground.
6. All breakers should be adjusted according to the specified Ampere values to protect the UPS and installation.
7. For UPS installations that utilizes single feed input, The input breaker should be configured according to the rated rectifier input current..
8. Specifications are subject to change.

METRIC	THIRD ANGLE PROJECTION	EATON CORPORATION		
DIMENSIONS ARE IN MILLIMETERS AFTER PLATING, DIMENSIONS AND TOLERANCES IN ACCORDANCE WITH ASME Y14.5M-1994. SEE NOTES FOR TOLERANCES.				
DESCRIPTION: 9395P 300KVA with MBS Specifications				
ORIGINATED:	ATIF RASHEED	27.04.2015	ECO:	NAME:
MODIFIED:			DOCUMENT TYPE:	P-110000417
CHECKED:			SAFETY:	RELEASED
APPROVED:			REVISION:	001
			STATE:	SCALE: 1:1
			SHEET:	5 OF 5
EATON CORPORATION - CONFIDENTIAL AND PROPRIETARY NOTICE TO PERSONS RECEIVING THIS DOCUMENT AND/OR TECHNICAL INFORMATION THIS DOCUMENT, INCLUDING THE DRAWING AND INFORMATION CONTAINED THEREIN, IS CONFIDENTIAL AND IS THE EXCLUSIVE PROPERTY OF EATON CORPORATION AND IS LOANED TO YOU BY EATON AT ANY TIME. BY YOUR POSSESSION OF THIS DOCUMENT, THE RECIPIENT ACKNOWLEDGES AND AGREES THAT THIS DOCUMENT CANNOT BE USED IN ANY MANNER HARMFUL TO THE INTERESTS OF EATON AND THAT NO PORTION OF THIS DOCUMENT MAY BE COPIED OR OTHERWISE REPRODUCED WITHOUT THE PRIOR WRITTEN CONSENT OF EATON. IN THE CASE OF CONFLICTING CONTRACTUAL PROVISIONS, THIS NOTICE SHALL GOVERN THE STATUS OF THIS DOCUMENT. © 2011 Eaton Corporation - All Rights Reserved.				