

System description

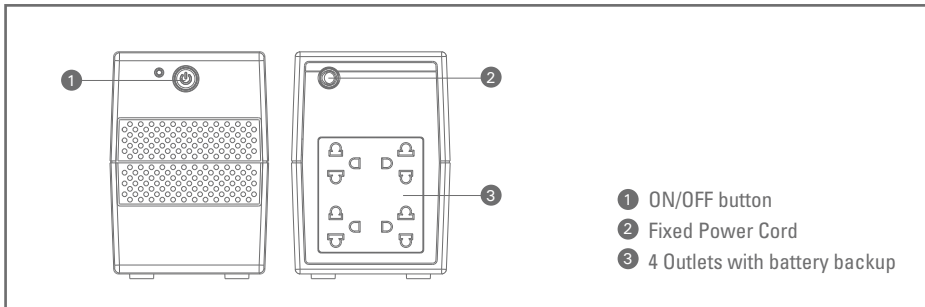

Specifications

Model		Eaton 5V 650	Eaton 5V 850	Eaton 5V 1050
Capacity	VA/W	650VA	850VA	1050VA
		360W	480W	600W
Input	Input voltage range	170-280V		
Output	Output on battery	230V		
	Voltage regulation (bat. mode)	+/-10%		
	Frequency	50Hz or 60Hz		
	Frequency regulation (bat. mode)	+/-1 Hz		
	Output waveform	Simulated sine wave (quasi square wave)		
Battery	Battery type	(1) 12V 7Ah	(1) 12V 9Ah	
	Recharge time	6 hours to 90% after complete discharge		
Communication	USB	No		
Transfer time	Typical	2-6ms typical, 10ms max.		
Indicator	AC mode	Green lighting		
	Battery mode	Green flashing		
Surge suppression	RJ11 and RJ45 protection	No		
Audible alarm	Backup mode	Sounding every 10 seconds		
	Low battery	Sounding every 1 second		
	Overload	Sounding every 0.5 second		
	Fault	Continuously sounding		
Protection	Full protection	Deep discharge, overcharge, and overload protection		
Physical	Dimensions H*W*D	143*100*278		
Weight	Net weight	4.4kg	5.2kg	5.4kg
	Operating environment	0°C - 40°C		
Environment	Noise level	Less than 40dB		
	Back up time	For a 100W load	16min	20min

EAT•N®

Powering Business Worldwide™

5V

650 / 850 / 1050

Uninterruptible Power Supply



Important safety instruction - Read before installing product

Safety of persons

- The UPS has its own internal power source (the battery). Consequently, the power outlets may be energized even if the UPS is disconnected from the AC-power source.
- Dangerous voltage levels are present within the UPS. It should be opened exclusively by qualified service personnel.
- The UPS must be properly earthed. Measurements are required to ensure that the total leakage current of the UPS and the protected equipment does not exceed 3.5mA by checking their characteristics.
- The battery supplied with the UPS contains small amounts of toxic materials. To avoid accidents, the directives listed below must be observed:



- Never burn the battery (risk of explosion).
- Do not attempt to open the battery (the electrolyte is dangerous for the eyes and skin).
- Comply with all applicable regulations for the disposal of the battery.
- Batteries constitute a danger (electrical shock, burns).

The short-circuit current may be very high. Precautions must be taken for all handling: remove watches, rings, bracelets and any other metal objects, use tools with insulated handles.

Product safety

- The UPS connection instructions and operation described in the manual must be followed in the indicated order
- UPS must be connected to a nearby wall outlet that is easily accessible. The UPS can be disconnected from the AC-power source by removing the power cord.
- Check that the indications on the rating plate correspond to your AC-power system and to the actual electrical consumption of all the equipment to be connected to the UPS.
- Never install the UPS near liquids or in an excessively damp environment
- Never let a foreign body penetrate inside the UPS.
- Never block the ventilation grates of the UPS.
- Never expose the UPS to direct sunlight or source of heat.
- If the UPS must be stored prior to installation, storage must be in a dry place.
- The admissible storage temperature range is -10°C to $+40^{\circ}\text{C}$.

Special precautions

- Once installed and connected to the AC power source for the first time, the battery will start to charge. Full charging to obtain the rated battery backup time requires at least 8 hours.
- Before and after the installation, if the UPS remains de-energized for a long period, the UPS must be energized for a period of 24 hours, at least once every 6 months (for a normal storage temperature less than 25°C). This charges the battery, thus avoiding possible irreversible damage.
- During the replacement of the battery module, it is imperative to use the same type and number of element previously mounted in the UPS, in order to maintain an identical level of performance and safety. In case of doubt, don't hesitate to contact our after sales department (for more information, refer to the web site powerquality.eaton.com).



CAUTION – A battery can present a risk of electrical shock and high short circuit current. The following precautions should be observed when working on batteries:

- Remove watches, rings, or other metal objects.
- Use tools with insulated handles.
- Wear rubber gloves and boots.
- Do not lay tools or metal parts on top of batteries.
- Disconnect charging source prior to connecting or disconnecting battery terminals.
- Determine if battery is inadvertently grounded. If inadvertently grounded, remove source from ground. Contact with any part of a grounded battery can result in electrical shock. The likelihood of such shock can be reduced if such grounds are removed during installation and maintenance.

Unpacking and contents check

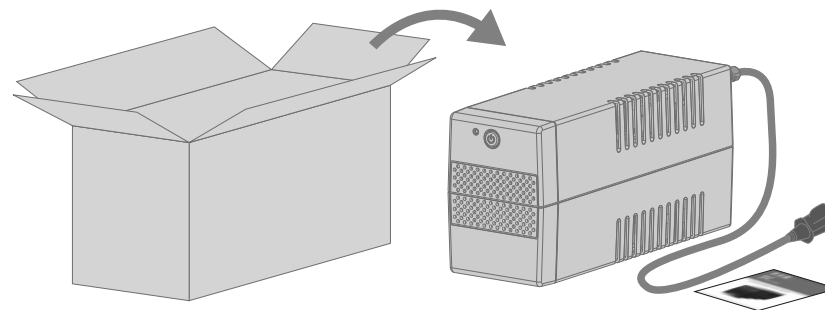

Quickstart

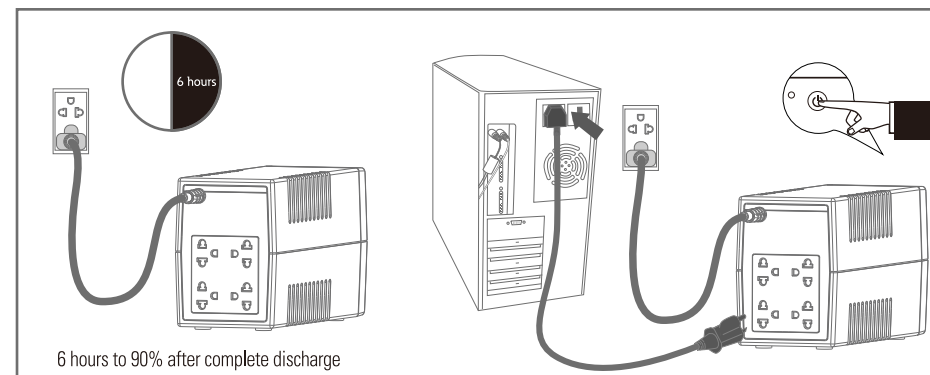

Troubleshooting

Symptom	Possible cause	Remedy
No LED display on the front panel	1. Battery weak 2. Battery defect or aging 3. Power switch is not pressed	1. Charge battery up to 8 hours 2. Replace with the same type of battery 3. Press the power switch again
Alarm buzzer beeps continuously when AC supply is normal	Overload of the UPS	Verify that the load matches the UPS capability specified in the spec
When power failure, back-up time is shorten	1. Overload of the UPS 2. Battery weak 3. Battery defect or aging	1. Remove some noncritical load 2. Charge battery up to 8 hours 3. Replace with the same type of battery
AC supply normal but LED is flashing	Power cord is loose	Reconnect the power cord properly

