

| ITEM # | NAME | QTY |
|--------|-----------------|-----|
| 1 | TRAY ASM | 1 |
| 2 | REAR ASM | 2 |
| 3 | LEFT EAR | 2 |
| 4 | RIGHT EAR | 2 |
| 5 | M4X6 TORX SCREW | 16 |
| 6 | | |

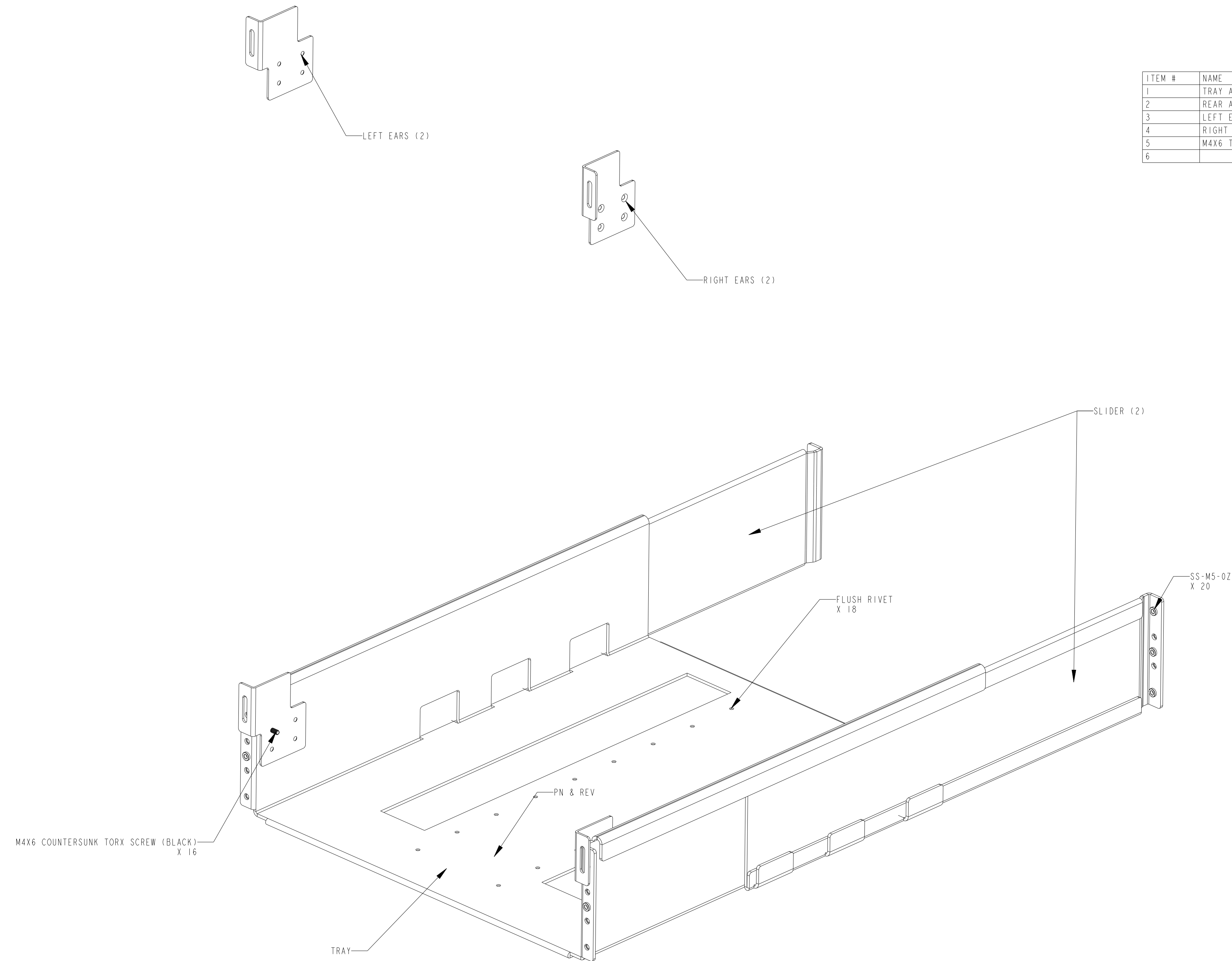

SCALE 0.400

| | | | | | |
|---|-------------------|--|--|----------------------------|---------|
| METRIC | | THIRD ANGLE PROJECTION | EATON CORPORATION, ELECTRICAL | EATON | SIZE: D |
| DESCRIPTION: 9PXM, RAIL TRAY | | | | | |
| MODIFIED BY: J. Yan | DATE: 15-May-2018 | UNLESS OTHERWISE SPECIFIED TOLERANCES ON DIMENSIONS ARE: | | SCALE: 0.250 | |
| ECD: ECD-140047 | STATE: Release | ANGLES: ±1/2° | DECIMALS: 0.X: ±0.75 X, (FOR X < 31): ±1 | DO NOT SCALE | |
| | | HOLES: ±0.13 | 0.XX: ±0.25 X, (FOR X > 31): ±2.5 | DRAWING OR CHANGE MANUALLY | |
| | | DIMENSIONS ARE IN MILLIMETERS (INCHES) AND AFTER PLATING | | | |
| PRO-ENGINEER GENERATED | | PART NAME: P-157002204 | REVISION: 44 | SHEET: 1 of 5 | |
| <small>EATON CORPORATION - CONFIDENTIAL AND PROPRIETARY NOTICE TO PERSONS RECEIVING THIS DOCUMENT AND/OR TECHNICAL INFORMATION THIS DOCUMENT, INCLUDING THE DRAWING AND INFORMATION CONTAINED THEREON, IS CONFIDENTIAL AND IS THE EXCLUSIVE PROPERTY OF EATON CORPORATION, AND IS HEREBY ON LOAN AND SUBJECT TO SECURE BY EATON AT ANY TIME. BY TAKING POSSESSION OF THIS DOCUMENT, THE RECIPIENT ACKNOWLEDGES AND AGREES THAT THIS DOCUMENT CANNOT BE USED IN ANY MANNER ADVERSE TO THE INTERESTS OF EATON, AND THAT NO PORTION OF THIS DOCUMENT MAY BE COPIED OR OTHERWISE REPRODUCED WITHOUT THE PRIOR WRITTEN CONSENT OF EATON. IN THE CASE OF CONFLICTING CONTRACTUAL PROVISIONS, THIS NOTICE SHALL GOVERN THE STATUS OF THIS DOCUMENT. © 2008 Eaton Corporation. All Rights Reserved.</small> | | | | | |

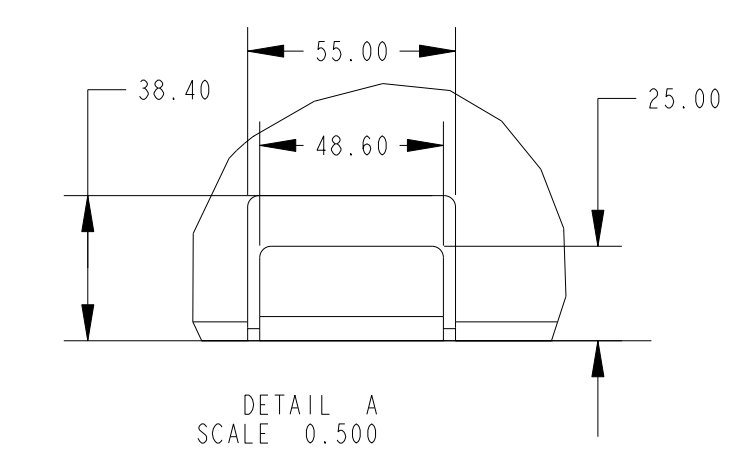
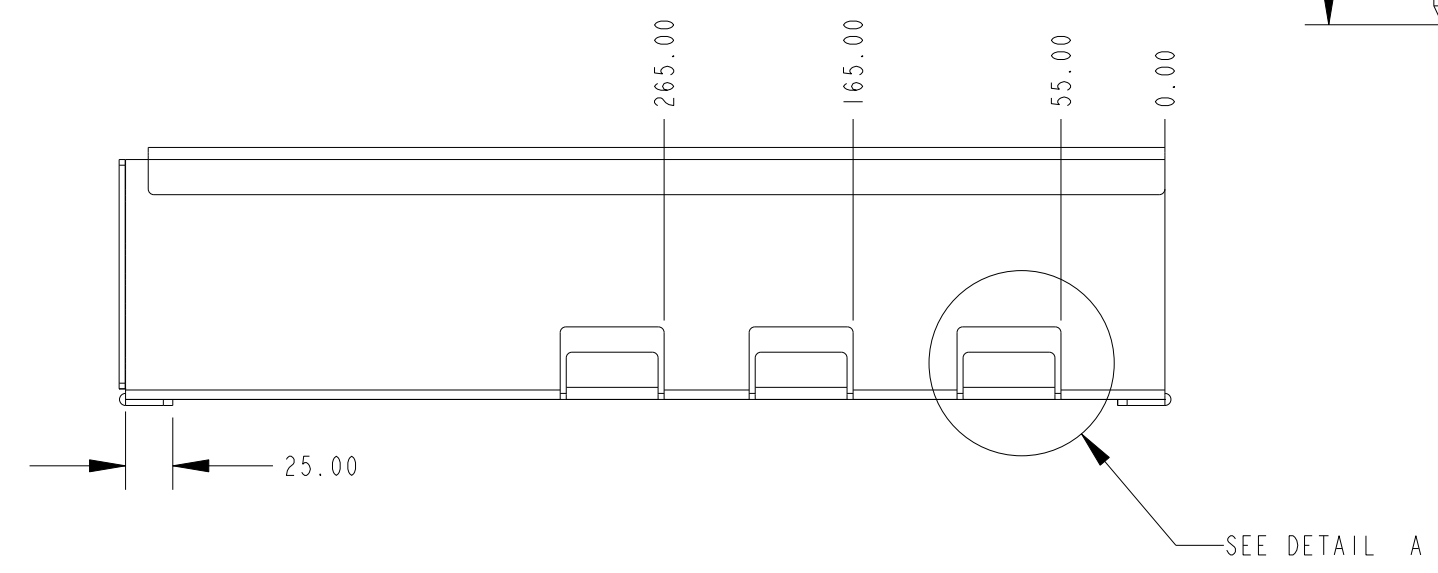
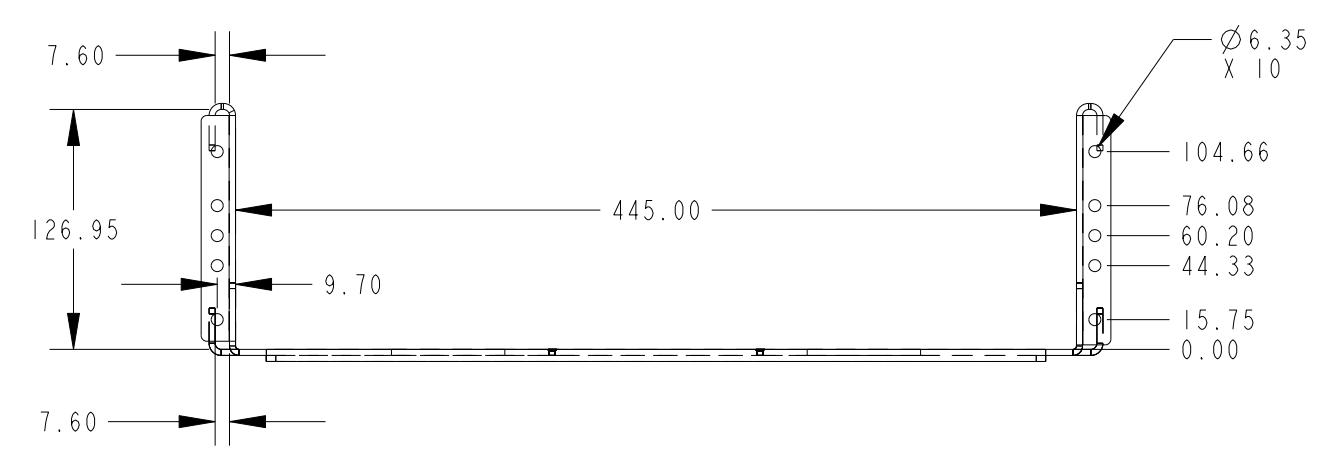
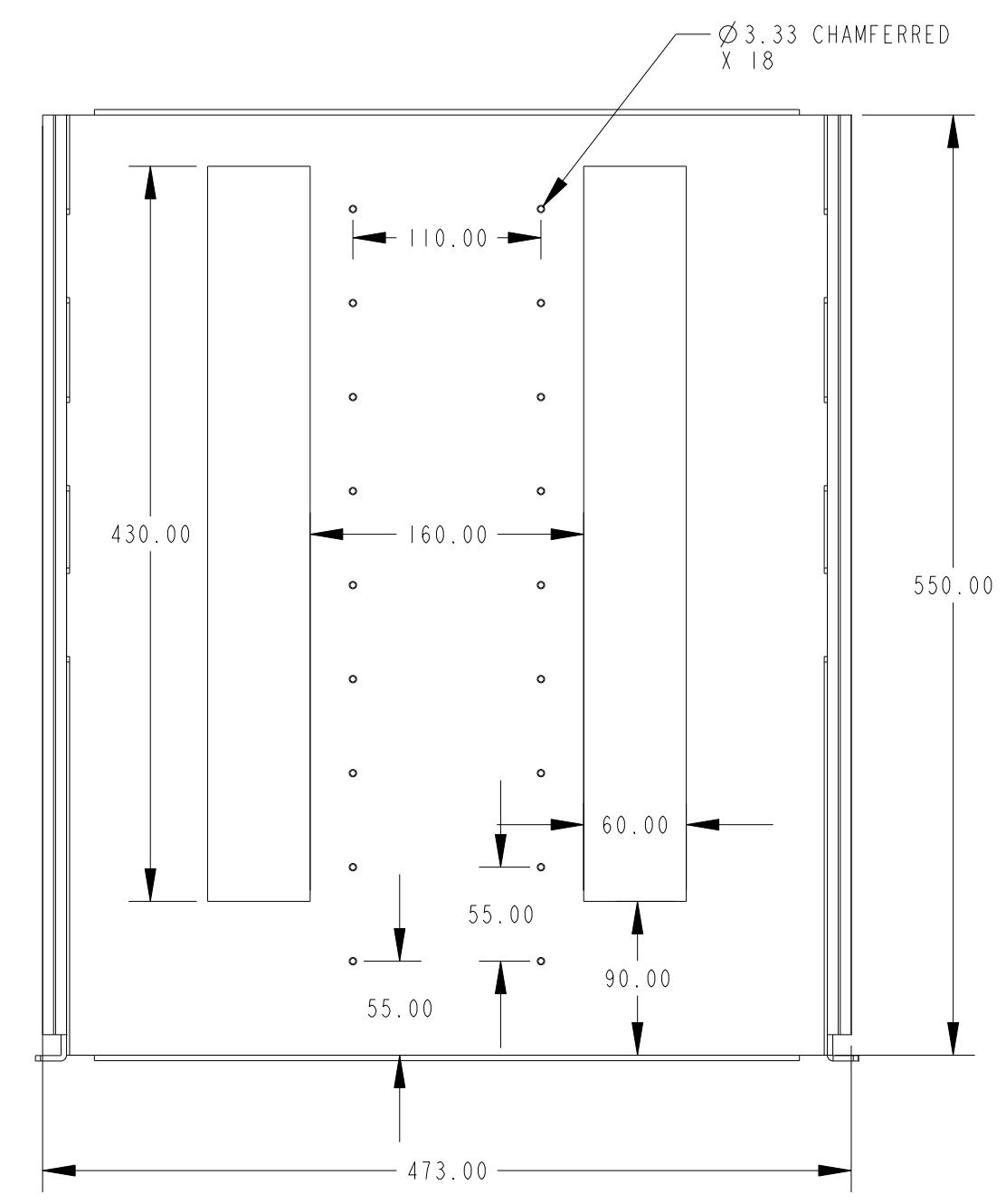
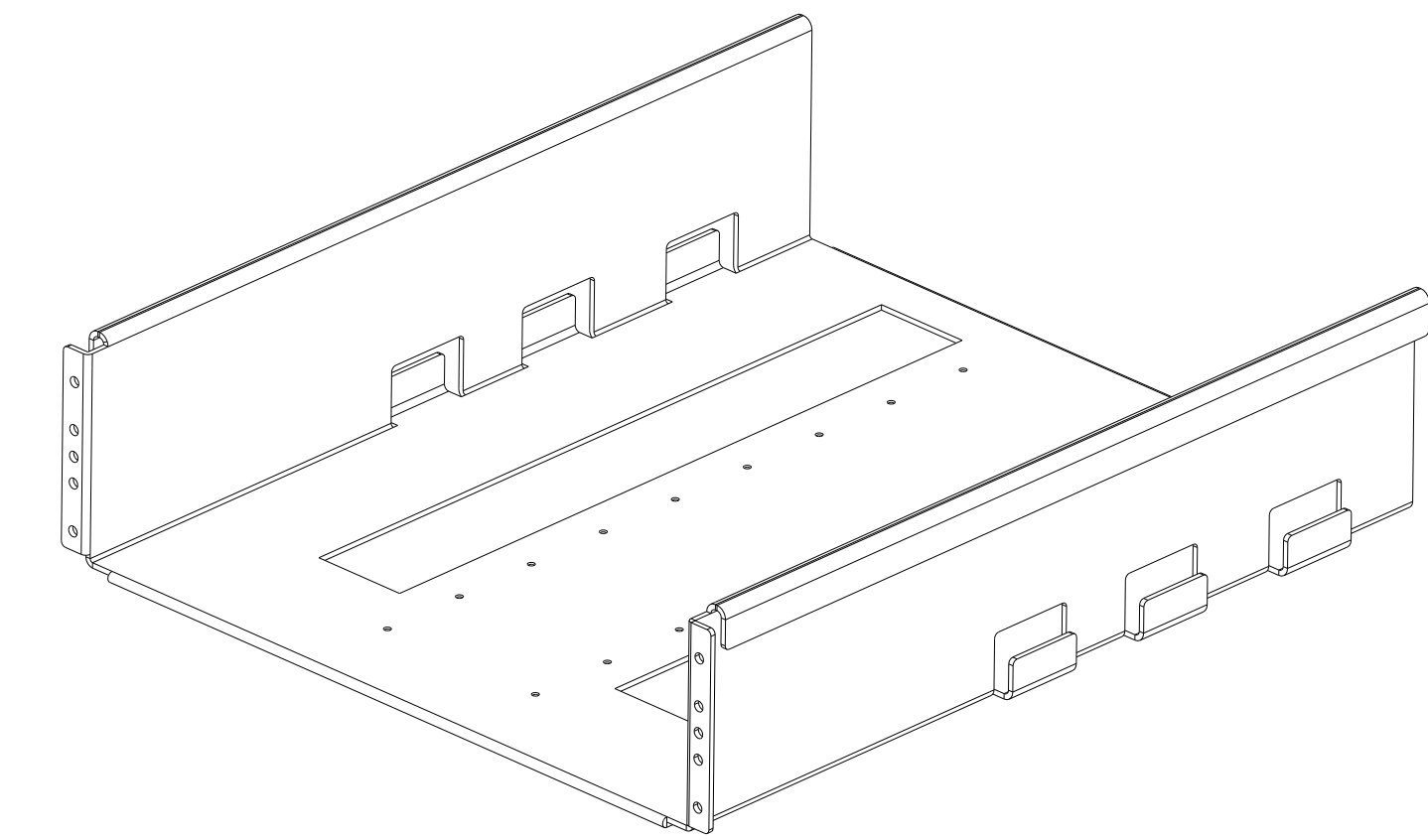

- NOTES:
1. MATERIAL: 3MM (11 GAUGE) G90 GALVANIZED STEEL PER ASTM A653 CS TYPE B OR EQUIVALENT, OR HOT DIP ZINC COATED STEEL PER EN 10142 DX51D+Z275MAC.
 2. TOLERANCES UNLESS OTHERWISE SPECIFIED: LENGTHS, HOLE TO EDGE OR EDGE TO EDGE: $\pm 0.5\text{MM}$. BETWEEN ANY TWO HOLES IN SAME PLANE: $\pm 0.25\text{MM}$. ANGLES: $\pm 0.5^\circ$. DIAMETERS: $\pm 0.13\text{MM}$. TOLERANCE IS NON-ACCUMULATIVE.
 3. MATERIALS MUST COMPLY WITH EU DIRECTIVE 2002/95/EC, ROHS COMPLIANT PER EATON SPECIFICATION 164080496.
 4. DOCUMENTATION CERTIFYING MATERIALS AND COMPONENTS ARE ROHS COMPLIANT SHALL BE AVAILABLE UPON REQUEST.
 5. INSIDE BEND RADIUS: $1.5\text{MM} \pm 0.5\text{MM}$.
 6. METAL STAMP CUSTOMER PART NUMBER AND REVISION USING 3MM HIGH CHARACTERS. LOCATION PER VENDOR.
 7. FINISH: NONE REQUIRED. EDGES SHALL BE FREE OF BURRS.
 8. OK FOR MANUFACTURING TRANSFER FROM PRO-E 3D FILE.

| | | | | | |
|------------------------|-------------------|--|-------------------------------|---|---------|
| METRIC | | THIRD ANGLE PROJECTION | EATON CORPORATION, ELECTRICAL | EATON | SIZE: D |
| DESCRIPTION: TRAY | | | | | |
| MODIFIED BY: J. Yan | DATE: 15-May-2010 | UNLESS OTHERWISE SPECIFIED TOLERANCES ARE: | | SCALE: 0.250 | |
| ECD: ECD-140047 | STATE: Release | ANGLES: $\pm 0.5^\circ$ | | DECIMALS: 0.X: ± 0.75 X: 1 FOR X < 31: ± 1 DO NOT SCALE | |
| PRO-ENGINEER GENERATED | | PART NAME: P-157002204 | | REVISION: 44 | |
| SHEET: 2 OF 5 | | DRAWING OR CHANGE MANUALLY | | DIMENSIONS ARE IN MILLIMETERS (INCHES) AND AFTER PLATING | |

EATON CORPORATION - CONFIDENTIAL AND PROPRIETARY NOTICE TO PERSONS RECEIVING THIS DOCUMENT AND/OR TECHNICAL INFORMATION THIS DOCUMENT, INCLUDING THE DRAWING AND INFORMATION CONTAINED THEREIN, IS THE EXCLUSIVE PROPERTY OF EATON CORPORATION, AND IS MADE ON LOAN AND SUBJECT TO RECALL BY EATON AT ANY TIME. BY TAKING POSSESSION OF THIS DOCUMENT, THE RECIPIENT ACKNOWLEDGES AND AGREES THAT THIS DOCUMENT CANNOT BE USED IN ANY MANNER ADVERSE TO THE INTERESTS OF EATON, AND THAT NO PORTION OF THIS DOCUMENT MAY BE COPIED OR OTHERWISE REPRODUCED WITHOUT THE PRIOR WRITTEN CONSENT OF EATON. IN THE CASE OF CONFLICTING CONTRACTUAL PROVISIONS, THIS NOTICE SHALL GOVERN THE STATUS OF THIS DOCUMENT. © 2008 Eaton Corporation. All Rights Reserved.

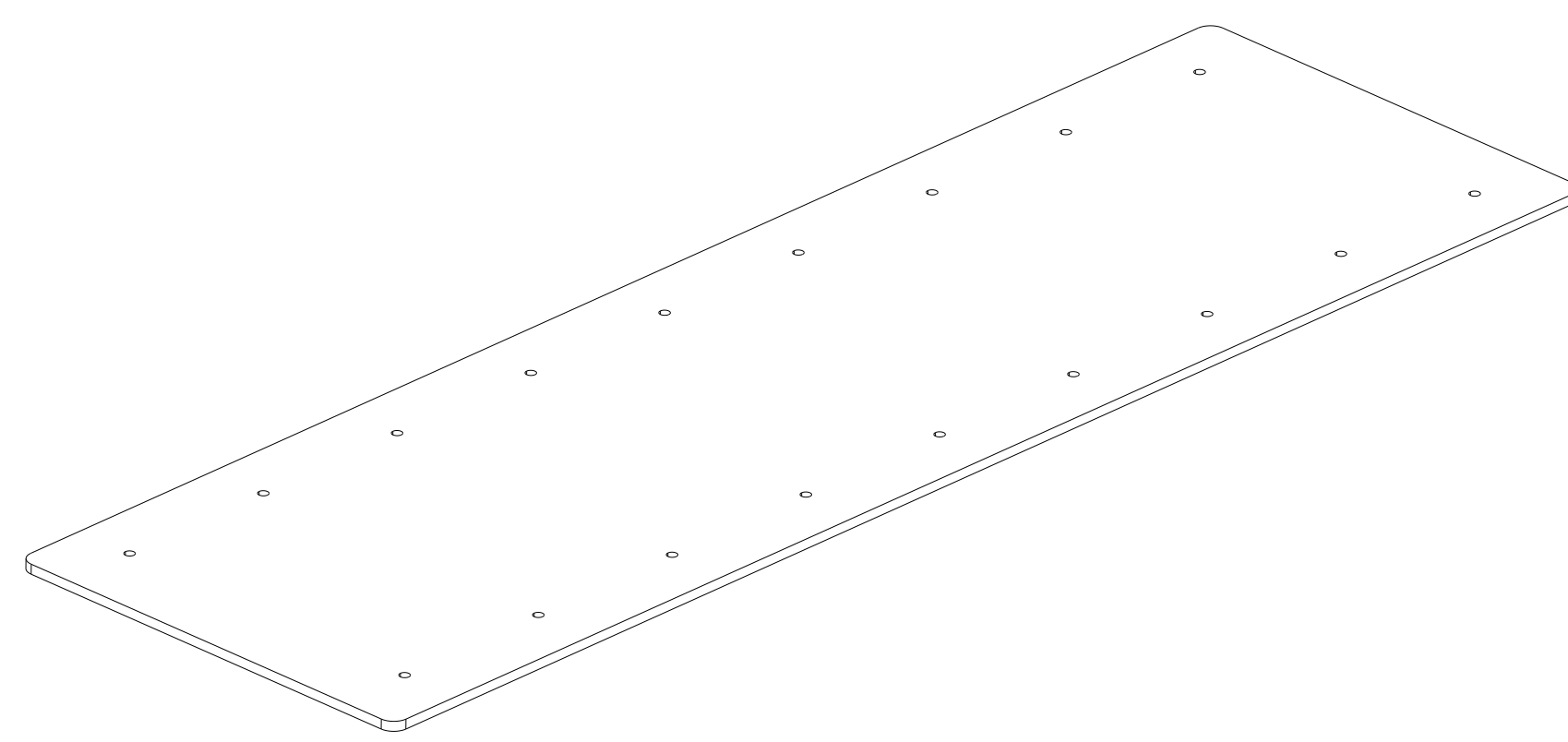

- NOTES:
1. MATERIAL: 3MM (11 GAUGE) G90 GALVANIZED STEEL PER ASTM A653 CS TYPE B OR EQUIVALENT, OR HOT DIP ZINC COATED STEEL PER EN 10142 DX51D+Z275MAC.
 2. TOLERANCES UNLESS OTHERWISE SPECIFIED:
LENGTHS, HOLE TO EDGE OR EDGE TO EDGE: $\pm 0.5\text{MM}$.
BETWEEN ANY TWO HOLES IN SAME PLANE: $\pm 0.25\text{MM}$.
ANGLES: $\pm 0.5^\circ$, DIAMETERS $\pm 0.13\text{MM}$.
TOLERANCE IS NON-ACCUMULATIVE.
 3. MATERIALS MUST COMPLY WITH EU DIRECTIVE 2002/95/EC, ROHS COMPLIANT PER EATON SPECIFICATION 164080496.
 4. DOCUMENTATION CERTIFYING MATERIALS AND COMPONENTS ARE ROHS COMPLIANT SHALL BE AVAILABLE UPON REQUEST.
 5. INSIDE BEND RADIUS: $1.5\text{MM} \pm 0.5\text{MM}$.
 6. METAL STAMP CUSTOMER PART NUMBER AND REVISION USING 3MM HIGH CHARACTERS, LOCATION PER VENDOR.
 7. FINISH: NONE REQUIRED, EDGES SHALL BE FREE OF BURRS.
 8. OK FOR MANUFACTURING TRANSFER FROM PRO-E 3D FILE.

| | | | | | | |
|---|-------------------|--|-------------------------------|----------------------------|----------------------------|---------|
| METRIC | | THIRD ANGLE PROJECTION | EATON CORPORATION, ELECTRICAL | | EATON | SIZE: D |
| DESCRIPTION: BOTTOM PLATE | | | | | | |
| MODIFIED BY: J. Yan | DATE: 15-May-2018 | UNLESS OTHERWISE SPECIFIED TOLERANCES ON DIMENSIONS ARE: | | | SCALE: 0.500 | |
| ECD: ECD-140047 | STATE: Release | ANGLES: $\pm 1/2^\circ$ | DECIMALS: 0.X: ± 0.75 | X: (FOR X < 31): ± 1 | DO NOT SCALE | |
| | | HOLES: $\varnothing \pm 0.13$ | 0.XX: ± 0.25 | X: (FOR X > 31): ± 2.5 | DRAWING OR CHANGE MANUALLY | |
| PRO-ENGINEER GENERATED | | PART NAME: P-157002204 | REVISION: 44 | SHEET: 3 of 5 | | |
| <small>EATON CORPORATION - CONFIDENTIAL AND PROPRIETARY NOTICE TO PERSONS RECEIVING THIS DOCUMENT AND/OR TECHNICAL INFORMATION THIS DOCUMENT, INCLUDING THE DRAWING AND INFORMATION CONTAINED THEREON, IS CONFIDENTIAL AND IS THE EXCLUSIVE PROPERTY OF EATON CORPORATION, AND IS HEREBY ON LOAN AND SUBJECT TO RECALL BY EATON AT ANY TIME. BY TAKING POSSESSION OF THIS DOCUMENT, THE RECIPIENT ACKNOWLEDGES AND AGREES THAT THIS DOCUMENT CANNOT BE USED IN ANY MANNER ADVERSE TO THE INTERESTS OF EATON, AND THAT NO PORTION OF THIS DOCUMENT MAY BE COPIED OR OTHERWISE REPRODUCED WITHOUT THE PRIOR WRITTEN CONSENT OF EATON. IN THE CASE OF CONFLICTING CONTRACTUAL PROVISIONS, THIS NOTICE SHALL GOVERN THE STATUS OF THIS DOCUMENT. © 2008 Eaton Corporation. All Rights Reserved.</small> | | | | | | |

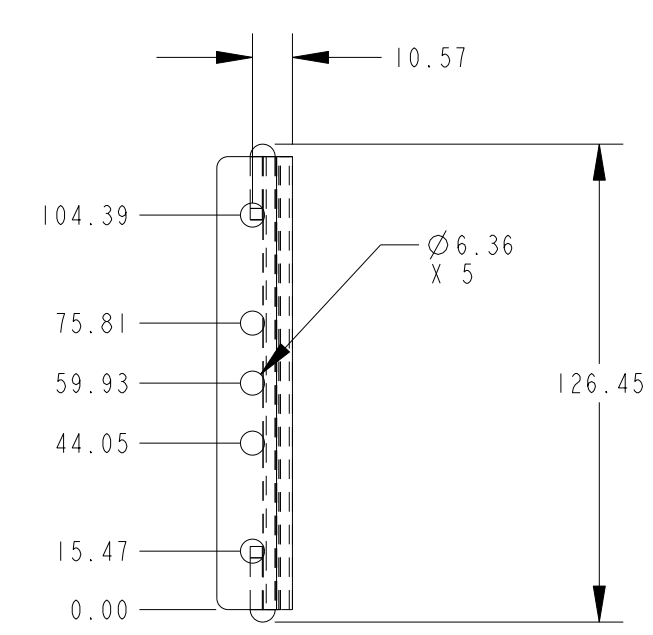
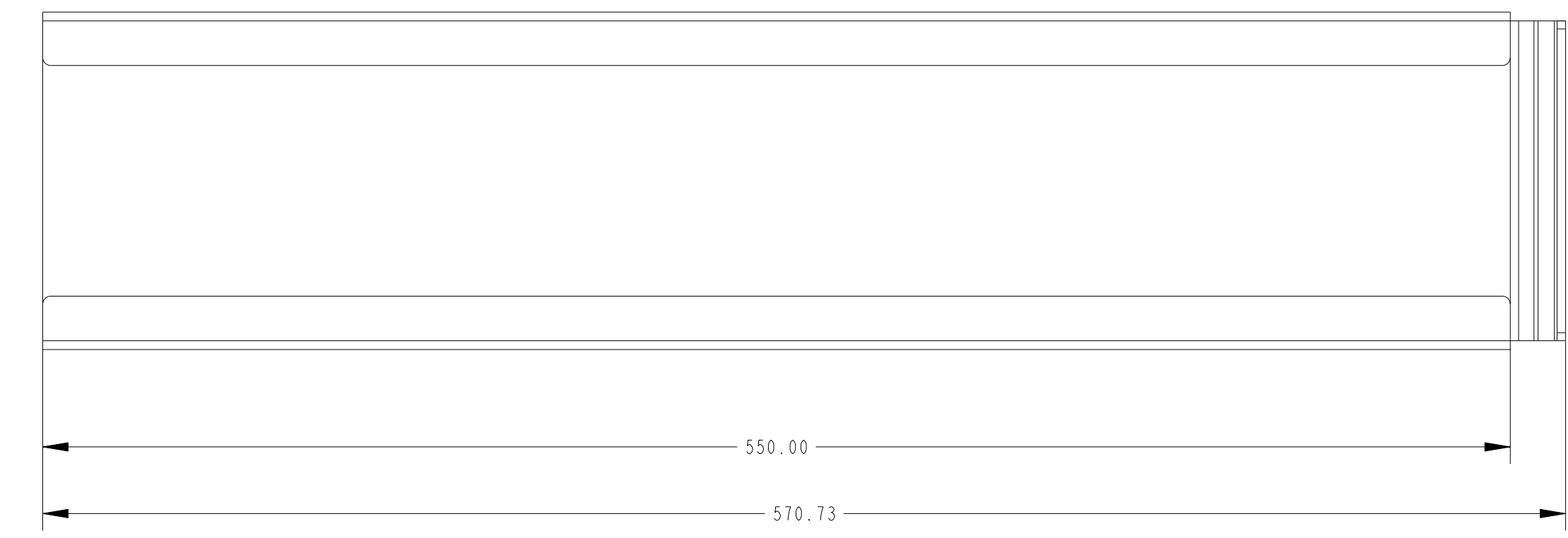
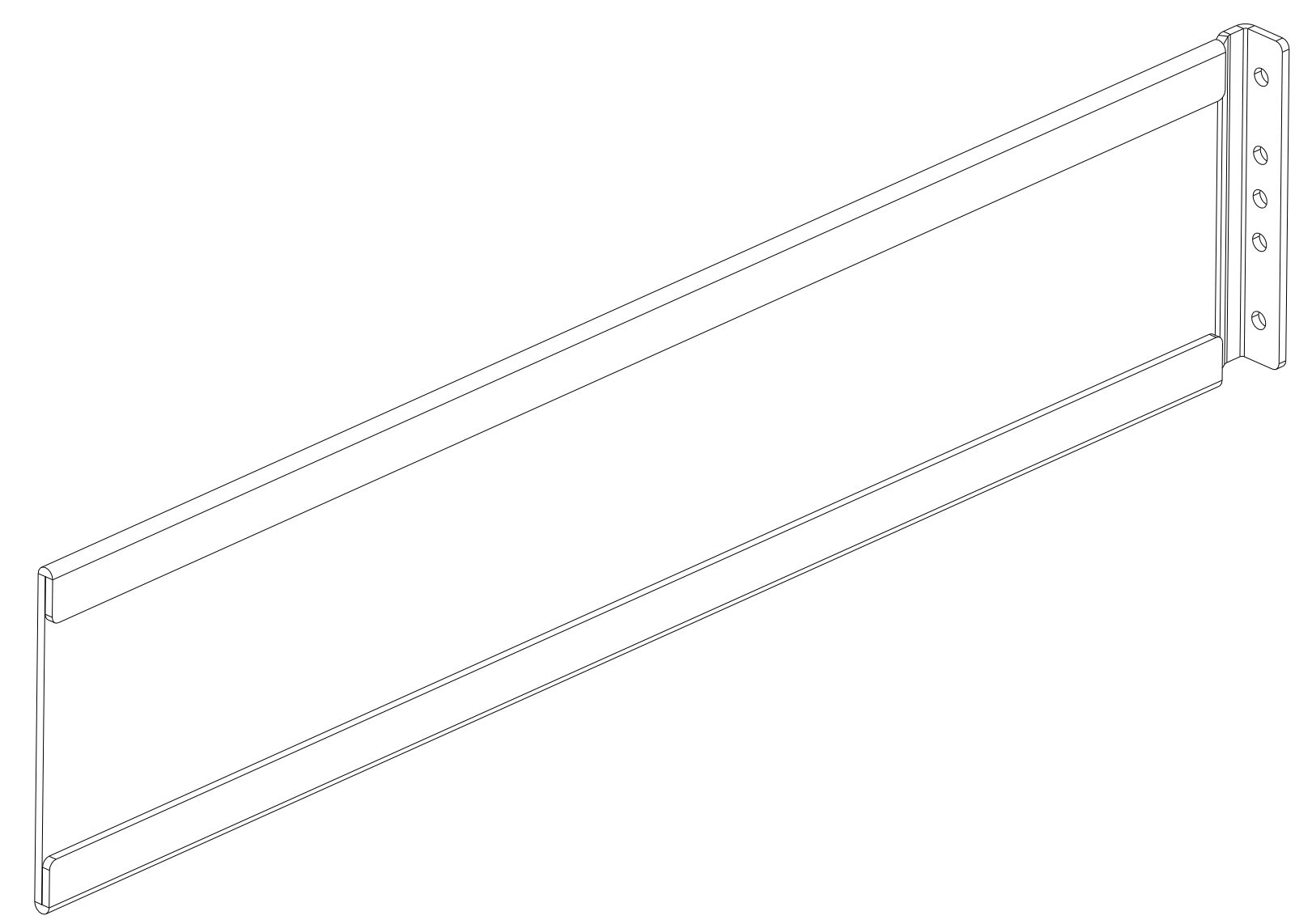

- NOTES:
1. MATERIAL: 3MM (11 GAUGE) G90 GALVANIZED STEEL PER ASTM A653 CS TYPE B OR EQUIVALENT, OR HOT DIP ZINC COATED STEEL PER EN 10142 DX51D+Z275MAC.
 2. TOLERANCES UNLESS OTHERWISE SPECIFIED: LENGTHS, HOLE TO EDGE OR EDGE TO EDGE: ±0.5MM. BETWEEN ANY TWO HOLES IN SAME PLANE: ±0.25MM. ANGLES: ±0.5°. DIAMETERS ±0.13MM, TOLERANCE IS NON-ACCUMULATIVE.
 3. MATERIALS MUST COMPLY WITH EU DIRECTIVE 2002/95/EC. RoHS COMPLIANT PER EATON SPECIFICATION 164080496.
 4. DOCUMENTATION CERTIFYING MATERIALS AND COMPONENTS ARE RoHS COMPLIANT SHALL BE AVAILABLE UPON REQUEST.
 5. INSIDE BEND RADIUS: 1.5MM ±0.5MM.
 6. METAL STAMP CUSTOMER PART NUMBER AND REVISION USING 3MM HIGH CHARACTERS. LOCATION PER VENDOR.
 7. FINISH: NONE REQUIRED, EDGES SHALL BE FREE OF BURRS.
 8. OK FOR MANUFACTURING TRANSFER FROM PRO-E 3D FILE.

| | | | | | | |
|------------------------|-------------------|--|--|---------------------|----------------------------|--------------|
| METRIC | | THIRD ANGLE PROJECTION | EATON CORPORATION, ELECTRICAL | | EATON | SIZE: D |
| DESCRIPTION: SLIDER | | | | | | |
| MODIFIED BY: J. Yan | DATE: 15-May-2010 | UNLESS OTHERWISE SPECIFIED TOLERANCES ON DIMENSIONS ARE: | | | SCALE: 0.500 | DO NOT SCALE |
| ECD: ECD-140067 | STATE: Release | ANGLES: ±1/2° | DECIMALS: 0.X: ±0.75 | X: (FOR X < 31): ±1 | DRAWING OR CHANGE MANUALLY | |
| PRO-ENGINEER GENERATED | | HOLE: ±0.13 | DIMENSIONS ARE IN MILLIMETERS (INCHES) AND AFTER PLATING | | SHEET: 4 of 5 | |
| PART NAME: P-157002204 | | REVISION: 04 | | | | |

EATON CORPORATION - CONFIDENTIAL AND PROPRIETARY NOTICE TO PERSONS RECEIVING THIS DOCUMENT AND/OR TECHNICAL INFORMATION THIS DOCUMENT, INCLUDING THE DRAWING AND INFORMATION CONTAINED THEREON, IS CONFIDENTIAL AND IS THE EXCLUSIVE PROPERTY OF EATON CORPORATION, AND IS HEREBY ON LOAN AND SUBJECT TO REGAL BY EATON AT ANY TIME. BY TAKING POSSESSION OF THIS DOCUMENT, THE RECIPIENT ACKNOWLEDGES AND AGREES THAT THIS DOCUMENT CANNOT BE USED IN ANY MANNER ADVERSE TO THE INTERESTS OF EATON, AND THAT NO PORTION OF THIS DOCUMENT MAY BE COPIED OR OTHERWISE REPRODUCED WITHOUT THE PRIOR WRITTEN CONSENT OF EATON. IN THE CASE OF CONFLICTING CONTRACTUAL PROVISIONS, THIS NOTICE SHALL GOVERN THE STATUS OF THIS DOCUMENT. © 2008 Eaton Corporation. All Rights Reserved.

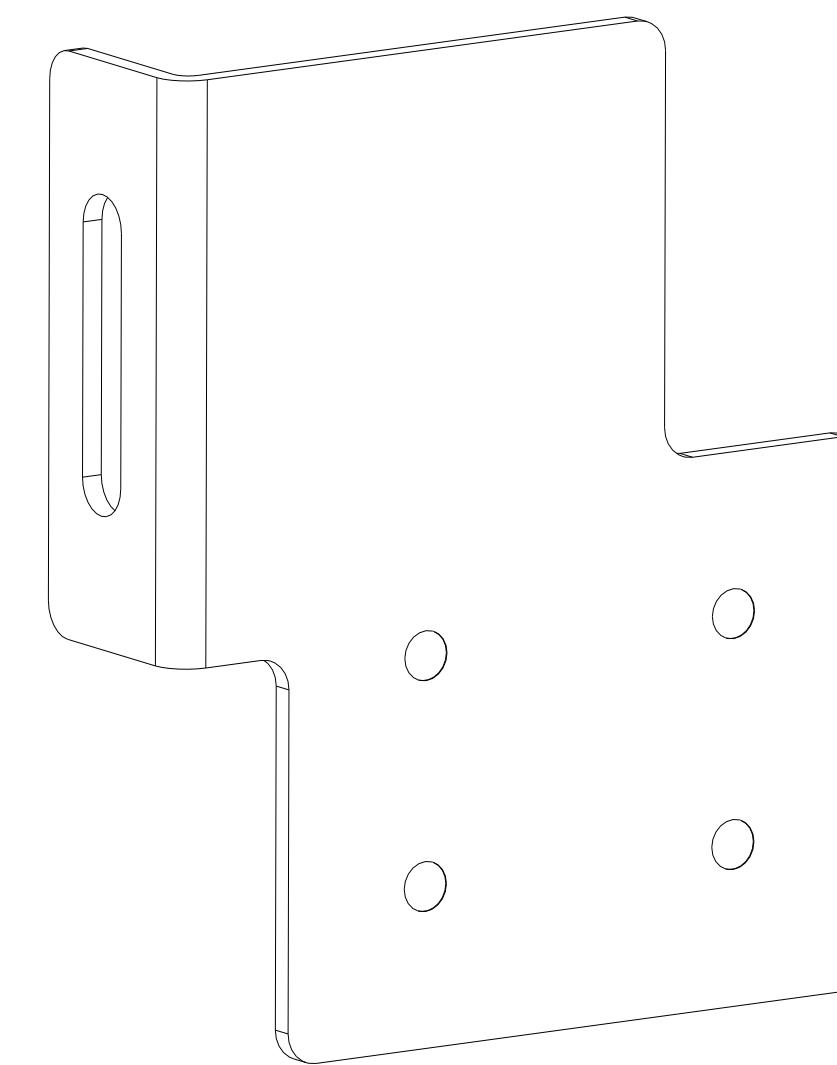
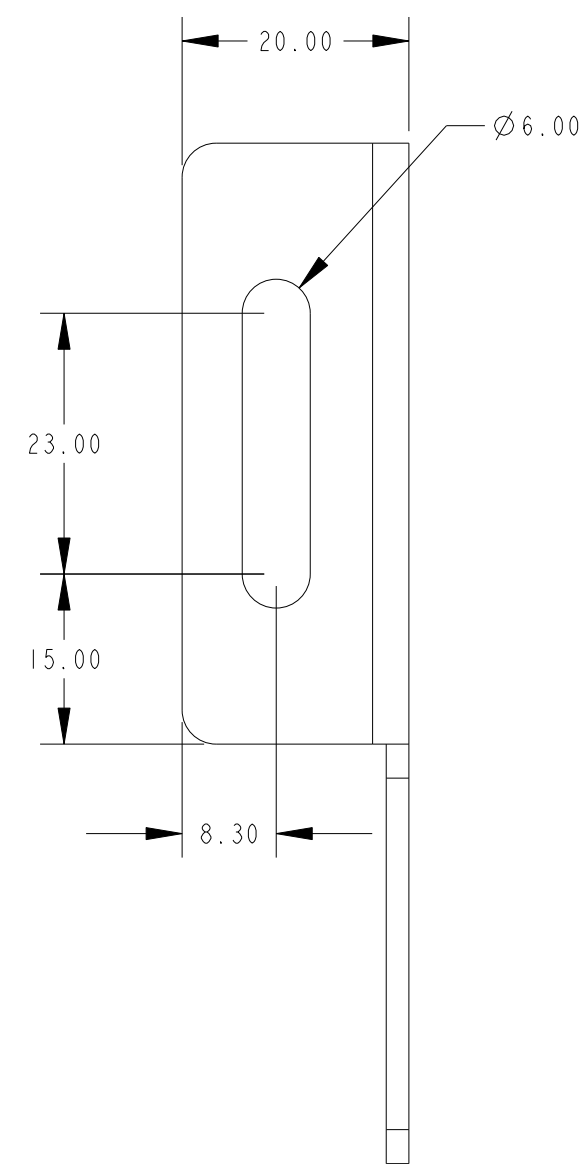
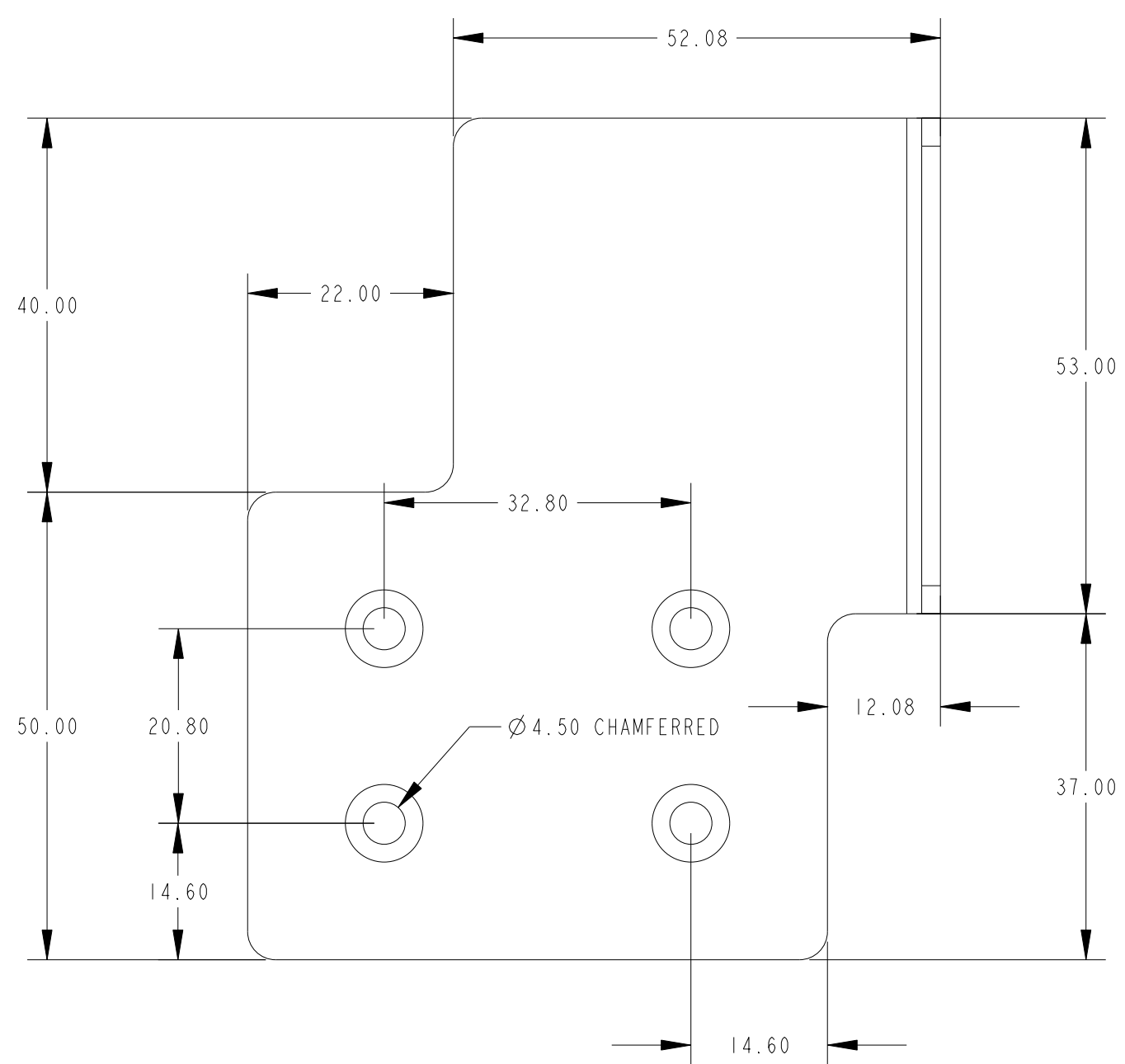

SHOWN LEFT EARS
RIGHT EARS ARE MIRRORED

NOTES:

1. MATERIAL: 2.0MM (14 GAUGE) COLD ROLLED STEEL PER ASTM A1008 CS TYPE B.
2. TOLERANCES UNLESS OTHERWISE SPECIFIED: LENGTHS, HOLE TO EDGE OR EDGE TO EDGE: $\pm 0.5MM$. BETWEEN ANY TWO HOLES IN SAME PLANE: $\pm 0.25MM$. ANGLES: $\pm 0.5^\circ$, DIAMETERS $\pm 0.13MM$. TOLERANCE IS NON-ACCUMULATIVE.
3. MATERIALS MUST COMPLY WITH EU DIRECTIVE 2002/95/EC, ROHS COMPLIANT PER EATON SPECIFICATION 164080496.
4. DOCUMENTATION CERTIFYING MATERIALS AND COMPONENTS ARE ROHS COMPLIANT SHALL BE AVAILABLE UPON REQUEST.
5. INSIDE BEND RADIUS: $1.5MM \pm 0.5MM$.
6. METAL STAMP CUSTOMER PART NUMBER AND REVISION USING 3MM HIGH CHARACTERS, LOCATION APPROXIMATELY AS SHOWN.
7. FINISH: BLACK POWDER PER EATON SPECIFICATION 164700509-001. EDGES SHALL BE FREE OF BURRS.
8. OK FOR MANUFACTURING TRANSFER FROM PRO-E 3D FILE.

| | | | | | | |
|------------------------|-------------------|--|--|--------------------------|----------------------------|---------|
| METRIC | | THIRD ANGLE PROJECTION | EATON CORPORATION, ELECTRICAL | | EATON | SIZE: D |
| DESCRIPTION: EAR | | | | | | |
| MODIFIED BY: J. Yan | DATE: 15-May-2010 | UNLESS OTHERWISE SPECIFIED TOLERANCES ARE: | | | SCALE: 1:000 | |
| ECD: ECD-140067 | STATE: Release | ANGLES: $\pm 1/2^\circ$ | DECIMALS: 0.X: ± 0.75 | X: (FOR X < 31): ± 1 | DO NOT SCALE | |
| | | HOLES: $\phi \pm 0.13$ | DIMENSIONS ARE IN MILLIMETERS (INCHES) AND AFTER PLATING | | DRAWING OR CHANGE MANUALLY | |
| PRO-ENGINEER GENERATED | | | PART NAME: P-157002204 | REVISION: 44 | SHEET: 5 of 5 | |

EATON CORPORATION - CONFIDENTIAL AND PROPRIETARY NOTICE TO PERSONS RECEIVING THIS DOCUMENT AND/OR TECHNICAL INFORMATION THIS DOCUMENT, INCLUDING THE DRAWING AND INFORMATION CONTAINED THEREON, IS THE EXCLUSIVE PROPERTY OF EATON CORPORATION, AND IS LOANED TO YOU AND SUBJECT TO RECALL BY EATON AT ANY TIME. BY TAKING POSSESSION OF THIS DOCUMENT, THE RECIPIENT ACKNOWLEDGES AND AGREES THAT THIS DOCUMENT CANNOT BE USED IN ANY MANNER ADVERSE TO THE INTERESTS OF EATON, AND THAT NO PORTION OF THIS DOCUMENT MAY BE COPIED OR OTHERWISE REPRODUCED WITHOUT THE PRIOR WRITTEN CONSENT OF EATON. IN THE CASE OF CONFLICTING CONTRACTUAL PROVISIONS, THIS NOTICE SHALL GOVERN THE STATUS OF THIS DOCUMENT. © 2008 Eaton Corporation. All Rights Reserved.